

PERMIT # 30432

Operation Permit

- New Installation
- Septic Tank
- Nitrification Line
- Repair
- Expansion

PROPERTY LOCATION: 521425 Oakdale RD

Name: (owner) LGI Homes SUBDIVISION Avery Pond LOT # 174

System Installer: Quality Septic Co Registration # _____

Basement with plumbing: Garage Number of Bedrooms 3

Type of Water Supply: Community Public Well Distance from well _____ feet

System Type: 25% Reducta Septa Type BC Check Types V and VI Systems expire in 5 years.

(In accordance with Table V a) Owner must contact Health Department 6 months prior to expiration for permit renewal.

away

This system has been installed in compliance with applicable North Carolina General Statutes, Rules for Sewage Treatment and Disposal, and all conditions of the Improvement Permit and Construction Authorization.

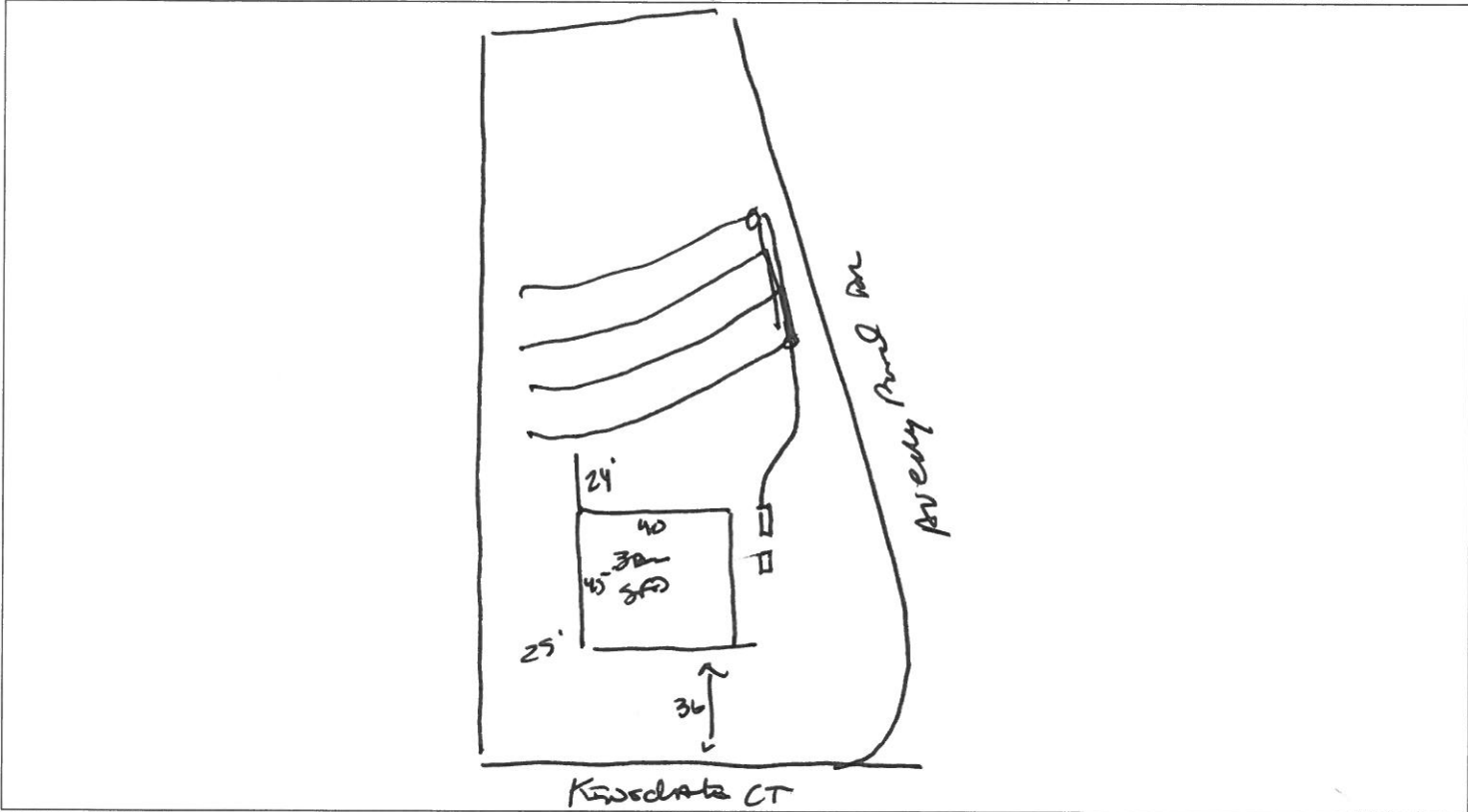

PERMIT CONDITIONS:

- I. Performance: System shall perform in accordance with Rule .1961.
- II. Monitoring: As required by Rule .1961.
- III. Maintenance: As required by Rule .1961. Other: _____
Subsurface system operator required? Yes No
If yes, see attached sheet for additional operation conditions, maintenance and reporting.
- IV. Operation: _____
- V. Other: _____

D-Box Pump Alarm H2O Line PWR Line

Following are the specifications for the sewage disposal system on the above captioned property.

Type of system: Conventional Other 25% REDUCTA Septic Tank: 1000 gallons Pump Tank: 1000 gallons

Subsurface Drainage Field: No. of ditches 4 exact length of each ditch 60 feet width of ditches 3 feet depth of ditches _____ inches

French Drain Required: _____ Linear feet

Authorized State Agent James E. Manlove Date 7.22.19