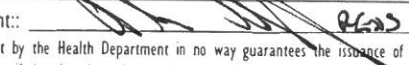

Harnett County Department of Public Health Improvement Permit

A building permit cannot be issued with only an Improvement Permit

ISSUED TO: Pride Homes PROPERTY LOCATION: 145 Blue Chip Ct
 SUBDIVISION Market Place LOT # 99
 NEW REPAIR EXPANSION Site Improvements required prior to Construction Authorization Issuance:
 Type of Structure: SFD (65'x60')
 Proposed Wastewater System Type: 25% Reduction System
 Projected Daily Flow: 360 GPD
 Number of bedrooms: 3 Number of Occupants: 6 max
 Basement Yes No May be required based on final location and elevations of facilities
 Pump Required: Yes No
 Type of Water Supply: Community Public Well Distance from well _____ feet Permit valid for: Five years
 Permit conditions: _____ No expiration

Authorized State Agent:  Date: 3/28/2019 SEE ATTACHED SITE SKETCH
 The issuance of this permit by the Health Department in no way guarantees the issuance of other permits. The permit holder is responsible for checking with appropriate governing bodies in meeting their requirements. This site is subject to revocation if the site plan, plat, or the intended use changes. The Improvement Permit shall not be affected by a change in ownership of the site. This permit is subject to compliance with the provisions of the Laws and Rules for Sewage Treatment and Disposal and to conditions of this permit.

Construction Authorization

(Required for Building Permit)

The construction and installation requirements of Rules .1950, .1952, .1954, .1955, .1956, .1957, .1958, and .1959 are incorporated by references into this permit and shall be met. Systems shall be installed in accordance with the attached system layout.

ISSUED TO: Pride Homes PROPERTY LOCATION: 145 Blue Chip Ct
 SUBDIVISION Market Place LOT # 99
 Facility Type: SFD (65'x60') New Expansion Repair
 Basement? Yes No Basement Fixtures? Yes No
 Type of Wastewater System** 25% Reduction System (Initial) Wastewater Flow: 360 GPD
 (See note below, if applicable) 25% Reduction System (Repair)

Installation Requirements/Conditions
 Septic Tank Size 1000 gallons
 Pump Tank Size _____ gallons
 Number of trenches 1
 Exact length of each trench 150 feet
 Trenches shall be installed on contour at a
 Maximum Trench Depth of: 18-24 inches
 (Trench bottoms shall be level to +/-1/4"
 in all directions)
 Trench Spacing: 9 Feet on Center
 Soil Cover: 6-12 inches
 (Maximum soil cover shall not exceed
 36" above the trench bottom)
 Pump Requirements: _____ ft. TDH vs. _____ GPM _____ inches below pipe
 Aggregate Depth: _____ inches above pipe
 _____ inches total
 Conditions: _____

**WATER LINES (INCLUDING IRRIGATION) MUST BE 10FT. FROM ANY PART OF SEPTIC SYSTEM OR REPAIR AREA.
NO UTILITIES ALLOWED IN INITIAL OR REPAIR DRAIN FIELD AREA.**

**If applicable: I understand the system type specified is different from the type specified on the application. I accept the specifications of this permit.
 Owner/Legal Representative Signature: _____ Date: _____

This Construction Authorization is subject to revocation if the site plan, plat, or the intended use changes. The Construction Authorization shall not be transferred when there is a change in ownership of the site. This Construction Authorization is subject to compliance with the provisions of the Laws and Rules for Sewage Treatment and Disposal and to the conditions of this permit. SEE ATTACHED SITE SKETCH

Authorized State Agent:  Date: 3/28/2019
 Construction Authorization Expiration Date: 3/28/2024

HTE# SF D1903-00162

Permit # _____

Harnett County Department of Public Health Site Sketch

ISSUED TO: PRIDE HOMES

PROPERTY LOCATOR: 145 BLUE CHIP CT

SUBDIVISION MARKET PLACE

LOT # 99

Authorized State Agent: ~~REISS (OLIVER TOLKSON)~~

Date: 3/28/19

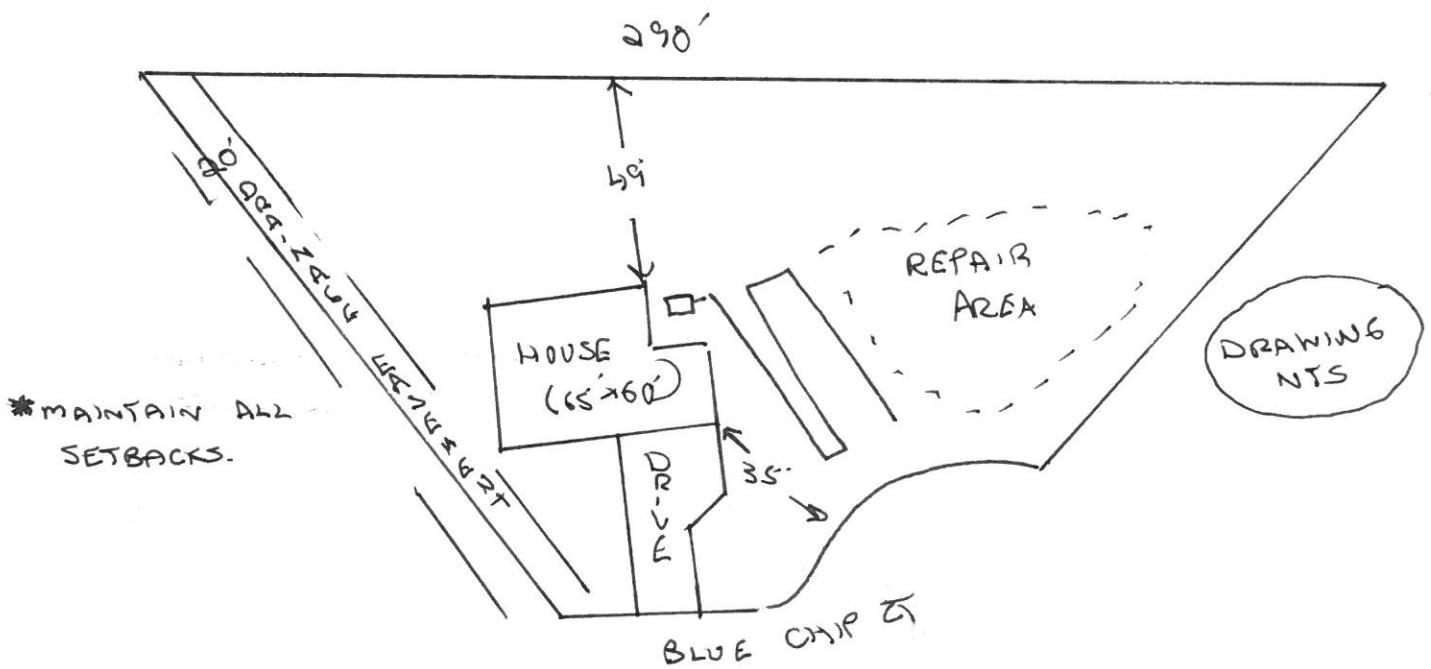

HTE# SF D1903-00162

Permit # _____

Harnett County Department of Public Health Site Sketch

ISSUED TO: PRIDE HOMES PROPERTY LOCATOR: 145 BLUE CHIP CT
SUBDIVISION: MARSH PLACE LOT # 99

Authorized State Agent: KENN (OLYVIC TOLKOFF) Date: 3/28/19

