

HTE #: BRES2105-0016

HARNETT COUNTY HEALTH DEPARTMENT
ENVIRONMENTAL HEALTH
307 CORNELIUS HARNETT BOULEVARD
LILLINGTON, NC 27546

EXISTING SEPTIC SYSTEM INSPECTION

Name: MICHAEL & CHRISTINE ROBINSON

Phone #: 610.246.9021

Address: 66 TRALEE CT FUQUAY-VARINA, NC 27526

Name of Mobile Home Park or S/D: AVERY POND - LOT 186

Name of Owner (if different): SAME

Address of Owner (if different): SAME

Property Location (State Road name and #): 66 TRALEE CT. (CHALYBEATE RD. - SR 1429)

Purpose of Inspection: 12'x30' DECK - REPAIR RELOCATION SUBMITTED VIA ADAMS SOIL CONSULTING - LSS #1247

The aforementioned site has been evaluated by the Harnett County Health Department Environmental Health Section. At the time of inspection, there appeared to be a septic system serving this site. If the system should malfunction, the owner is responsible for any necessary repairs.

THIS INSPECTION IS VOID IF:

1. the intended use of the septic system should change, and/or
2. the system should fail or malfunction, and/or
3. the owner or tenant of the property change, and/or
4. after six months

**BUILDING MUST BE 5' FROM ANY PART OF SEPTIC SYSTEM
DO NOT DRIVE OR PARK ON SEPTIC SYSTEM**

AUTHORIZATION OF EXISTING SYSTEM



Signature of Environmental Health Specialist

11/08/2021

Date

**Adams Soil Consulting
1676 Mitchell Road
Angier, NC 27501
919-414-6761**

August 1, 2021
Project #1291

RE: 66 Tralee Ct. – Fuquay -Varina, NC (Harnett County)

To whom it may concern:

Adams Soil Consulting (ASC) conducted a preliminary soil evaluation on the above referenced parcel to determine the areas of soils which are suitable for subsurface wastewater disposal systems (conventional & LPP). The soil/site evaluation was performed using hand auger borings during moist soil conditions based on the criteria found in the State Subsurface Rules, 15ANCAC 18A .1900 “Laws and Rules for Sewage Treatment and Disposal Systems”.

The purpose of this investigation was to determine an alternative septic system repair area than what was designated on the original “Operation Permit” issued by Harnett County Health Dept. A deck was built onto the home and inadvertently impacted the designated repair area available should a septic system repair be needed in the future.

It is my determination that there is still adequate available to space for a 100% repair area on the property. However, the repair would need to utilized a T&J panel system for a 50% reduction system. Additionally, the repair lines would need to be dosed utilizing a separate/new pump tank.

At the time of evaluation, the existing system appeared to be functioning as designed and there was no evidence of a current or past septic failure. The existing system appears to be in compliance with regard to setbacks with the existing deck.

If you have any questions regarding the findings on the attached map or in this report, please feel free to contact me anytime. Thank you allowing me to perform this site evaluation for you.

Sincerely,



Alex Adams
NC Licensed Soil Scientist #1247



Avery Pond 3-Bedroom Septic Proposal 66 Tralee Ct. Potential Repair Proposal

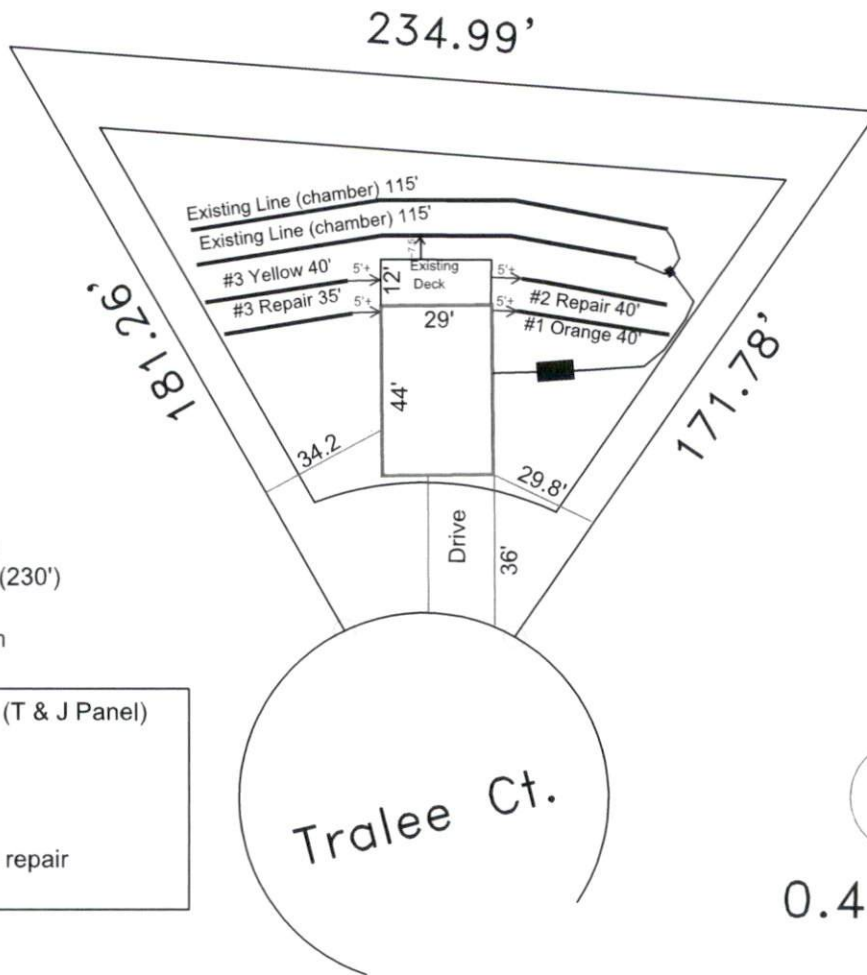

System: Gravity D-Box
 Lines: Existing 2- lines (230')
 0.4 LTAR
 Accepted Status System

Repair: 50% Reduction (T & J Panel)
 Lines: 1-4 (155')
 0.4 LTAR
 2- Pressure Manifolds
 24" Trench Bottom
 ~3,000 sq. ft available for repair

186

0.477 AC.

GRAPHIC SCALE
 1" = 50'



Adams
 Soil Consulting
 919-414-6761
 Job #1291

HTE# SD1902-0057

Harnett County Department of Public Health

25557

PERMIT # NA

Operation Permit

New Installation Septic Tank Nitrification Line Repair Expansion

PROPERTY LOCATION: 66 Tallee Ct. (Chulhyacke D. 51423)

Name: (owner) LGI Home NC LLC SUBDIVISION Avery Pond LOT # 186

System Installer: Quality Septic Registration # _____

Basement with plumbing: Garage Number of Bedrooms 3

Type of Water Supply: Community Public Well Distance from well NA feet

System Type: 25% Reduction Sys. IIIg Types V and VI Systems expire in 5 years.

(In accordance with Table V a)

Owner must contact Health Department 6 months prior to expiration for permit renewal.

This system has been installed in compliance with applicable North Carolina General Statutes, Rules for Sewage Treatment and Disposal, and all conditions of the Improvement Permit and Construction Authorization.

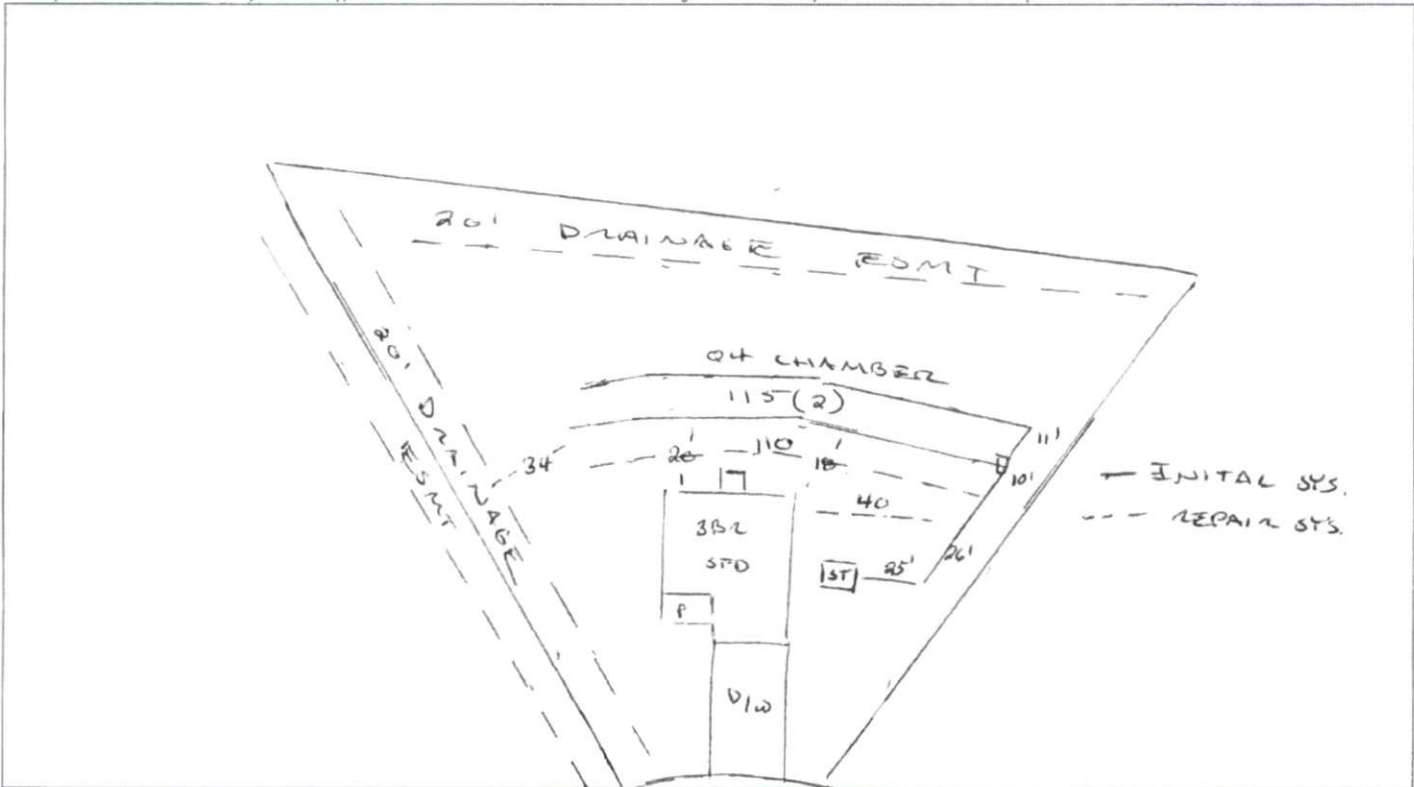

PERMIT CONDITIONS:

- I. Performance: System shall perform in accordance with Rule .1961.
- II. Monitoring: As required by Rule .1961.
- III. Maintenance: As required by Rule .1961. Other: _____
Subsurface system operator required? Yes No
If yes, see attached sheet for additional operation conditions, maintenance and reporting.
- IV. Operation: _____
- V. Other: _____

D-Box Pump Alarm H2O Line PWR Line

Following are the specifications for the sewage disposal system on the above captioned property.

Type of system: Conventional Other Out Chamber IIIg Septic Tank: 1000 gallons Pump Tank: _____ gallons
 Subsurface No. of exact length width of depth of
 Drainage Field ditches 2 of each ditch 115 feet ditches 3 feet ditches 24 inches
 French Drain Required: _____ Linear feet

Authorized State Agent [Signature] Date 06/04/2019