

Sheet:  
 Property ID:  
 Lot #:  
 File #:  
 Code:

5FD 1902-0034  
 MASON POINTE

**SOIL/SITE EVALUATION  
 for ON-SITE WASTEWATER SYSTEM**

Owner: <sup>KB</sup> ~~Hous~~ Applicant: Buteaux Civil Summ  
 Address: 437 SFD Date Evaluated: 08/05/2019  
 Proposed Facility: \_\_\_\_\_ Design Flow (.1949): 480 GPD  
 Location of Site: \_\_\_\_\_ Property Recorded: \_\_\_\_\_  
 Water Supply:  Public  Individual  Well  Spring  Other  
 Evaluation Method:  Auger Boring  Pit  Cut  
 Type of Wastewater:  Sewage  Industrial Process  Mixed

Property Size: LOT 34

P R O F I L E #	.1940 Landscape Position/ Slope %	Horizon Depth (In.)	SOIL MORPHOLOGY .1941		OTHER PROFILE FACTORS				Profile Class & LTAR
			.1941 Structure/ Texture	.1941 Consistence Mineralogy	.1942 Soil Wetness/ Color	.1943 Soil Depth (IN.)	.1956 Sapro Class	.1944 Restr Horiz	
1	L 3%	0-16	CL LS	VR MSNP					PS
		16-42	ML SL	FN SP	7.5YR7/1 @ 42"				0.35
2	L 3%	0-16	CL LS	VR MSNP					PS
		16-42	ML SL	FN SP	7.5YR7/1 @ 42"				0.35

Description	Initial System	Repair System	Other Factors (.1946): Site Classification (.1948): Evaluated By: Others Present:
Available Space (.1945)			Provisionally suitable Andrew Curran, NESH
System Type(s)	25% LL	25% LL	
Site LTAR	0.35	0.35	

COMMENTS: \_\_\_\_\_

LANDSCAPE POSITIONS	GROUP	TEXTURES	.1955 LTAR	CONSISTENCE MOIST	WET
R-RIDGE	I	S-SAND	1.2 - 0.8	VFR-VERY FRIABLE FR-FRIABLE	NS-NON-STICKY SS-SLIGHTLY STICKY
S-SHOULDER SLOPE		LS-LOAMY SAND			
L-LINEAR SLOPE	II	SL-SANDY LOAM	0.8 - 0.6	FI-FIRM VFI-VERY FIRM EFI-EXTREMELY FIRM	S-STICKY VS-VERY STICKY NP-NON-PLASTIC
FS-FOOT SLOPE		L-LOAM			
N-NOSE SLOPE	III	SI-SILT	0.6 - 0.3		SP-SLIGHTLY STICKY P-PLASTIC VP-VERY PLASTIC
H-HEAD SLOPE		SIL-SILT LOAM			
CC-CONCLAVE SLOPE		CL-CLAY LOAM			
CV-CONVEX SLOPE		SCL-SANDY CLAY LOAM			
T-TERRACE	IV	SIC-SILTY CLAY	0.4 - 0.1		
FP-FLOOD PLAN		C-CLAY SC-SANDY CLAY			

STRUCTURE  
 SG-SINGLE GRAIN  
 M- MASSIVE  
 CR-CRUMB  
 GR-GRANULAR  
 SBK-SUBANGULAR BLOCKY  
 ABK-ANGULAR BLOCKY  
 PL-PLATY  
 PR-PRISMATIC

MINERALOGY  
 SLIGHTLY EXPANSIVE  
 EXPANSIVE

Show profile locations and other site features (dimensions, references or benchmark, and North)

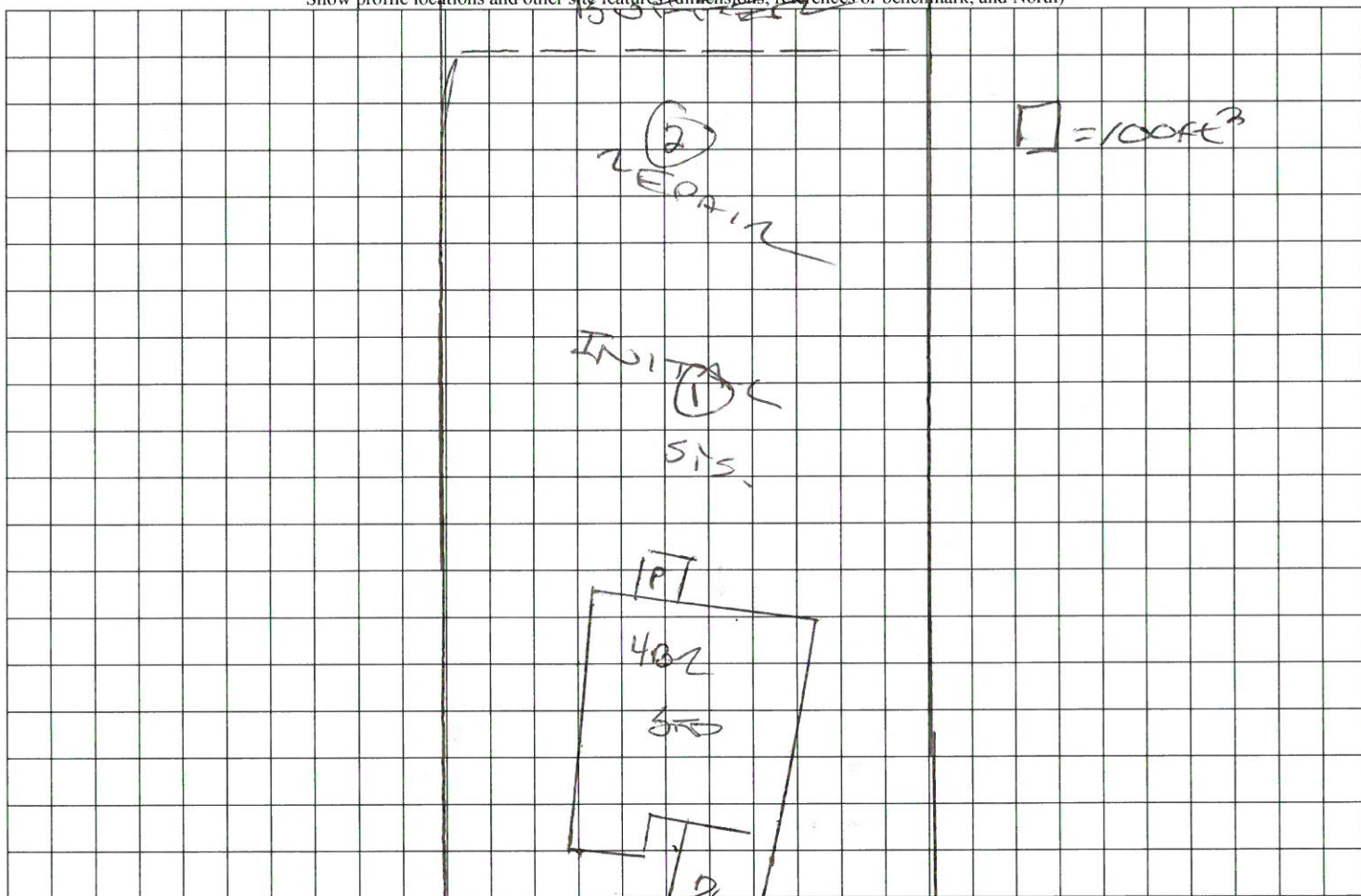

PIPEY FIELD RD