

HTE# SFD1902-0032

# Harnett County Department of Public Health

25720

PERMIT # NA

## Operation Permit

New Installation  Septic Tank  Nitrification Line  Repair  Expansion

PROPERTY LOCATION: 92 Piney Field Rd. (Christa St. Rd.)

Name: (owner) KB Homes SUBDIVISION Mason Pointe LOT # 30

System Installer: Thornton Plumbing Registration # \_\_\_\_\_

Basement with plumbing:  Garage  Number of Bedrooms 4

Type of Water Supply:  Community  Public  Well Distance from well NA feet

System Type: 25% reduction sys. JTB Types V and VI Systems expire in 5 years.

(In accordance with Table V a) Owner must contact Health Department 6 months prior to expiration for permit renewal.

This system has been installed in compliance with applicable North Carolina General Statutes, Rules for Sewage Treatment and Disposal, and all conditions of the Improvement Permit and Construction Authorization.

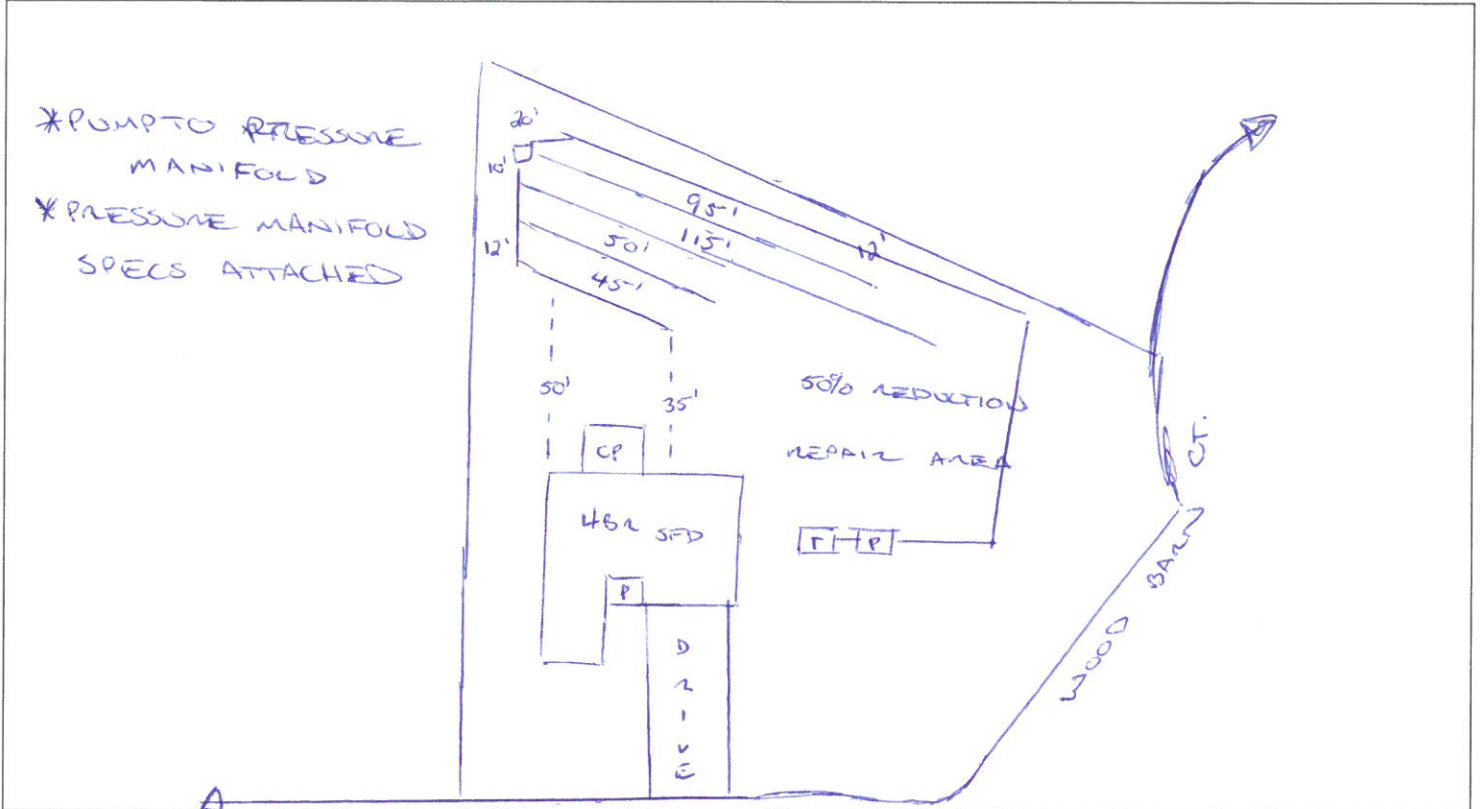

### PERMIT CONDITIONS:

- I. Performance: System shall perform in accordance with Rule .1961.
- II. Monitoring: As required by Rule .1961.
- III. Maintenance: As required by Rule .1961. Other: \_\_\_\_\_  
Subsurface system operator required? Yes  No   
If yes, see attached sheet for additional operation conditions, maintenance and reporting.
- IV. Operation: \_\_\_\_\_
- V. Other: \_\_\_\_\_

D-Box  Pump  Alarm  H2O Line  PWR Line

Following are the specifications for the sewage disposal system on the above captioned property.

Type of system:  Conventional  Other EE FLOW JTB Septic Tank: 1000 gallons Pump Tank: 1000 gallons  
 Subsurface No. of exact length 95, 115, width of depth of  
 Drainage Field ditches 4 of each ditch 50, 45 feet ditches 3 feet ditches 24 inches  
 French Drain Required: \_\_\_\_\_ Linear feet

Authorized State Agent [Signature]

Date 10/18/2019

**Mason Pointe, Lot 30  
TAP CHART**

Bench Mark		is = 100.00 Location of BM				Elevation Head			3.40
Pump tank elev.		100.00	Pump elev.	94.60	Manifold elev.			98.00	
line	color	rod read	Elevation	length	hole size	flow/tap	gal/day	trench area	LINE LTAR
6	Yellow	3.00	97.00	95	3/4in SCH 80	10.1	144.46	285	0.5069
7	Red	3.20	96.80	115	3/4in SCH 40	12.5	178.78	345	0.5182
8	Blue	3.40	96.60	50	1/2in SCH 80	5.48	78.38	150	0.5225
9	Purple	3.50	96.50	45	1/2in SCH 80	5.48	78.38	135	0.5806
<b>total</b>		<b>feet =</b>	<b>305</b>	<b>gal/min =</b>	<b>33.56</b>	<b>LTAR =</b>		<b>0.4000</b>	
						<b>LTAR + %5</b>		<b>0.4200</b>	
<b>% of Dose Vol.</b>	75	<b>Des. Flow</b>		<b>480</b>	<b>(ltar W/ INOV)</b>		0.5333		
<b>Dose Volume</b>	148.69	<b>Pump Run=</b>		14.30	<b>(ltar W/ INOV + 5%)</b>		0.5600		
<b>Dose Pump Time</b>	4.43	<b>Tank Gal/IN</b>		19.65					
<b>Drawdown in Inches</b>	7.57								

**Mason Pointe, Lot 30  
Repair TAP CHART**

Bench Mark		is = 100.00 Location of BM				Elevation Head			2.40
Pump tank elev.		100.00	Pump elev.	94.60	Manifold elev.			97.00	
line	color	rod read	Elevation	length	hole size	flow/tap	gal/day	trench area	LINE LTAR
1	Purple	4.00	96.00	45	1/2in SCH 80	5.48	90.61	135	0.6712
2	Yellow	3.80	96.20	45	1/2in SCH 80	5.48	90.61	135	0.6712
3	Red	3.90	96.10	45	1/2in SCH 80	5.48	90.61	135	0.6712
4	Blue	3.80	96.20	45	1/2in SCH 80	5.48	90.61	135	0.6712
5	Purple	3.80	96.20	65	1/2in SCH 40	7.11	117.56	195	0.6029
<b>total</b>		<b>feet =</b>	<b>245</b>	<b>gal/min =</b>	<b>29.03</b>	<b>LTAR =</b>		<b>0.4000</b>	
						<b>LTAR + %5</b>		<b>0.4200</b>	
<b>% of Dose Vol.</b>	80	<b>Des. Flow</b>		<b>480</b>	<b>(ltar W/ INOV)</b>		0.8000		
<b>Dose Volume</b>	127.40	<b>Pump Run=</b>		16.53	<b>(ltar W/ INOV + 5%)</b>		0.8400		
<b>Dose Pump Time</b>	4.39	<b>Tank Gal/IN</b>		19.65					
<b>Drawdown in Inches</b>	6.48								