

Crosslink Subdivision
Lot #60
4-Bedroom Septic System Design

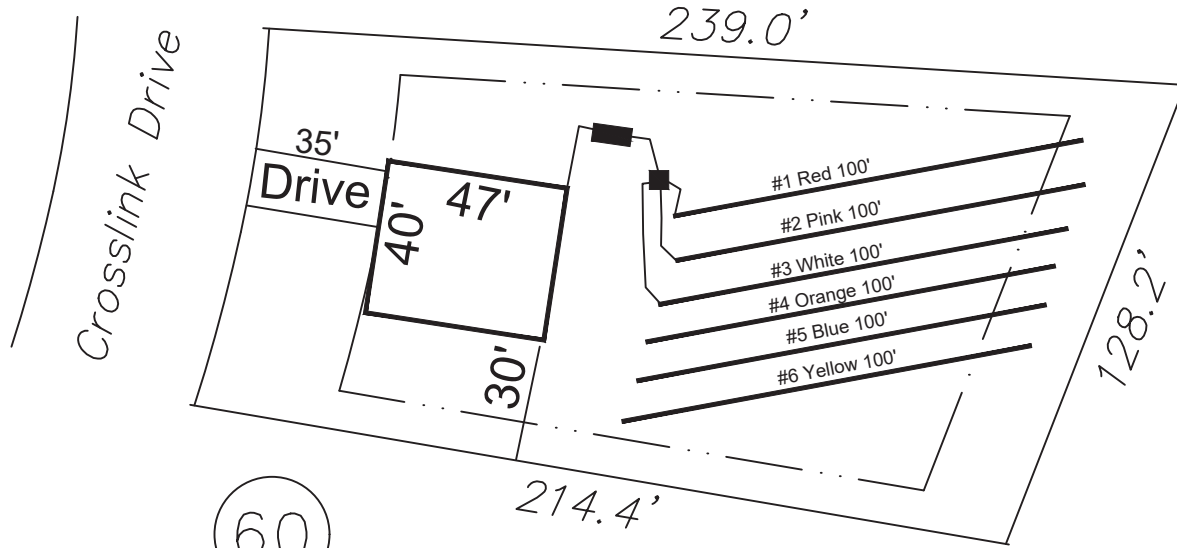

60

0.576 Ac.

System: Gravity to D-Box
Lines: 1-3, (300')
0.4 LTAR
24" Trench Bottom
Accepted Status System
Repair: Gravity to D-Box
Lines: 4-6, (300')
0.4 LTAR
24" Trench Bottom
Accepted Status System

GRAPHIC SCALE
1" = 50'



Adams
Soil Consulting
919-414-6761
Job #522