

Go Thad Smith

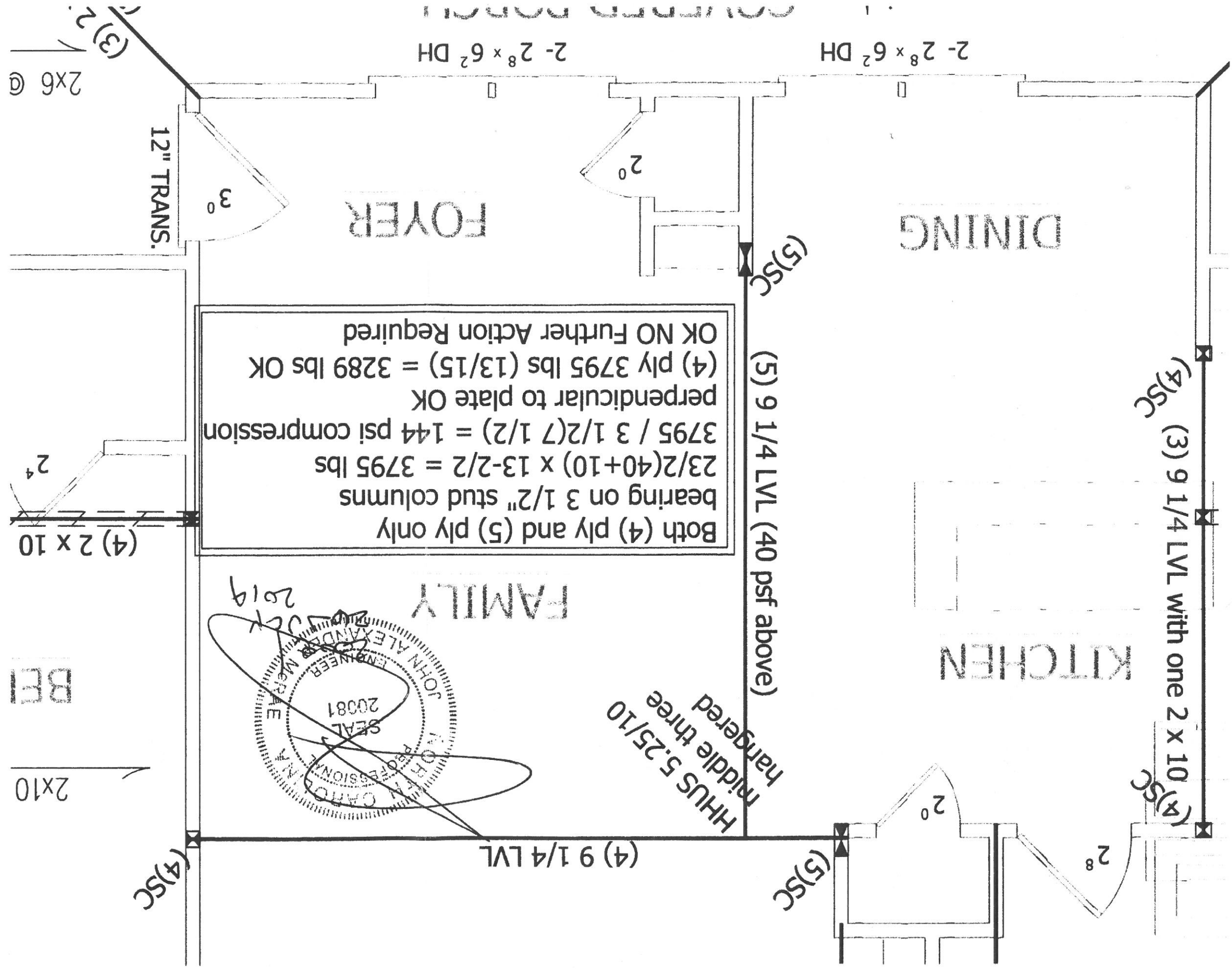

Both (4) ply and (5) ply only
 bearing on 3 1/2" stud columns
 $23/2(40+10) \times 13-2/2 = 3795 \text{ lbs}$
 $3795 / 3 \ 1/2(7 \ 1/2) = 144 \text{ psi compression}$
 perpendicular to plate OK
 (4) ply 3795 lbs (13/15) = 3289 lbs OK
 OK NO Further Action Required

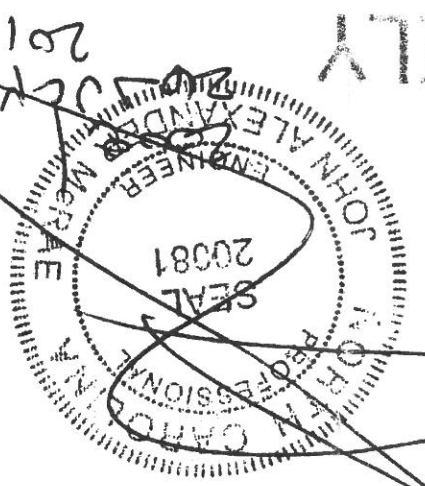

HHUS 5.25/10
 hangered
 middle three