

HTE# 581812-0046

# Harnett County Department of Public Health

30338

## Improvement Permit

A building permit cannot be issued with only an Improvement Permit

SR 1513

ISSUED TO: Watermark Homes, Inc.

PROPERTY LOCATION: 137 Treasure Dr. (Neills Creek Rd.)

NEW  REPAIR  EXPANSION

SUBDIVISION South Creek LOT # 13

Site Improvements required prior to Construction Authorization Issuance: \_\_\_\_\_

Type of Structure: 4BR 60'x60' SFD

Proposed Wastewater System Type: 25% Reduction

Projected Daily Flow: 480 GPD

Number of bedrooms: 4 Number of Occupants: 8 max

Basement  Yes  No

Pump Required:  Yes  No  May be required based on final location and elevations of facilities

Type of Water Supply:  Community  Public  Well Distance from well NA feet

Permit valid for:  Five years  No expiration

Permit conditions: \_\_\_\_\_

Authorized State Agent: [Signature]

Date: 01/17/2019

SEE ATTACHED SITE SKETCH

The issuance of this permit by the Health Department in no way guarantees the issuance of other permits. The permit holder is responsible for checking with appropriate governing bodies in meeting their requirements. This site is subject to revocation if the site plan, plat, or the intended use changes. The Improvement Permit shall not be affected by a change in ownership of the site. This permit is subject to compliance with the provisions of the Laws and Rules for Sewage Treatment and Disposal and to conditions of this permit.

## Construction Authorization

(Required for Building Permit)

The construction and installation requirements of Rules .1950, .1952, .1954, .1955, .1956, .1957, .1958, and .1959 are incorporated by references into this permit and shall be met. Systems shall be installed in accordance with the attached system layout.

ISSUED TO: Watermark Homes, Inc.

PROPERTY LOCATION: 137 Treasure Dr. (Neills Creek Rd.)

SR 1513

Facility Type: 4BR 60'x60' SFD  New  Expansion  Repair

SUBDIVISION South Creek LOT # 13

Basement?  Yes  No Basement Fixtures?  Yes  No

Type of Wastewater System\*\* 25% Reduction Sys. (Initial) Wastewater Flow: 480 GPD

(See note below, if applicable )

Pump to 50% PPBPS Sys. (Repair)

### Installation Requirements/Conditions

Septic Tank Size 1000 gallons

Number of trenches 1

Pump Tank Size \_\_\_\_\_ gallons

Exact length of each trench 300 feet

Trench Spacing: 9 Feet on Center

Trenches shall be installed on contour at a

Soil Cover: 12 inches

Maximum Trench Depth of: 24 inches

(Maximum soil cover shall not exceed

(Trench bottoms shall be level to +1-1/4"

36" above the trench bottom)

in all directions)

Pump Requirements: \_\_\_\_\_ ft. TDH vs. \_\_\_\_\_ GPM

Aggregate Depth: NA inches below pipe

NA inches above pipe

Conditions: \_\_\_\_\_

NA inches total

**WATER LINES (INCLUDING IRRIGATION) MUST BE 10FT. FROM ANY PART OF SEPTIC SYSTEM OR REPAIR AREA.**

**NO UTILITIES ALLOWED IN INITIAL OR REPAIR DRAIN FIELD AREA.**

**\*\*If applicable:** I understand the system type specified is different from the type specified on the application. I accept the specifications of this permit.

Owner/Legal Representative Signature: \_\_\_\_\_

Date: \_\_\_\_\_

This Construction Authorization is subject to revocation if the site plan, plat, or the intended use changes. The Construction Authorization shall not be transferred when there is a change in ownership of the site. This

Construction Authorization is subject to compliance with the provisions of the Laws and Rules for Sewage Treatment and Disposal and to the conditions of this permit.

SEE ATTACHED SITE SKETCH

Authorized State Agent: [Signature]

Date: 01/17/2019

ANDREW CURRAN

Construction Authorization Expiration Date: 01/17/2024

HTE# SFS1812-0046

Permit # 30338

# Harnett County Department of Public Health Site Sketch

S21513

ISSUED TO: Watermark Homes, Inc. PROPERTY LOCATOR: 137 Treasure Dr (Neills Creek Rd.)  
SUBDIVISION: South Creek LOT # 13

Authorized State Agent: ANDREW CURLOW Date: 01/17/2019

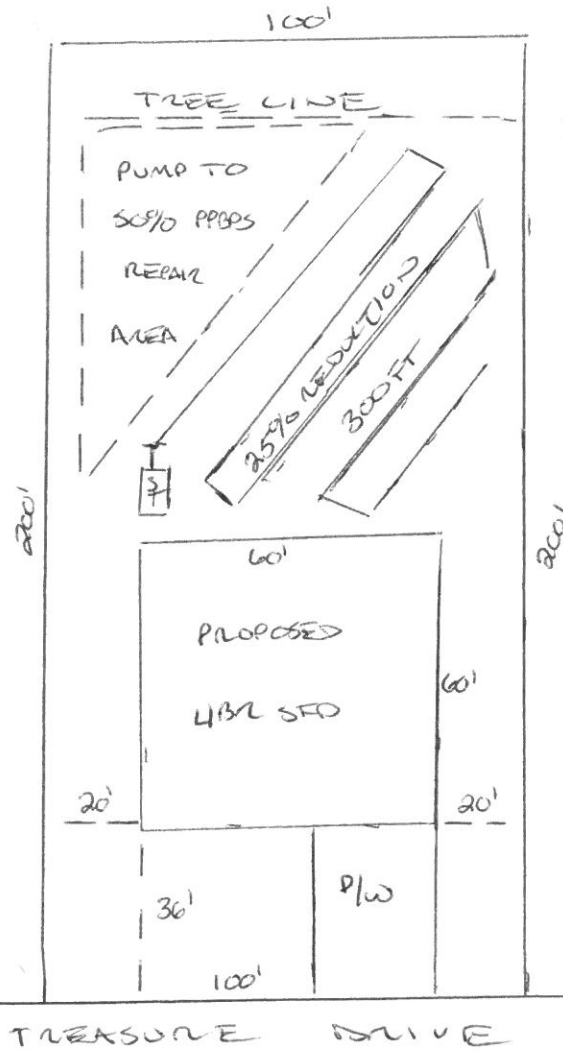

\*PUMP MAY BE  
REQUIRED BASED  
ON FINAL PLUMBING