

**SOIL/SITE EVALUATION  
 for ON-SITE WASTEWATER SYSTEM**

Owner: — Applicant: **Wood Residential Bldg**  
 Address: **3167 Bailey's x rds** Date Evaluated: **01/11/14**  
 Proposed Facility: **362 SFD** Design Flow (.1949): **360 GPD**  
 Location of Site: **362 SFD** Property Recorded:  
 Water Supply:  Public  Individual  Well  
 Evaluation Method:  Auger Boring  Pit  Cut  
 Type of Wastewater:  Sewage  Industrial Process  Mixed

Property Size: **Ennis Minor Lot 1**

P R O F I L E #	.1940 Landscape Position/ Slope %	Horizon Depth (In.)	SOIL MORPHOLOGY .1941		OTHER PROFILE FACTORS				Profile Class & LTAR
			.1941 Structure/ Texture	.1941 Consistence Mineralogy	.1942 Soil Wetness/ Color	.1943 Soil Depth (IN.)	.1956 Sapro Class	.1944 Restr Horiz	
1,2	L 3-4%	0-20	CL LS	VLV NSNP					
		20-42	CL SLL	FN SSSP					P5
		42+	Parent mat	—		42			G.4
3	L 3-4%	0-24	CL LS	VLV NSNP					
		24-46	CL SLL	FN SSSP					P5
		46+	Parent mat	—		46			G.4
4	L 3-4%	0-32	CL LS	VLV NSNP					P5
		32-48	CL SLL	FN SSSP		48			G.4

Description	Initial System	Repair System	Other Factors (.1946):
Available Space (.1945)	<input checked="" type="checkbox"/>	<input checked="" type="checkbox"/>	Site Classification (.1948): <b>Provisionally suitable</b>
System Type(s)	<b>25% m &amp; d</b>	<b>25% m &amp; d</b>	Evaluated By: <b>Andrew Curran, NEHS</b>
Site LTAR	<b>G.4</b>	<b>G.4</b>	Others Present:

COMMENTS: \_\_\_\_\_

LANDSCAPE POSITIONS	GROUP	TEXTURES	.1955 LTAR	CONSISTENCE MOIST	WET
R-RIDGE	I	S-SAND	1.2 - 0.8	VFR-VERY FRIABLE FR-FRIABLE	NS-NON-STICKY SS-SLIGHTLY STICKY
S-SHOULDER SLOPE		LS-LOAMY SAND			
L-LINEAR SLOPE	II	SL-SANDY LOAM	0.8 - 0.6	FI-FIRM VFI-VERY FIRM	S-STICKY VS-VERY STICKY
FS-FOOT SLOPE		L-LOAM			
N-NOSE SLOPE	III	SI-SILT	0.6 - 0.3	EFI-EXTREMELY FIRM	NP-NON-PLASTIC SP-SLIGHTLY STICKY
H-HEAD SLOPE		SIL-SILT LOAM			
CC-CONCLAVE SLOPE		CL-CLAY LOAM			
CV-CONVEX SLOPE		SCL-SANDY CLAY LOAM			
T-TERRACE	IV	SIC-SILTY CLAY	0.4 - 0.1		P-PLASTIC VP-VERY PLASTIC
FP-FLOOD PLAN		C-CLAY			
		SC-SANDY CLAY			

- STRUCTURE  
 SG-SINGLE GRAIN  
 M-MASSIVE  
 CR-CRUMB  
 GR-GRANULAR  
 SBK-SUBANGULAR BLOCKY  
 ABK-ANGULAR BLOCKY  
 PL-PLATY  
 PR-PRISMATIC

- MINERALOGY  
 SLIGHTLY EXPANSIVE  
 EXPANSIVE

Show profile locations and other site features (dimensions, references or benchmark, and North)

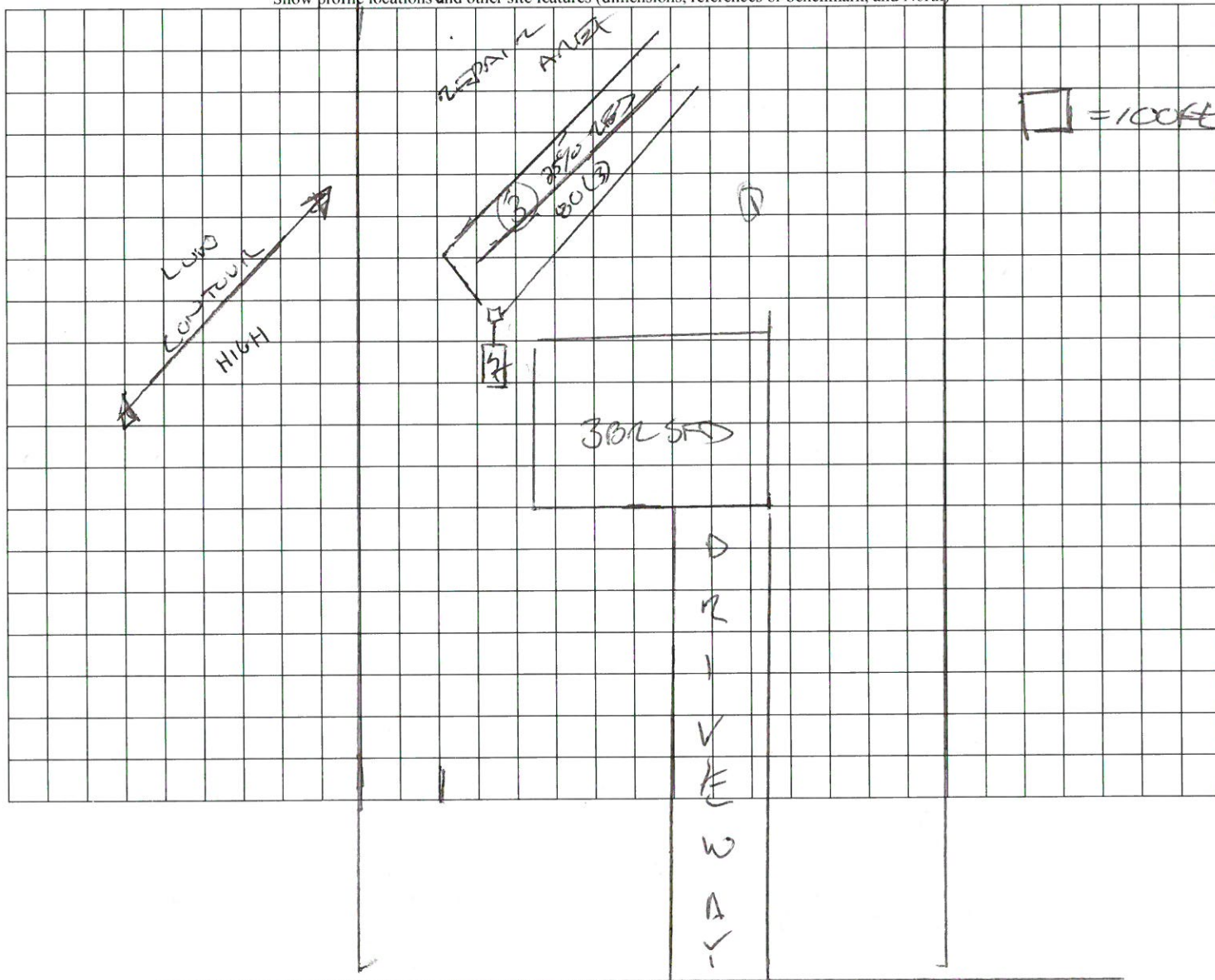

BAILEY'S CROSS ROAD