



ECS Southeast, LLP

6151 Raeford Road
Suite A
Fayetteville, NC 28304
(910) 401-3288 [Phone]
(910) 323-0539 [Fax]

LETTER OF TRANSMITTAL

February 11, 2019

Josh Sturtz Homes
531 Shawcroft Rd
Fayetteville, NC 28311

ATTN: Mr. Josh Sturtz

RE: **McDougald Lot**

ECS Job # **33:4635-B**

Permits:
Location: **3204 McDougald Rd**
Lillington, NC

We are enclosing: Field Reports For your use As requested

ENCL:

Field Report # 1 02/05/2019

Dennis D. Lowery, P.E.
Project Engineer

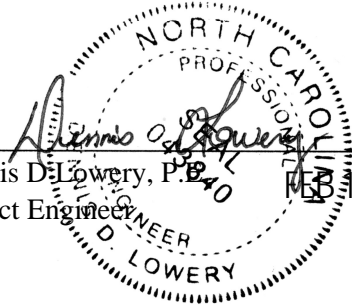

Donny Johnson
Field Services Manager

Disclaimer

1. This report (and any attachments) shall not be reproduced except in full without prior written approval of ECS.
2. The information in this report relates only to the activities performed on the report date.
3. Where appropriate, this report includes statements as to compliance with applicable project drawings and specifications for the activities performed on this report date.
4. Incomplete or non-conforming work will be recorded for future resolution.
5. The results of samples and/or specimens obtained or prepared for subsequent laboratory testing will be presented in separate reports/documents.



Report of Spread Footing - Foundation Observations

Project: McDougald Lot

Project No. 4635-B

Location: 3204 McDougald Rd
Lillington - Harnett - NC - 27546

Day/Date: 02/05/2019

Contractor: None Listed

Footing Number	Location	Size (W x H x L)		Footing Bottom Elevation		Description of Steel Placed	Description of Subgrade Material	Required Blow Counts	Design Bearing Pressure
		Design	Actual	Design	Depth of Undercut (in)			# of Blows / increment	
1	foundation of home	x x	x x	2000	0		orange clay sand	6	2000
								3,4,5	
1	foundation of home	x x	x x	2000	-1		orange clay sand	6	2000
								6,12,14	
1	foundation of home	x x	x x	2000	-2		grey sand	6	2000
								13,14,12	
1	foundation of home	x x	x x	2000	-3		grey sand	6	2000
								11,10,13	
2	foundation of home	x x	x x	2000	0		orange clay sand	6	2000
								5,7,7	
2	foundation of home	x x	x x	2000	-1		orange clay sand	6	2000
								8,12,12	
2	foundation of home	x x	x x	2000	-2		orange clay sand	6	2000
								18,12,11	
2	foundation of home	x x	x x	2000	-3		orange clay sand	6	2000
								12,13,11	
3	foundation of home	x x	x x	2000	0		orange clay sand	6	2000
								3,4,4	

By: Gage Thomas Griffin

ECS Southeast, LLP



Report of Spread Footing - Foundation Observations

Project: McDougald Lot

Project No. 4635-B

Location: 3204 McDougald Rd
Lillington - Harnett - NC - 27546

Day/Date: 02/05/2019

Contractor: None Listed

Footing Number	Location	Size (W x H x L)		Footing Bottom Elevation		Description of Subgrade Material	Required Blow Counts	Design Bearing Pressure
		Design	Actual	Design	Depth of Undercut (in)		# of Blows / increment	
3	foundation of home	x x	x x	2000	-1	orange clay sand	6	2000
							8,8,11	
3	foundation of home	x x	x x	2000	-2	grey sand	6	2000
							12,15,16	
3	foundation of home	x x	x x	2000	-3	grey sand	6	2000
							14,16,12	
4	foundation of home	x x	x x	2000	0	orange clay sand	6	2000
							4,4,5	
4	foundation of home	x x	x x	2000	-1	grey sand	6	2000
							11,13,16	
4	foundation of home	x x	x x	2000	-2	grey sand	6	2000
							10,12,11	
4	foundation of home	x x	x x	2000	-3	grey sand	6	2000
							12,14,13	

By: Gage Thomas Griffin

ECS Southeast, LLP

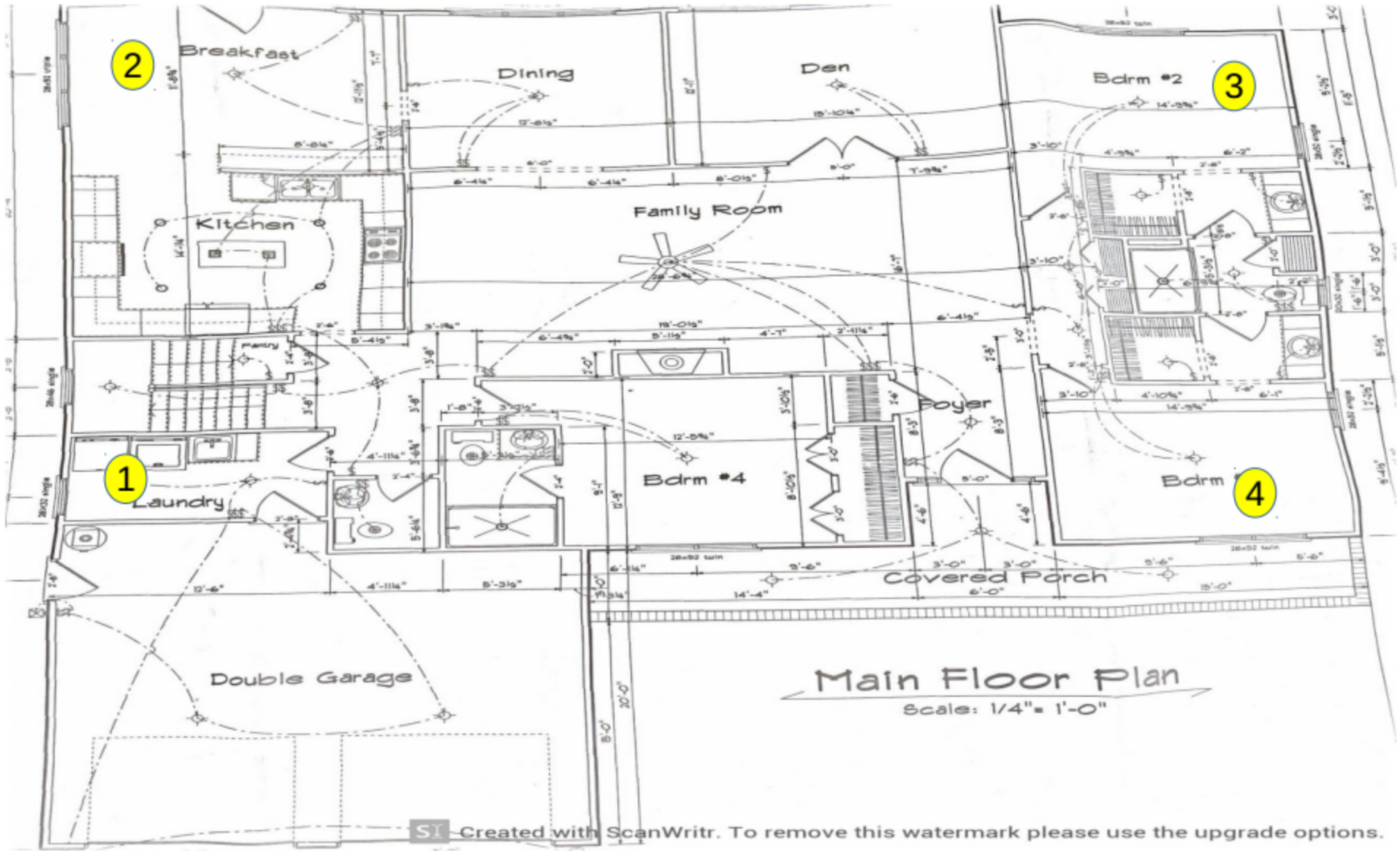

Gage Griffin
 February 5, 2019
 3204 mcdougald rd
 Proj #4635-b
 W/O # 50430

Key
 Bearing Capacity Test #

