

HTE# SFD1812-0009

# Harnett County Department of Public Health

25781

PERMIT # \_\_\_\_\_

## Operation Permit

New Installation  Septic Tank  Nitrification Line  Repair  Expansion

PROPERTY LOCATION: 149 on Rock Ln (Raven Rock Rd) S#1314

Name: (owner) Country Fair Homes SUBDIVISION \_\_\_\_\_ LOT # \_\_\_\_\_

System Installer: Lamy Sharpe Registration # \_\_\_\_\_

Basement with plumbing:  Garage  Number of Bedrooms 3

Type of Water Supply:  Community  Public  Well Distance from well \_\_\_\_\_ feet

System Type: conventional Types V and VI Systems expire in 5 years.

(In accordance with Table V a) Owner must contact Health Department 6 months prior to expiration for permit renewal.

This system has been installed in compliance with applicable North Carolina General Statutes, Rules for Sewage Treatment and Disposal, and all conditions of the Improvement Permit and Construction Authorization.

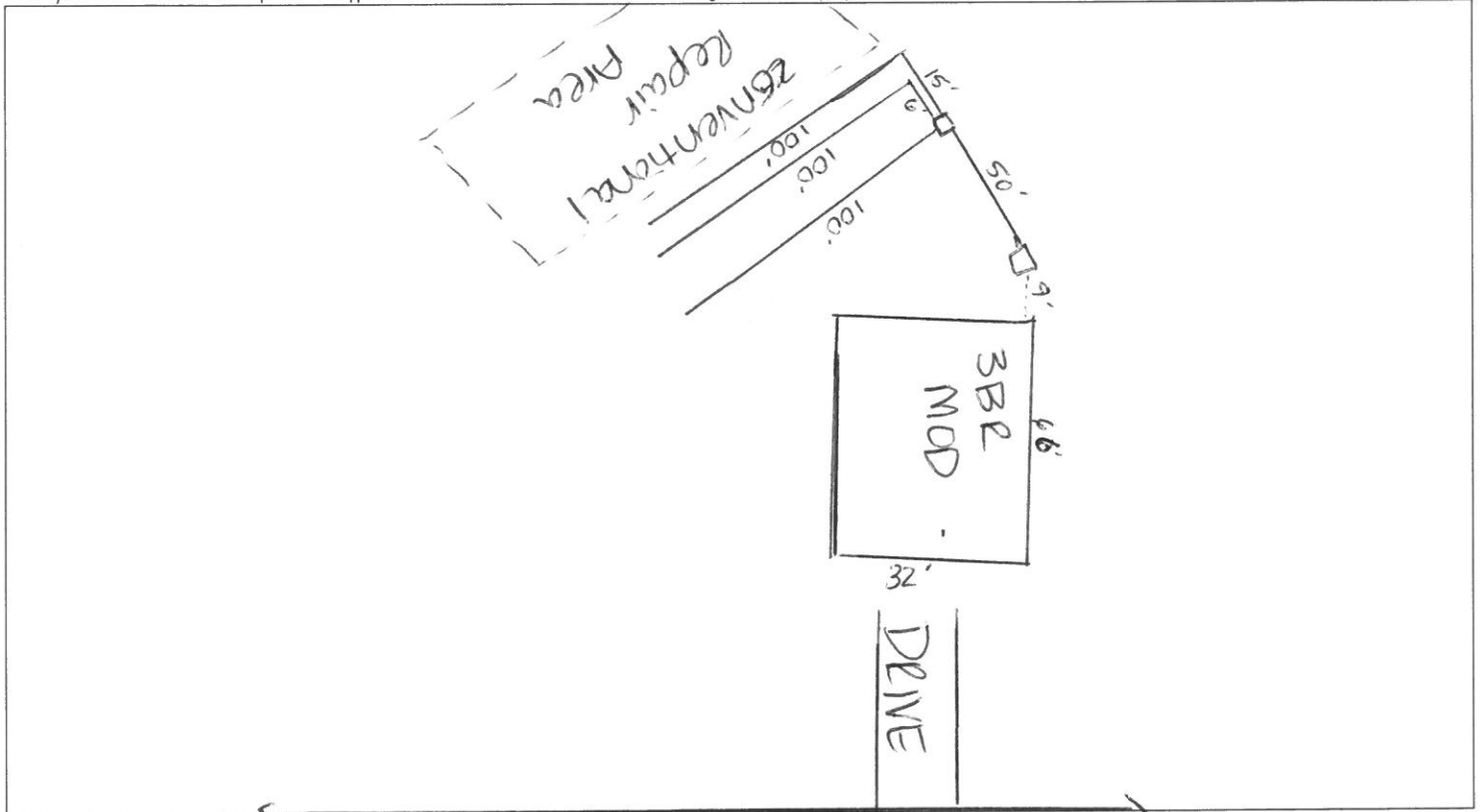

### PERMIT CONDITIONS:

- I. Performance: System shall perform in accordance with Rule .1961.
- II. Monitoring: As required by Rule .1961.
- III. Maintenance: As required by Rule .1961. Other: \_\_\_\_\_  
Subsurface system operator required? Yes  No   
If yes, see attached sheet for additional operation conditions, maintenance and reporting.
- IV. Operation: \_\_\_\_\_
- V. Other: \_\_\_\_\_

D-Box  Pump  Alarm  H2O Line  PWR Line

Following are the specifications for the sewage disposal system on the above captioned property.

Type of system:  Conventional  Other \_\_\_\_\_ Septic Tank: 1000 gallons Pump Tank: \_\_\_\_\_ gallons  
 Subsurface Drainage Field: No. of 3 exact length of each ditch 100 feet width of ditches 3 feet depth of ditches 24 inches  
 French Drain Required: \_\_\_\_\_ Linear feet

Authorized State Agent Beth Adkins REHS I Date 11/5/19

Central Carolina Holdings

Ticket: 1769818

Date: 10/21/2019

Time: 10:51:22 - 11:14:36

Customer: 0369650001 / Larry Sharpes

Scale  
Gross: 43040 LBS Out Manual Wt  
Tare: 22680 LBS In Manual Wt  
Net: 20360 LBS

Generator: NA / Not Applicable

Dest: DEST: CUSTOMER / Customer

Truck: LARRY SHAR

Comment:

Origin	Wastes & Services	Quantity Unit	Rate/Unit	Amount
NA / Not Applicable	DFMT116/Drain Fill Material	10.18 TON	\$25.00/TN	\$254.50
			Total Taxes:	\$17.82
			Total Amount:	\$272.32

Driver: \_\_\_\_\_

Deputy Weighmaster: \_\_\_\_\_

Libby Cameron

**This load of tire chips is from the Fuel Grade location and meets the Nc specification as stated in Innovative Wastewater system approval IWWS-2002-03R for tire chip Substitution for Rock Aggregate in Nitrification Fields.**