

Products					
PlotID	Length	Product	Plies	Net Qty	
J-37	37' 10"	11-7/8" BCI@ 4500s-1.8	1	11	
J-14	14' 1 3/4"	11-7/8" BCI@ 4500s-1.8	1	3	
J-14	14' 0 1/4"	11-7/8" BCI@ 4500s-1.8	1	12	
J-14-2	14' 0 1/4"	11-7/8" BCI@ 4500s-1.8	2	2	
J-7	7' 9 1/4"	11-7/8" BCI@ 4500s-1.8	1	1	
RIM1	12' 0"	1" x 11-7/8" BC RIM BOARD OSB	1	13	
BK1	2' 0"	11-7/8" BCI@ 4500s-1.8	1	3	

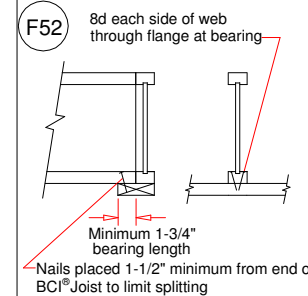

This layout and associated materials list has been prepared based on project plans and/or information provided to Builders FirstSource (BFS). It remains the responsibility of the builder, architect, designer, or other responsible persons to review this information to assure that it is appropriate, accurate, complete and complies with applicable building codes.

- GENERAL NOTES**
- 1.) READ THE INSTALLATION GUIDE BEFORE FRAMING.
 - 2.) ALL WALL SHOWN ARE LOAD BEARING UNLESS NOTES OTHERWISE WALLS NOT SHOWN HAVE BEEN CONSIDERED NON-LOAD BEARING.
 - 3.) UNLESS STATED OTHERWISE ALL CEILING & BEARING WALLS SUPPORTED BY FOUNDATION ROOF LOADS BRACE DIRECTLY TO LOAD BEARING WALLS.
 - 4.) CONTACT YOUR LOCAL BUILDERS FIRSTSOURCE & ADJUSTMENTS. FAILURE MAY RESULT IN COSTLY REPAIRS.

H & H HOMES		WAYFARE - GL	
CRAWL EWP PLACEMENT PLAN	Builders FirstSource, Central Carolina Markets	DATE: 3-26-18	JOB #
DRAWN BY: LEE ATKINS	SCALE: NTS		

MINIMUM DESIGN DATA
LIVE LOAD 40 PSF
DEAD LOAD 10 PSF

TOTAL LOAD 50 PSF
STRESS DURATION = 100%
DEFLECTION CRITERIA
L/480 (MINIMUM)

ARCHITECTURAL PLAN DATE
11-16-17
REVISED ARCH. PLAN DATE
XX-XX-XX

SEALED PLAN DATE
12-27-17