

Products				
PlotID	Length	Product	Plies	Net Qty
BM3	20-0-0	1-3/4"x 9-1/4" LVL Kerto-S	2	2

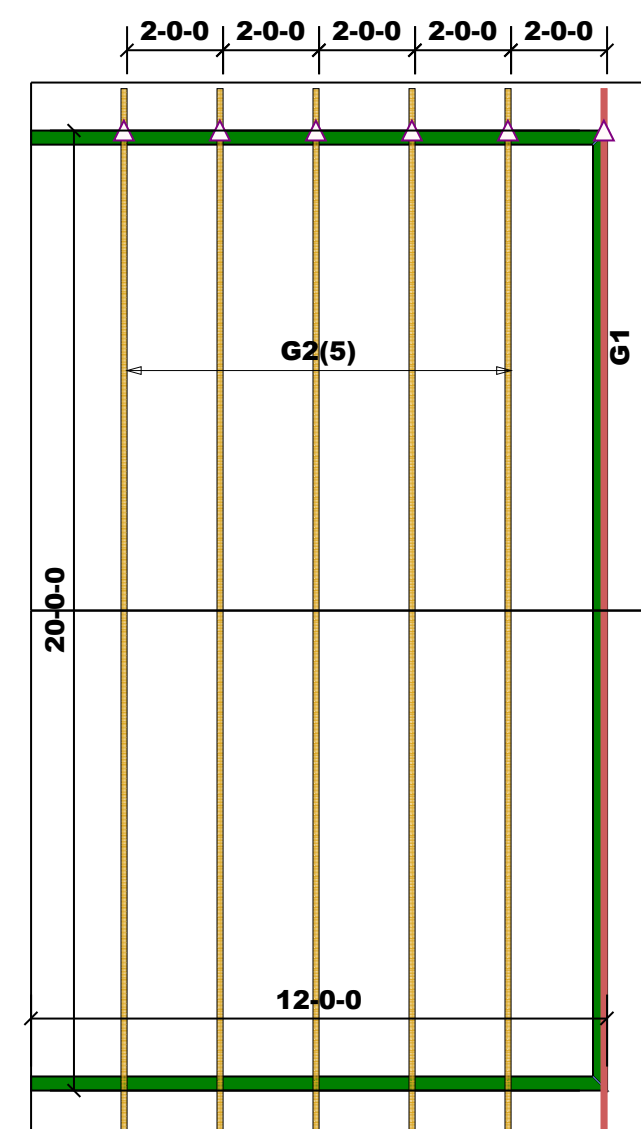

Products				
PlotID	Length	Product	Plies	Net Qty
FJ1	27-8-13	14" WI 40	1	14
FJ2	27-8-13	14" WI 40	2	2
FJ3	15-8-6	14" WI 40	1	1
FJ4	12-8-0	14" WI 40	1	3
FJ5	8-4-8	14" WI 40	1	9
FJ6	7-3-9	14" WI 40	1	2
FJ7	5-10-8	14" WI 40	1	2
FJ8	3-10-8	14" WI 40	1	1
FJ9	3-7-2	14" WI 40	1	1
DB1	7-0-0	1-3/4"x 9-1/4" LVL Kerto-S	2	2
DB2	17-0-0	1-3/4"x 14" LVL Kerto-S	3	3
RIM1	12-0-0	1 1/8" x 14" Rim Board	1	10
BK1	2-0-0	14" WI 40	1	7

Truss Placement Plan  
SCALE: NTS

▲ = Indicates Left End of Truss  
(Reference Engineered Truss Drawing)  
Do NOT Erect Truss Backwards

LOAD CHART FOR JACK STUDS

(BASED ON TABLES B502.5(1) & (2))  
NUMBER OF JACK STUDS REQUIRED @ EA END OF HEADERS/BEAMS

END REACTION (UP TO) 5000#	END REACTION (UP TO) 10000#	END REACTION (UP TO) 15000#	END REACTION (UP TO) 20000#
1700	2550	3400	
3400	5100	6800	
5100	7650	10200	
6800	10200	13600	
8500	12750	17000	
10200	15300		
11900			
13600			
15300			

<b>BUILDER</b>	H&H Homes	<b>COUNTY</b>	County
<b>JOB NAME</b>	Engage C	<b>ADDRESS</b>	Site Address
<b>PLAN</b>	Engage C	<b>MODEL</b>	Roof
<b>SEAL DATE</b>	12/22/17	<b>DATE REV.</b>	/ /
<b>QUOTE #</b>	B0318-1144	<b>DRAWN BY</b>	Marshall Naylor
<b>JOB #</b>	Order #	<b>SALESMAN</b>	Marshall Naylor

**THIS IS A TRUSS PLACEMENT DIAGRAM ONLY.**  
These trusses are designed as individual building components to be incorporated into the building design at the specification of the building designer. See individual design sheets for each truss design identified on the placement drawing. The building designer is responsible for temporary and permanent bracing of the roof and floor system and for the overall structure. The design of the truss support structure including headers, beams, walls, and columns is the responsibility of the building designer. For general guidance regarding bracing, consult BCSI-B1 and BCSI-B3 provided with the truss delivery package or online @ sbcindustry.com

Bearing reactions less than or equal to 3000# are deemed to comply with the prescriptive Code requirements. The contractor shall refer to the attached Tables (derived from the prescriptive Code requirements) to determine the minimum foundation size and number of wood studs required to support reactions greater than 3000# but not greater than 15000#. A registered design professional shall be retained to design the support system for any reaction that exceeds those specified in the attached Tables. A registered design professional shall be retained to design the support system for all reactions that exceed 15000#.

Signature: Marshall Naylor



**ROOF & FLOOR TRUSSES & BEAMS**

Reilly Road Industrial Park  
Fayetteville, N.C. 28309  
Phone: (910) 864-8787  
Fax: (910) 864-4444