

A complete Javelin® framing plan requires the Framer's Pocket Guide
See the Framer's Pocket Guide for Product Trademark Information

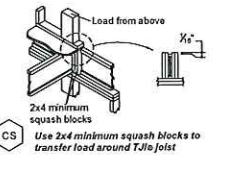
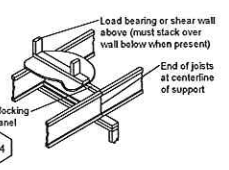
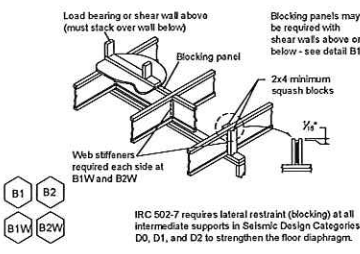
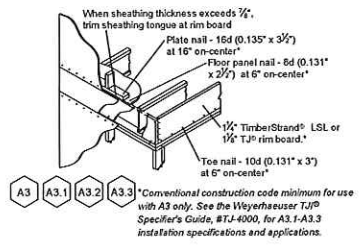

WARNING

Joists are unstable until braced laterally

Bracing Includes:

- Blocking
- Hangers
- Sheathing
- Rim Board
- Stud Lines
- Rim Joist



DO NOT walk on joists until braced. INJURY MAY RESULT.



DO NOT walk on joists that are lying flat.



DO NOT stack building materials on unbraced joists. Stack only over beams or walls.

WARNING NOTES:

Lack of proper bracing during construction can result in serious accidents. Observe the following guidelines:

1. All blocking, hangers, rim boards and rim joists at the end supports of the T/J joists must be completely installed and properly nailed.
2. Lateral strength. The braced end wall or an existing deck, must be established at the ends of the bay. This can also be accomplished by a temporary or permanent deck (sheathing) fastened to the first 4 feet of joists at the end of the bay.
3. Safety bracing of 1x4 (minimum) must be nailed to a braced end wall or sheathed area (as in note 2) and to each joist. Without this bracing, buckling sideways or rollover is highly probable under light construction loads - such as a worker or one layer of unbraced sheathing.
4. Sheathing must be completely attached to each T/J joist before additional loads can be placed on the system.
5. Ends of cantilevers require safety bracing on both the top and bottom flanges.
6. The flanges must remain slightly within 1/2" from true alignment.

Weyerhaeuser, Javelin, Microlam®, Parallel®, Silent Floor®, TimberStand®, T/J®, and Trus Joist® are registered trademarks of Weyerhaeuser NR. © 2012 Weyerhaeuser NR Company. All rights reserved.

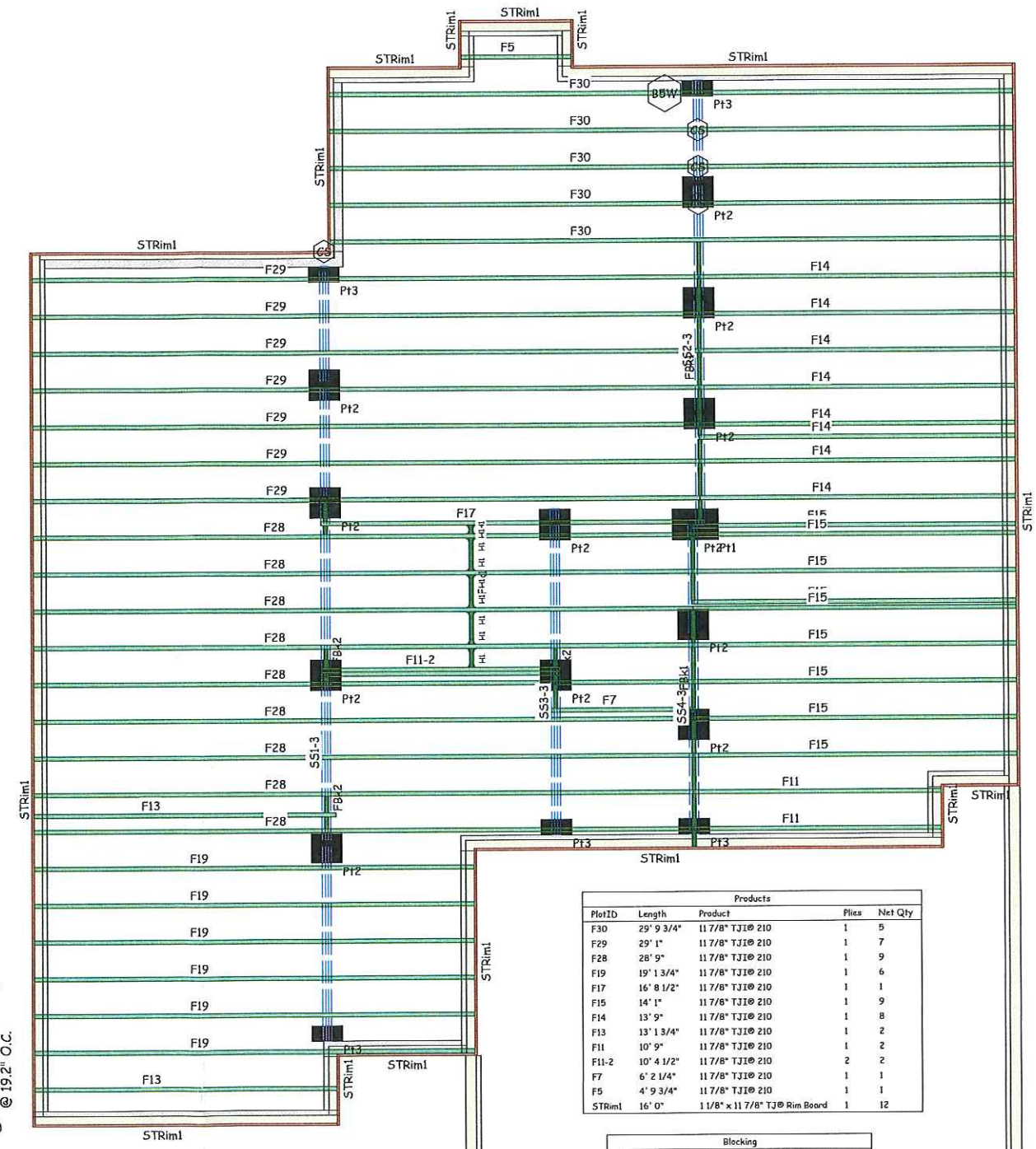

11.7/8" III 210
@ 19.2" O.C.

Framing Connector Summary

PlotID	Qty	Manuf	Product	Design Method	Supporting MH	Filler	Supported MH
HI	15 †	Simpson	IUS2.06/11.88	Designed	IJOIST	No	11 7/8" TJI® 210

† User modified item

Products

PlotID	Length	Product	Pieces	Net Qty
F30	29' 9 3/4"	11 7/8" TJI® 210	1	5
F29	29' 1"	11 7/8" TJI® 210	1	7
F28	28' 9"	11 7/8" TJI® 210	1	9
F19	19' 1 3/4"	11 7/8" TJI® 210	1	6
F17	16' 8 1/2"	11 7/8" TJI® 210	1	1
F15	14' 1"	11 7/8" TJI® 210	1	9
F14	13' 9"	11 7/8" TJI® 210	1	8
F13	13' 1 3/4"	11 7/8" TJI® 210	1	2
F11	10' 9"	11 7/8" TJI® 210	1	2
F11-2	10' 4 1/2"	11 7/8" TJI® 210	2	2
F7	6' 2 1/4"	11 7/8" TJI® 210	1	1
F5	4' 9 3/4"	11 7/8" TJI® 210	1	1
STRim1	16' 0"	1 1/8" x 11 7/8" TJI® Rim Board	1	12

Blocking

PlotID	Length	Product	Pieces	Net Qty
FBk1	2' 0"	11 7/8" TJI® 210	1	17
FBk2	2' 0"	11 7/8" TJI® 210	1	1
FBk1	1' 0"	11 7/8" TJI® 210	1	6
FBk2	1' 0"	11 7/8" TJI® 210	1	8



Drawn By:
Checked By:
Release Date:
Revision Date:

These placement plans have been developed for the specification of products based on project information provided. This service is solely intended for product application assurance and is not intended to circumvent the need for a design professional as determined by the building code. The designer of record and/or builder/framer is responsible to assure these drawings are compatible with the overall project.

Address/Lot:
City, State:
Job #:
Scale: 1/4" = 1'

Customer: H and H Homes
Job Name: Regan Plan
Plan/Model #:
Subdivision:

Sheet:
1 of 2

A complete Javelin® framing plan requires the Framers' Pocket Guide
See the Framers' Pocket Guide for Product Trademark Information

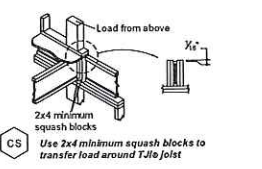
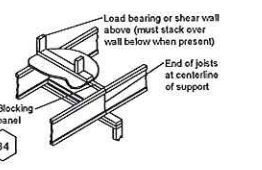
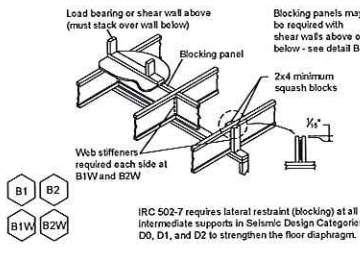
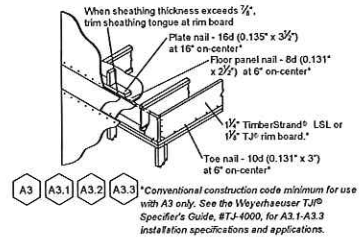

Products				
PlotID	Length	Product	Plies	Net Qty
F43	42' 7 1/2"	14" TJI® 110	1	3
F30	29' 11 1/4"	14" TJI® 110	1	5
F24	23' 7"	14" TJI® 110	1	3
F20	20' 1 3/4"	14" TJI® 110	1	5
F20A	20' 1 1/4"	14" TJI® 110	1	1
F19	19' 1 3/4"	14" TJI® 110	1	11
F19A	18' 11 1/2"	14" TJI® 110	1	6
F17	16' 3 3/4"	14" TJI® 110	1	2
F14	13' 11"	14" TJI® 110	1	2
F13	13' 1 3/4"	14" TJI® 110	1	2
F12	12' 7 1/4"	14" TJI® 110	1	5
F12A	12' 4 3/4"	14" TJI® 110	1	1
F7	6' 2 1/2"	14" TJI® 110	1	1
F4	3' 1/2"	14" TJI® 110	1	1
F3	14"	14" TJI® 110	1	2
MI-2	13/4" x 14"	1.9E Microllam® LVL	2	2
M2-2	13/4" x 14"	1.9E Microllam® LVL	2	2
M3-2	13/4" x 14"	1.9E Microllam® LVL	2	2
M4-2	13/4" x 14"	1.9E Microllam® LVL	2	2
STRim1	1 1/8" x 14" TJI® Rim Board		1	11

WARNING
Joists are unstable until braced laterally

Bracing Includes:

- Blocking
- Sheathing
- Shut Lines
- Hangers
- Rim Board
- Rim Joist

DO NOT walk on joists until braced. INJURY MAY RESULT.

DO NOT walk on joists that are lying flat.

DO NOT stack building materials on unbraced joists or stack joists over beams or walls.

WARNING NOTES:
Lack of proper bracing during construction can result in serious accidents. Observe the following guidelines:

- All blocking, hangers, rim boards and rim joists at the end supports of the TJI joists must be completely installed and properly nailed.
- Lateral strength, like braced end wall or an existing deck, must be established at the ends of the bay. This can also be accomplished by a temporary or permanent deck (sheathing) fastened to the first 4 feet of joists at the end of the bay.
- Safety bracing of 1x4 (minimum) must be nailed to a braced end wall or sheathed area (as in note 2) and to each joint. Without this bracing, buckling sideways or rollover is highly probable under light construction loads - such as a worker or one layer of unnailed sheathing.
- Sheathing must be completely attached to each TJI joist before additional loads can be placed on the system.
- Ends of cantilevers require safety bracing on both the top and bottom flanges.
- The flanges must remain straight within 1/2" from true alignment.

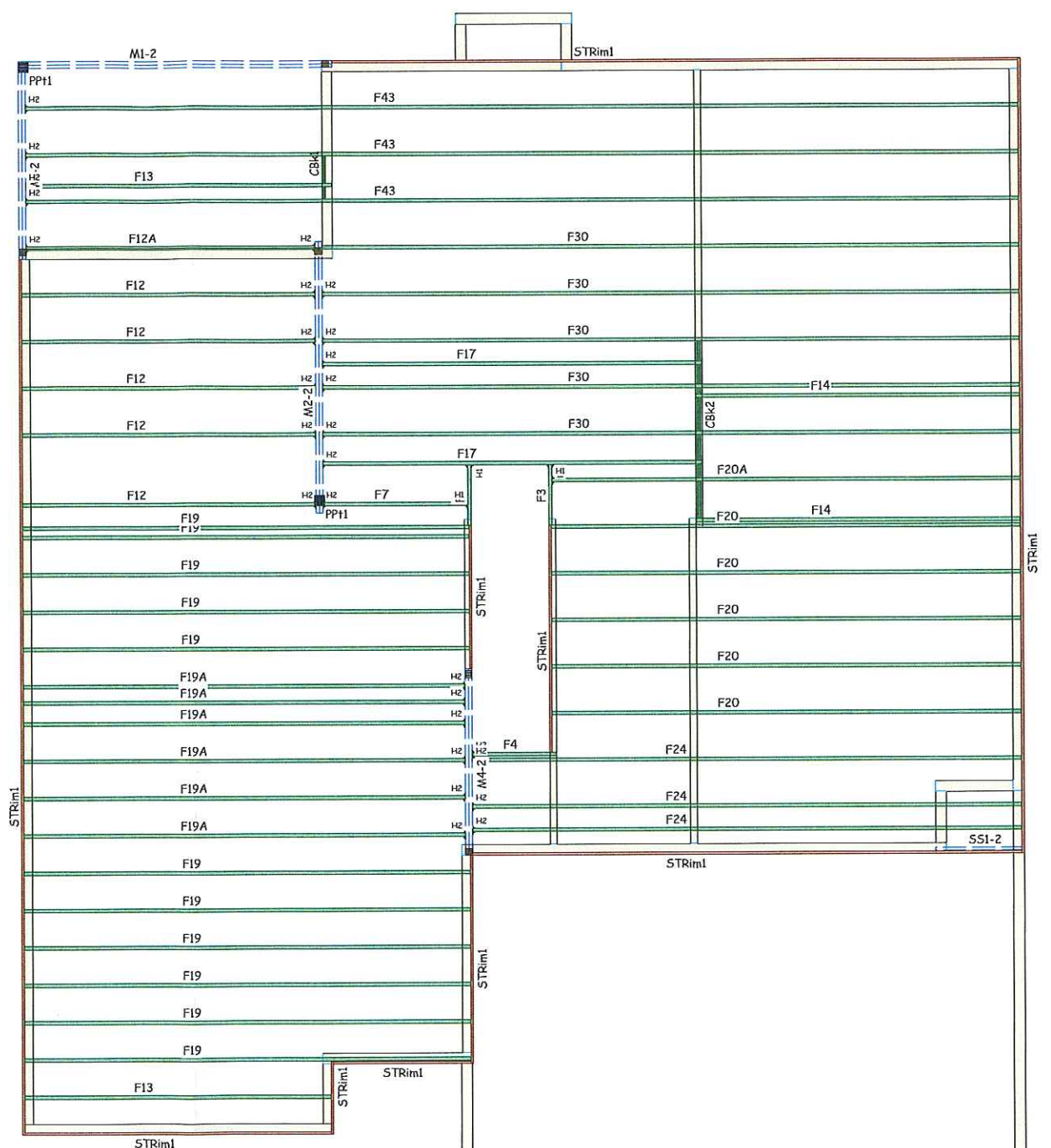

Blocking				
PlotID	Length	Product	Plies	Net Qty
CBk1	2' 0"	14" TJI® 110	1	1
CBk2	2' 0"	14" TJI® 110	1	3
CBk1	1' 0"	14" TJI® 110	1	1
CBk2	1' 0"	14" TJI® 110	1	4

Framing Connector Summary						
PlotID	Qty	Manuf	Product	Design Method	Supporting Mtl	Supported Mtl
H1	4	Simpson	TUS1.B/14	Designed	IJOIST	No 14" TJI® 110
H2	28	Simpson	TUS1.B/14	Designed	LVL	No 14" TJI® 110

JAVELIN
a service by WEYERHAEUSER

Drawn By: _____
Checked By: _____
Release Date: _____
Revision Date: _____

These placement plans have been developed for the specification of products based on project information provided. This service is solely intended for product application assurance, and, is not intended to circumvent the need for a design professional as determined by the building code. The designer of record and/or builder/framer is responsible to assure these drawings are compatible with the overall project.

Address/Lot: _____
City, State: _____
Job #: _____
Scale: 1/4" = 1'

Customer: H and H Hemes
Job Name: Regan Plan
Plan/Model #: _____
Subdivision: _____

Sheet:
2 of 2

Weyerhaeuser, iLevel®, Microllam®, ParaForm®, Stent Floor®, TimberStrand®, TJI®, TJI® and Trus Joists® are registered trademarks of Weyerhaeuser NR. © 2012 Weyerhaeuser NR Company. All rights reserved.

A complete Javelin® framing plan requires the Framers Pocket Guide
See the Framers Pocket Guide for Product Trademark Information

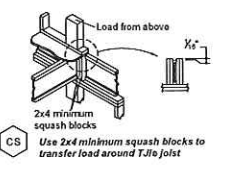
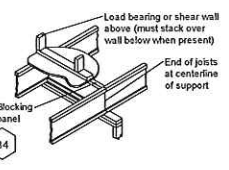
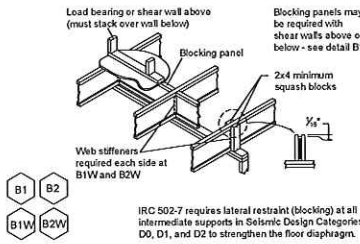
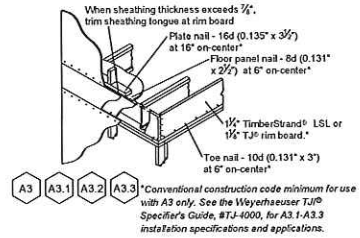

WARNING

Joists are unstable until braced laterally

Bracing Includes:

- Blocking
- Hangers
- Sheathing
- Rim Board
- Strut Lines
- Rim Joist



DO NOT walk on joists until braced. INJURY MAY RESULT.



DO NOT walk on joists that are lying flat.



DO NOT stack building materials on unsheathed joists. Stack only over beams or walls.

WARNING NOTES:

Lack of proper bracing during construction can result in serious accidents. Observe the following guidelines:

1. All blocking, hangers, rim boards and rim joists at the end supports of the TJI joists must be completely installed and properly nailed.
2. Lateral strength, like braced end wall or an existing deck, must be established at the ends of the bay. This can also be accomplished by a temporary or permanent deck (sheathing) fastened to the first 4 feet of joists at the end of the bay.
3. Safety bracing of 1x4 (minimum) must be nailed to a braced end wall or sheathed area (as in note 2) and to each joist. Without this bracing, buckling sideways or rollover is highly probable under light construction loads - such as a worker or one layer of unnailed sheathing.
4. Sheathing must be completely attached to each TJI joist before additional loads can be placed on the system.
5. Ends of cantilevers require safety bracing on both the top and bottom flanges.
6. The flanges must remain straight within 1/2" from true alignment.

Weyerhaeuser, iLevel®, Microlam®, Parafam®, Silent Floor®, TimberStrands®, TJI®, TJO® and Trus Joists® are registered trademarks of Weyerhaeuser NR. © 2012 Weyerhaeuser NR Company. All rights reserved.

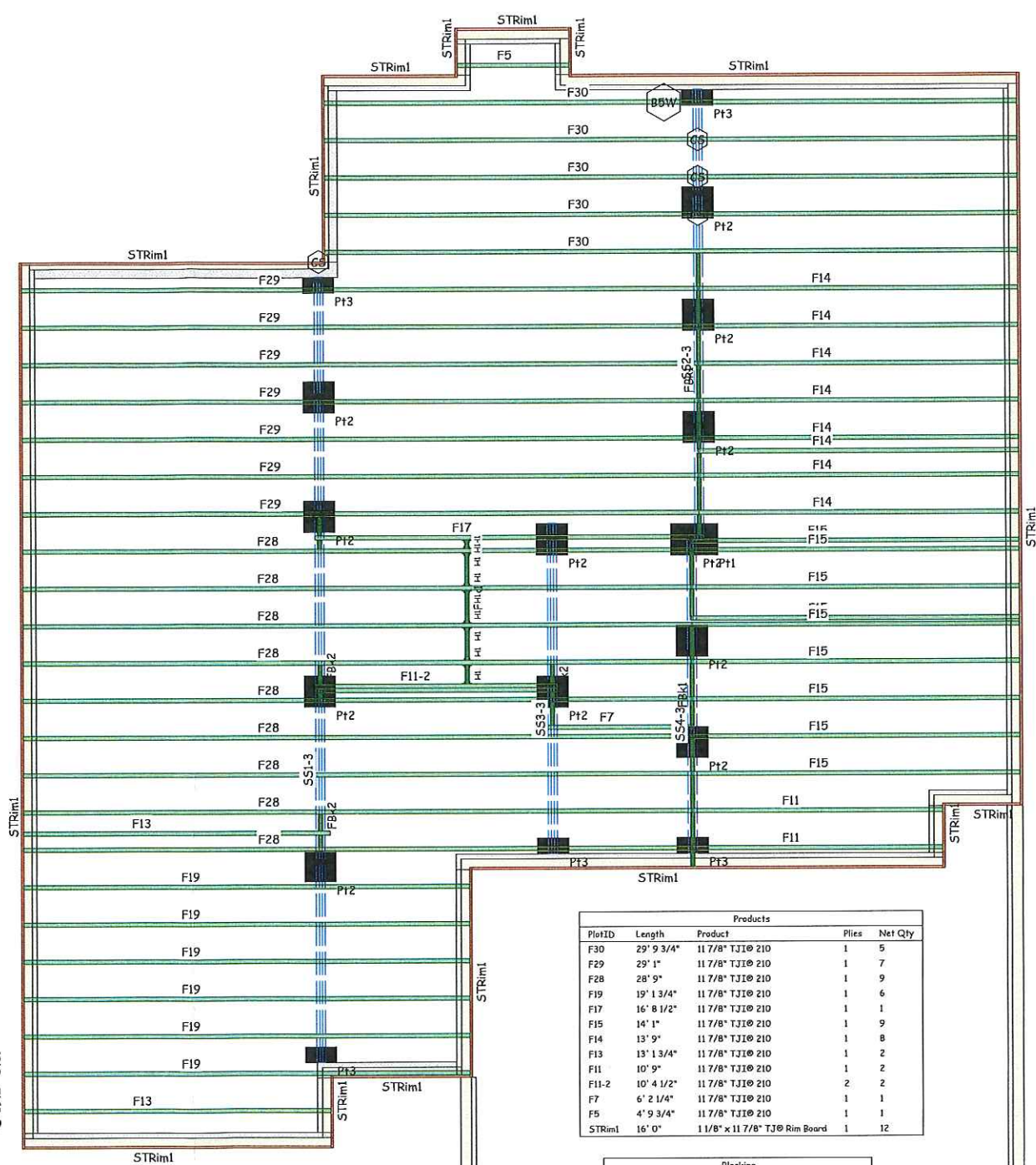

11 7/8" TJI-210 @ 19.2" O.C.

Framing Connector Summary							
PlotID	Qty	Manuf	Product	Design Method	Supporting MH	Filler	Supported MH
HI	15	†	Simpson IUS2.06/11.88	Designed	IJOIST	No	11 7/8" TJI® 210

† User modified item

Products				
PlotID	Length	Product	Plies	Net Qty
F30	29' 9 3/4"	11 7/8" TJI® 210	1	5
F29	29' 1"	11 7/8" TJI® 210	1	7
F28	28' 9"	11 7/8" TJI® 210	1	9
F19	19' 1 3/4"	11 7/8" TJI® 210	1	6
F17	16' 8 1/2"	11 7/8" TJI® 210	1	1
F15	14' 1"	11 7/8" TJI® 210	1	9
F14	13' 9"	11 7/8" TJI® 210	1	8
F13	13' 1 3/4"	11 7/8" TJI® 210	1	2
F11	10' 9"	11 7/8" TJI® 210	1	2
F11-2	10' 4 1/2"	11 7/8" TJI® 210	2	2
F7	6' 2 1/4"	11 7/8" TJI® 210	1	1
F5	4' 9 3/4"	11 7/8" TJI® 210	1	1
STRim1	16' 0"	11 7/8" x 11 7/8" TJI® Rim Board	1	12

Blocking				
PlotID	Length	Product	Plies	Net Qty
FBK1	2' 0"	11 7/8" TJI® 210	1	17
FBK2	2' 0"	11 7/8" TJI® 210	1	1
FBK1	1' 0"	11 7/8" TJI® 210	1	6
FBK2	1' 0"	11 7/8" TJI® 210	1	8

REGISTERED BY WEYERHAEUSER

Drawn By: _____
Checked By: _____
Release Date: _____
Revision Date: _____

These placement plans have been developed for the specification of products based on project information provided. This service is solely intended for product application assurance, and is not intended to circumvent the need for a design professional as determined by the building code. The designer of record and/or builder/framer is responsible to assure these drawings are compatible with the overall project.

Customer: H and H Homes
Job Name: Regan Plan
Plan/Model #: _____
Subdivision: _____

Address/Lot: _____
City, State: _____
Job #: _____
Scale: 1/4" = 1'

Sheet:
1 of 2

A complete Javelin® framing plan requires the Framers' Pocket Guide
See the Framers' Pocket Guide for Product Trademark Information

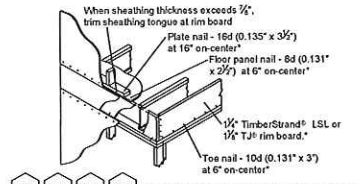

A3, A3.1, A3.2, A3.3 *Conventional construction code minimum for use with A3 only. See the Weyerhaeuser TJI® Specifier's Guide, BT4-1000, for A3.1-A3.3 installation specifications and applications.

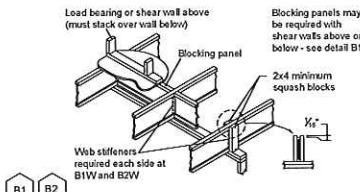

B1, B2, B1W, B2W IRC 502-7 requires lateral restraint (blocking) at all intermediate supports in Seismic Design Categories DD, D1, and D2 to strengthen the floor diaphragm.

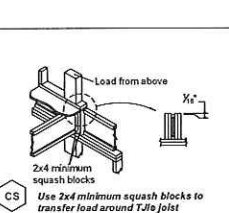
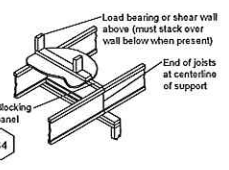

CS

Products				
PlotID	Length	Product	Plies	Net Qty
F43	42' 7 1/2"	14" TJI® 110	1	3
F30	29' 11 1/4"	14" TJI® 110	1	5
F24	23' 7"	14" TJI® 110	1	3
F20	20' 1 3/4"	14" TJI® 110	1	5
F20A	20' 1 1/4"	14" TJI® 110	1	1
F19	19' 1 3/4"	14" TJI® 110	1	11
F19A	18' 11 1/2"	14" TJI® 110	1	6
F17	16' 3 3/4"	14" TJI® 110	1	2
F14	13' 11"	14" TJI® 110	1	2
F13	13' 1 3/4"	14" TJI® 110	1	2
F12	12' 7 1/4"	14" TJI® 110	1	5
F12A	12' 4 3/4"	14" TJI® 110	1	1
F7	6' 2 1/2"	14" TJI® 110	1	1
F4	3' 1/2"	14" TJI® 110	1	1
F3	14" TJI® 110	14" TJI® 110	1	2
M1-2	13/4" x 14" L5E Microllam® LVL	13/4" x 14" L5E Microllam® LVL	2	2
M2-2	13/4" x 14" L5E Microllam® LVL	13/4" x 14" L5E Microllam® LVL	2	2
M3-2	9' 0" L5E Microllam® LVL	13/4" x 14" L5E Microllam® LVL	2	2
M4-2	13/4" x 14" L5E Microllam® LVL	13/4" x 14" L5E Microllam® LVL	2	2
M5-2	1 1/8" x 14" TJI® Rim Board	1 1/8" x 14" TJI® Rim Board	1	11

WARNING

Joists are unstable until braced laterally

Bracing Includes:

- Blocking
- Hangers
- Sheathing
- Rim Board
- Stud Lines
- Rim Joist



DO NOT walk on joists until braced. INJURY MAY RESULT.



DO NOT walk on joists that are lying flat.



DO NOT stack building materials on finished joists or walls.

WARNING NOTES:

Lack of proper bracing during construction can result in serious accidents. Observe the following guidelines:

1. All blocking, hangers, rim boards and rim joists at the end supports of the TJI joists must be completely installed and properly nailed.
2. Lateral strength, like braced end wall or an existing deck, must be established at the ends of the bay. This can also be accomplished by a temporary or permanent deck (sheathing) fastened to the first 4 feet of joists at the end of the bay.
3. Safety bracing of 1x4 (minimum) must be nailed to a braced end wall or sheathed area (as in note 2) and to each joist. Without this bracing, backing sideways or rollover is highly probable under light construction loads - such as a worker or one layer of unnailed sheathing.
4. Sheathing must be completely attached to each TJI joist before additional loads can be placed on the system.
5. Ends of cantilevers require safety bracing on both the top and bottom flanges.
6. The fit-ups must remain straight within 1/2" from true alignment.

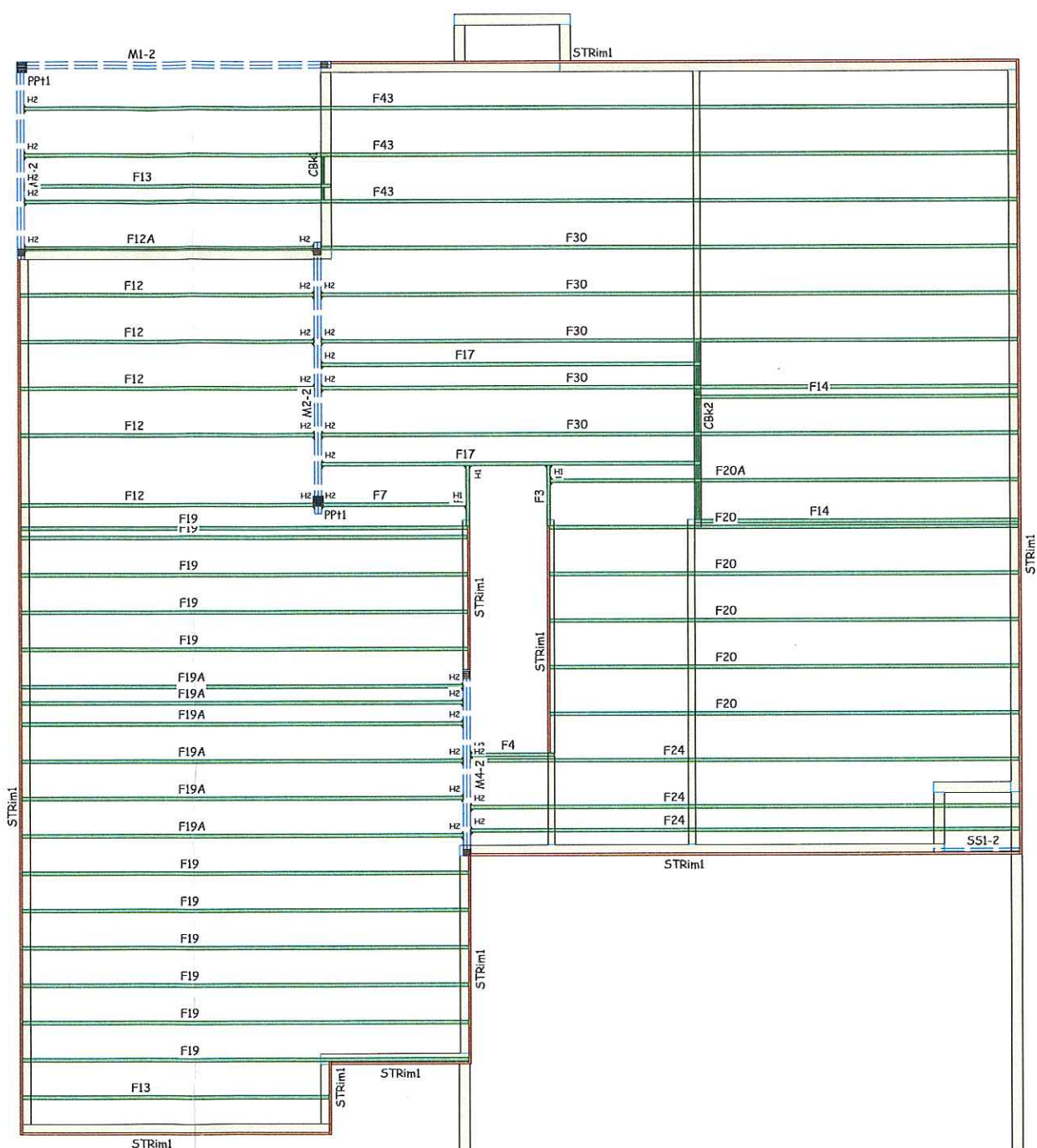

Blocking				
PlotID	Length	Product	Plies	Net Qty
CBK1	2' 0"	14" TJI® 110	1	1
CBK2	2' 0"	14" TJI® 110	1	3
CBK1	1' 0"	14" TJI® 110	1	1
CBK2	1' 0"	14" TJI® 110	1	4

Framing Connector Summary							
PlotID	Qty	Manuf	Product	Design Method	Supporting Mtl	Filler	Supported Mtl
H1	4	Simpson	IUS1.81/14	Designed	TJOIST	No	14" TJI® 110
H2	28	Simpson	IUS1.81/14	Designed	LVL	No	14" TJI® 110

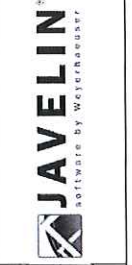

Drawn By:
Checked By:
Release Date:
Revision Date:

These placement plans have been developed for the specification of products based on project information provided. This service is solely intended for product application assurance, and is not intended to circumvent the need for a design professional as determined by the building code. The designer of record and/or builder/framer is responsible to assure these drawings are compatible with the overall project.

Address//Lot:
City, State:
Job #:
Scale: 1/4" = 1'

Customer: H and K Homes
Job Name: Regan Plan
Plan/Model #:
Subdivision:

Sheet:
2 of 2