

**Improvement Permit**

A building permit cannot be issued with only an Improvement Permit

ISSUED TO: Butler & Veshti Tyler PROPERTY LOCATION: 456 Natchez Trace (SR 1463)  
 NEW  REPAIR  EXPANSION  SUBDIVISION: Captains Landing LOT # 44  
 Type of Structure: 2BR 50'x36' SFD Site Improvements required prior to Construction Authorization Issuance:  
 Proposed Wastewater System Type: Pump to 25% Red. Sys.  
 Projected Daily Flow: 240 GPD  
 Number of bedrooms: 2 Number of Occupants: 4 max  
 Basement  Yes  No  
 Pump Required:  Yes  No  May be required based on final location and elevations of facilities  
 Type of Water Supply:  Community  Public  Well Distance from well NA feet Permit valid for:  Five years  
 Permit conditions:  No expiration

Authorized State Agent: [Signature] Date: 08/07/2018 SEE ATTACHED SITE SKETCH  
 The issuance of this permit by the Health Department in no way guarantees the issuance of other permits. The permit holder is responsible for checking with appropriate governing bodies in meeting their requirements. This site is subject to revocation if the site plan, plat, or the intended use changes. The Improvement Permit shall not be affected by a change in ownership of the site. This permit is subject to compliance with the provisions of the Laws and Rules for Sewage Treatment and Disposal and to conditions of this permit.

**Construction Authorization**

(Required for Building Permit)

The construction and installation requirements of Rules .1950, .1952, .1954, .1955, .1956, .1957, .1958, and .1959 are incorporated by references into this permit and shall be met. Systems shall be installed in accordance with the attached system layout.

ISSUED TO: Butler & Veshti Tyler PROPERTY LOCATION: 456 Natchez Trace (SR 1463)  
 Facility Type: 2BR 50'x36' SFD  New  Expansion  Repair  
 Basement?  Yes  No Basement Fixtures?  Yes  No  
 Type of Wastewater System\*\* Pump to 25% reduction Sys. (Initial) Wastewater Flow: 240 GPD  
 (See note below, if applicable   
Repair Exception (Repair) - max repair will be obtained  
**Installation Requirements/Conditions**  
 Septic Tank Size 1000 gallons Number of trenches 3  
 Pump Tank Size 1000 gallons Exact length of each trench 70 feet Trench Spacing: 9 Feet on Center  
 Trenches shall be installed on contour at a Soil Cover: 6 inches  
 Maximum Trench Depth of: 18 inches (Maximum soil cover shall not exceed 36" above the trench bottom)  
 (Trench bottoms shall be level to +/-1/4" in all directions)  
 Pump Requirements: \_\_\_\_\_ ft. TDH vs. \_\_\_\_\_ GPM Aggregate Depth: NA inches below pipe  
 \_\_\_\_\_ inches above pipe  
 \_\_\_\_\_ inches total

**WATER LINES (INCLUDING IRRIGATION) MUST BE 10FT. FROM ANY PART OF SEPTIC SYSTEM OR REPAIR AREA. NO UTILITIES ALLOWED IN INITIAL OR REPAIR DRAIN FIELD AREA.**

\*\*If applicable: I understand the system type specified is different from the type specified on the application. I accept the specifications of this permit.

Owner/Legal Representative Signature: \_\_\_\_\_ Date: \_\_\_\_\_

This Construction Authorization is subject to revocation if the site plan, plat, or the intended use changes. The Construction Authorization shall not be transferred when there is a change in ownership of the site. This Construction Authorization is subject to compliance with the provisions of the Laws and Rules for Sewage Treatment and Disposal and to the conditions of this permit. SEE ATTACHED SITE SKETCH

Authorized State Agent: [Signature] Date: 08/07/2018  
 Construction Authorization Expiration Date: 08/07/2023

HTE# SFD1807-0035

Permit # 30159

# Harnett County Department of Public Health Site Sketch

ISSUED TO: Butler & Vashti Tyler PROPERTY LOCATOR: 456 Natchez Trace (SR1463)  
SUBDIVISION Captains Landing LOT # 44

Authorized State Agent: Andrew Wain, NCHS Date: 08/07/2018  
ANDREW WAIN

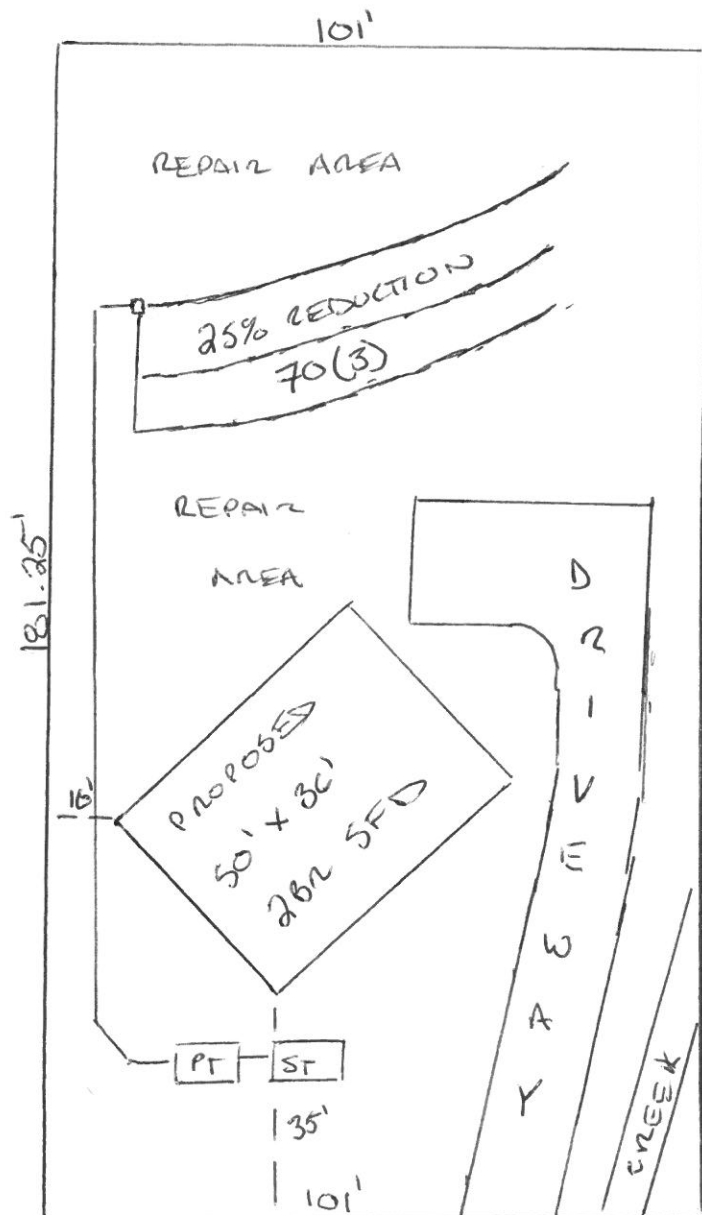

\* PROPOSED PADS, SHEDS, DRIVES IN REAR LOT SHALL BE DEPENDENT ON FINAL LOCATION OF SEPTIC [OWNER, INSTALLER, INSPECTOR COORDINATION REQUIRED]

\* TANK LOCATIONS CAN CHANGE BASED ON PLUMBING REQUIREMENTS

\* Repair Area exemption based on lot coverage  
- Maximum available repair will be obtained

NATCHEZ TRACE

SFD 1807-0035

**SOIL/SITE EVALUATION**  
**for ON-SITE WASTEWATER SYSTEM**

Owner:            Applicant: Tyler Butler  
 Address: 456 Natchez Tr. Date Evaluated: 07/30/2018  
 Proposed Facility: 202 SFD Design Flow (.1949): 240 GPD Property Size:  
 Location of Site:            Property Recorded: yes  
 Water Supply:  Public  Individual  Well  Spring  Other  
 Evaluation Method:  Auger Boring  Pit  Cut  
 Type of Wastewater:  Sewage  Industrial Process  Mixed

P R O F I L E #	.1940 Landscape Position/ Slope %	Horizon Depth (In.)	SOIL MORPHOLOGY .1941		OTHER PROFILE FACTORS				Profile Class & LTAR
			.1941 Structure/ Texture	.1941 Consistence Mineralogy	.1942 Soil Wetness/ Color	.1943 Soil Depth (IN.)	.1956 Sapro Class	.1944 Restr Horiz	
1	L 10-20%	0-8	CL SL	VR SSSP					
		8-36	BK C	VI SP					PS
		36+	Parent Mat.	—		36			0.3
2,4	L 8-14%	0-6	CL SL	FL SSSP					
		6-40	gr C	F1 SP					PS
		40+	Parent Mat.	—		40			0.3
3	L 8-14%	0-6	CL SL	FR SSSP					
		6-34	BK C	F1 SP					PS
		34+	Parent Mat.	—		34			0.3

Description	Initial System	Repair System	Other Factors (.1946): Site Classification (.1948): Evaluated By: Others Present:
Available Space (.1945)	<input checked="" type="checkbox"/>	<input checked="" type="checkbox"/>	
System Type(s)	<u>25% LCL</u>	<u>Not Required</u>	
Site LTAR	<u>0.3</u>	<u>Not Required</u>	

Provisionally Suitable  
 Andrew Curcio, N.E.H.S

[DEED OMIT]