

HARNETT DEPARTMENT OF PUBLIC HEALTH PERMIT
TO CONSTRUCT A DRINKING WATER SUPPLY WELL

PIN #: 0681 31 8544 Parcel #: 110681 0005 09 Application #: 17-5-41248R Subdivision: _____ Lot #: _____

Applicant Name: Clayton Homes of Sanford
Address: Sheriff Johnson Rd. (SR 1516)

Type of Facility Served by Well: SFD

Sewage System: 25% Reduction System

Permit Conditions: _____

General Permit Conditions:

- Drinking water supply well construction must meet 15A NCAC 02C.100 rules
- The permitted drinking water supply well shall be located in accordance with the **SITE PLAN**
- **ANY ALTERATION** of the site of the site (including location of structures and appurtenance) or modification in use of the well, may subject this Permit to revocation

Authorized State Agent James E. Markham Date 5-22-17

Grouting Inspection Witnessed Stacy Cook, NCHS Date 07-07-17

Grouting self-certified by driller GW-1 provided? Yes No

See attachment for construction sketch

WELL CERTIFICATE OF COMPLETION

Date: _____ Application #: _____ Well Contractor: _____

Applicant Name: _____
Address: _____
Directions to Site: _____

Use of Well: _____ Date Drilled: _____ Total Depth: _____ Replacement Well? Yes No
Static Water Level: _____ Top of Casing is _____ in. above surface. Yield: _____ gpm at _____ ft.
Disinfection: Type _____ Amount _____

Water Zone (depth)

From _____ To _____
From _____ To _____
From _____ To _____

Casing

From _____ To _____
Diameter: _____ Material: _____ Thickness: _____
From _____ To _____
Diameter: _____ Material: _____ Thickness: _____
From _____ To _____
Diameter: _____ Material: _____ Thickness: _____

Grout

From 0 To _____
Material: _____ Method: _____
From _____ To _____
Material: _____ Method: _____
From _____ To _____
Material: _____ Method: _____

Inspector: _____ On Hold Date: _____ Release Date: _____

Remarks: _____

Well Head Information

Casing Height: 11in (above finished grade) Access Port: Vent Stack:
Well ID Tag: Pump ID Tag: _____ Sampling Tap: Backflow Preventer:
Sample Taken? Yes No Well Head properly sealed:

Remarks: Applicant request sample when power is present

Authorized State Agent James E. Markham Date 08/07/17

See Attachment for completion sketch

Application #:

Applicant Name:

Subdivision: _____

Lot #: _____

Well Construction Sketch

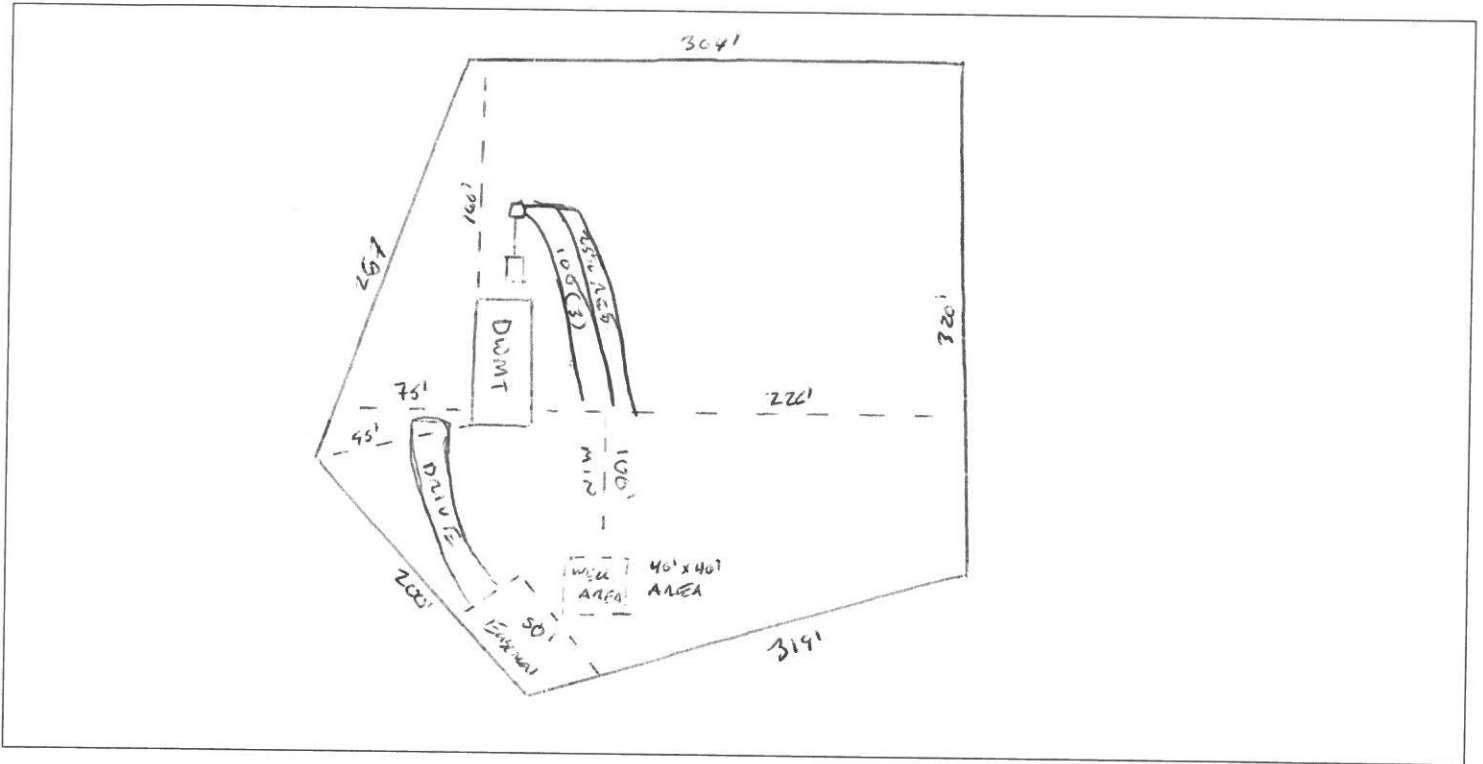

Well Completion Sketch

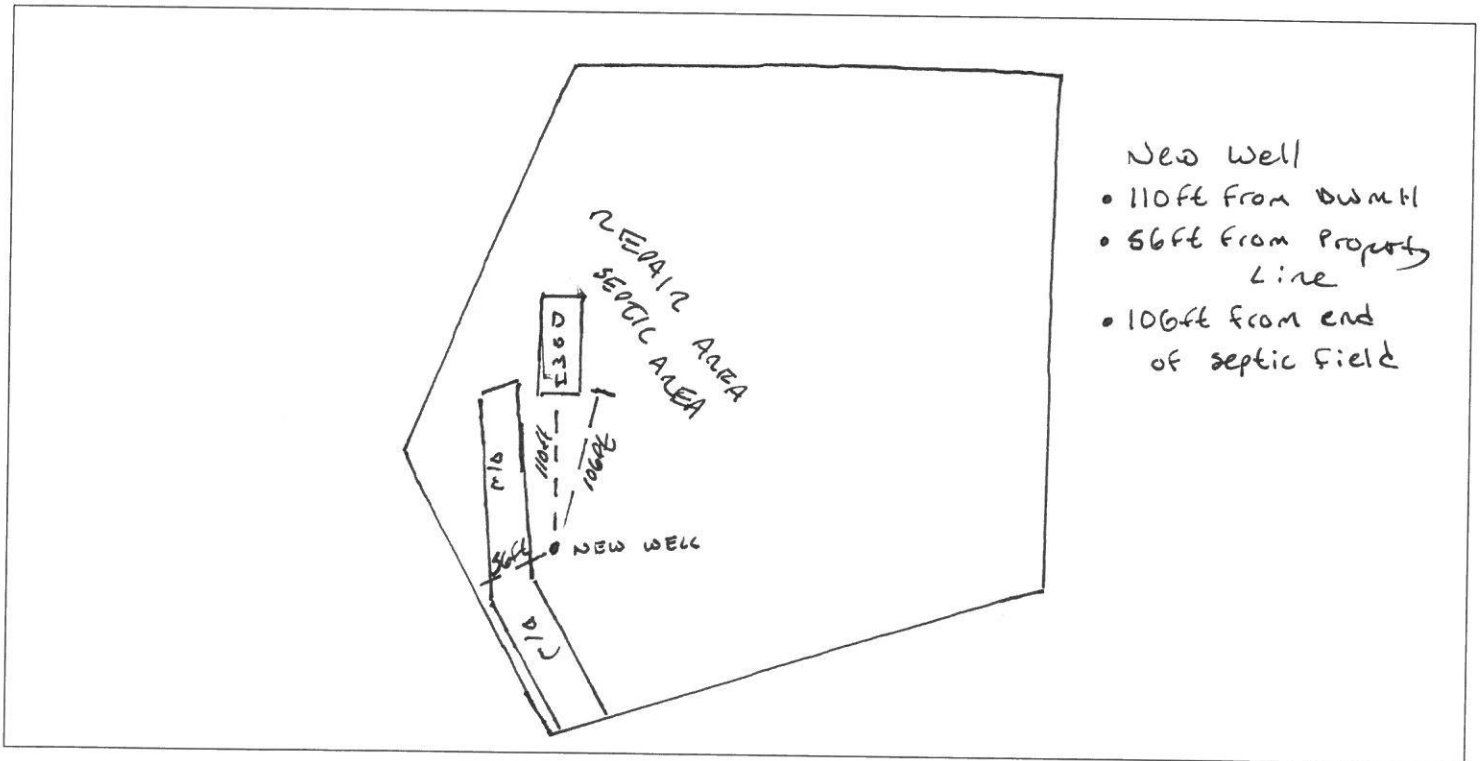

- New Well
- 110ft From DWMT
 - 56ft From Property Line
 - 106ft from end of septic field

WELL CONSTRUCTION RECORD (GW-1)

1. Well Contractor Information:

RAY MANNESS

Well Contractor Name

NCWC 2460-A

NC Well Contractor Certification Number

W W MANNESS & SON'S

Company Name

2. Well Construction Permit # **HARWETT CO Perm: T**

List all applicable well construction permits (i.e. UIC, County, State, Variance, etc.)

3. Well Use (check well use):

Water Supply Well:

- Agricultural Municipal/Public
 Geothermal (Heating/Cooling Supply) Residential Water Supply (single)
 Industrial/Commercial Residential Water Supply (shared)
 Irrigation

Non-Water Supply Well:

- Monitoring Recovery

Injection Well:

- Aquifer Recharge Groundwater Remediation
 Aquifer Storage and Recovery Salinity Barrier
 Aquifer Test Stormwater Drainage
 Experimental Technology Subsidence Control
 Geothermal (Closed Loop) Tracer
 Geothermal (Heating/Cooling Return) Other (explain under #21 Remarks)

4. Date Well(s) Completed: **7-7-017** Well ID# _____

5a. Well Location:

Clayton Homes of Sanford

Facility/Owner Name

Facility ID# (if applicable)

1036 Sherill Johnson Rd, Hillington NC 27546

Physical Address, City, and Zip

HARWETT

County

Parcel Identification No. (PIN)

5b. Latitude and longitude in degrees/minutes/seconds or decimal degrees: (if well field, one lat/long is sufficient)

35° 25' 789" N 078° 43' 144" W

6. Is(are) the well(s): Permanent or Temporary

7. Is this a repair to an existing well: Yes or No

If this is a repair, fill out known well construction information and explain the nature of the repair under #21 remarks section or on the back of this form.

8. For Geoprobe/DPT or Closed-Loop Geothermal Wells having the same construction, only 1 GW-1 is needed. Indicate TOTAL NUMBER of wells drilled: **1**

9. Total well depth below land surface: **280** (ft.)

For multiple wells list all depths if different (example- 3@200' and 2@100')

10. Static water level below top of casing: **30** (ft.)

If water level is above casing, use "+"

11. Borehole diameter: **6** (in.)

12. Well construction method: **Rotary drilled**

(i.e. auger, rotary, cable, direct push, etc.)

FOR WATER SUPPLY WELLS ONLY:

13a. Yield (gpm) **6** Method of test: **Air**

13b. Disinfection type: **HTH** Amount: **1465**

For Internal Use Only:

14. WATER ZONES

FROM	TO	DESCRIPTION
ft.	ft.	6 gpm @ 115'
ft.	ft.	

15. OUTER CASING (for multi-cased wells) OR LINER (if applicable)

FROM	TO	DIAMETER	THICKNESS	MATERIAL
0 ft.	95 ft.	6 in.		SDR21 PVC

16. INNER CASING OR TUBING (geothermal closed-loop)

FROM	TO	DIAMETER	THICKNESS	MATERIAL
ft.	ft.	in.		
ft.	ft.	in.		

17. SCREEN

FROM	TO	DIAMETER	SLOT SIZE	THICKNESS	MATERIAL
ft.	ft.	in.			
ft.	ft.	in.			

18. GROUT

FROM	TO	MATERIAL	EMPLACEMENT METHOD & AMOUNT
0 ft.	20+ ft.	Benitegrout	 pumped
ft.	ft.	9 solimb	 Benite
ft.	ft.		

19. SAND/GRAVEL PACK (if applicable)

FROM	TO	MATERIAL	EMPLACEMENT METHOD
ft.	ft.		
ft.	ft.		

20. DRILLING LOG (attach additional sheets if necessary)

FROM	TO	DESCRIPTION (color, hardness, soil/rock type, grain size, etc.)
0 ft.	5 ft.	CLAY
5 ft.	88 ft.	CLAY + SANDSTONE
88 ft.	280 ft.	BLUE ROCK
ft.	ft.	
ft.	ft.	
ft.	ft.	

21. REMARKS

22. Certification:

Ray Manness
Signature of Certified Well Contractor

7-7-017
Date

By signing this form, I hereby certify that the well(s) was (were) constructed in accordance with 15A NCAC 02C.0100 or 15A NCAC 02C.0200 Well Construction Standards and that a copy of this record has been provided to the well owner.

23. Site diagram or additional well details:

You may use the back of this page to provide additional well site details or well construction details. You may also attach additional pages if necessary.

SUBMITTAL INSTRUCTIONS

24a. For All Wells: Submit this form within 30 days of completion of well construction to the following:

Division of Water Resources, Information Processing Unit,
1617 Mail Service Center, Raleigh, NC 27699-1617

24b. For Injection Wells: In addition to sending the form to the address in 24a above, also submit one copy of this form within 30 days of completion of well construction to the following:

Division of Water Resources, Underground Injection Control Program,
1636 Mail Service Center, Raleigh, NC 27699-1636

24c. For Water Supply & Injection Wells: In addition to sending the form to the address(es) above, also submit one copy of this form within 30 days of completion of well construction to the county health department of the county where constructed.