

PROCEDURES AND GUIDELINES FOR MANUFACTURED HOMES

Replacement & Removal Criteria

165.40404
Revised
3.17.17

I, JEFF LUCAS, do hereby certify the following:
(Print Name)

1. That I own a tract of land located on SR 1250 in an RA-30 RA-40 or RA-20R /RA-20M district which has a functional septic tank;
2. That the existing single/double-wide manufactured home is to be removed or was removed on After (date) The Owner comes in - after inspections start.
3. That I am replacing an existing single/double wide manufactured home with a single/double wide manufactured home, and;
4. That the replacement of this manufactured home creates 2 residence(s) on this single tract of land, and;
5. That there will be 2 manufactured home(s) on this single tract of land and I do/do not own property within 500 feet of this tract that contains a manufactured home.
6. The home must have a pitched roof, for a manufactured home, whether A-shaped or rounded, which has a minimum rise (measured at the center of the home) of twelve (12) inches for every seven (7) feet of total width of the home. (Example: A home measuring fourteen (14 ft.) in width must have a twenty four (24) inch rise as measured from the center of the roofline to the baseline of the roof.) (See Illustrations Below.)

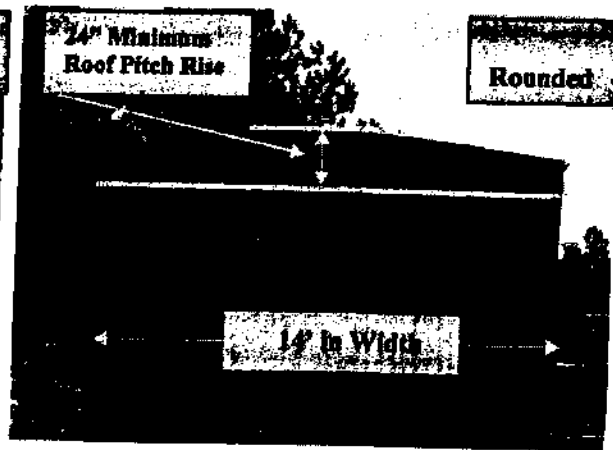
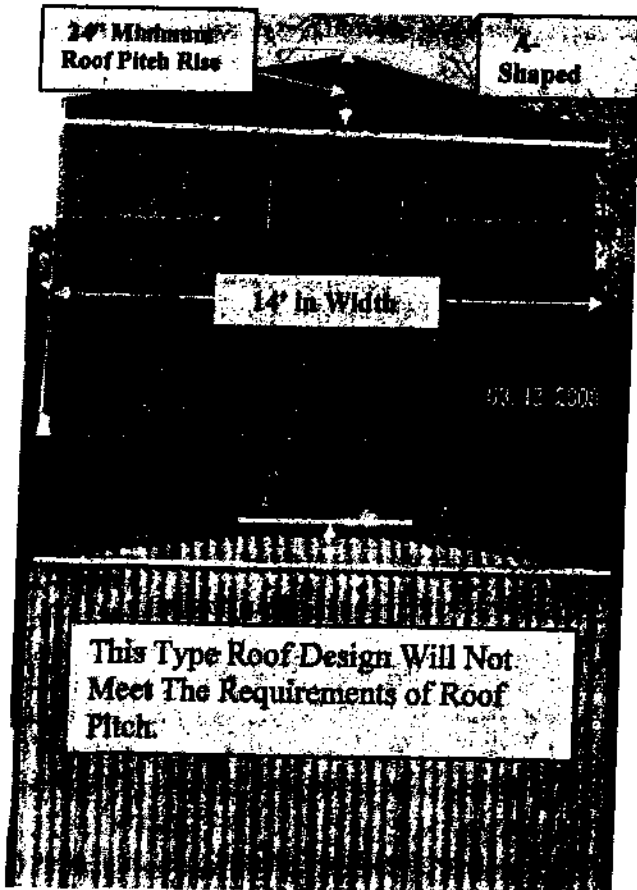

Note: Most Rounded Roofs Will Not Meet The Roof Pitch Requirement As Illustrated. The Measurement From The Peak Of The Roof To The Base Line Of The Roof Must Be 12" For Every 7' Of Total Width Of The Home. (14' Wide Home = 24" Roof Rise)

7. The home must be underpinned, the underpinning must be designed for manufactured homes & installed in good workmanship-like manner along the entire base of a manufactured home, except for ventilation and crawl space requirements, and consisting of the following: metal with a baked -on finish of uniform color; a uniform design and color vinyl; or brick, cinder block, and stone masonry as well as artificial stone masonry.
8. The homes moving apparatus removed, underpinned or landscaped.

Select One of the Following Options Below:

The current manufactured home will be removed prior to the Zoning Inspection.

The current manufactured home is scheduled to be removed through Project AMPI

The current manufactured home will be removed after the final inspection has been performed and the certificate of occupancy has been issued. **(Additional Fees & Requirements Shall Apply)**

***(Additional Information for Option C) Temporary approval for replacement of a manufactured home is allowed only under the procedures and limitations stated below.**

Please initial next to each item to indicate that you understand and have or will comply as necessary.

- 1) A valid manufactured home moving permit must be submitted for the removal of the existing home located on the property.
- 2) A copy of a Bill of Sale or a Title Transfer of the existing home must be submitted.
- 3) Items 1 & 2 must be submitted to Central Permitting prior to your permit issuance.
- 4) Property owner/agent acknowledges that due to the fact that a second zoning inspection is required, in order to facilitate this request, a re-inspection fee in the amount of fifty (\$50.00) dollars shall be paid during the permitting process.
- 5) Once the home has met all other zoning requirements, a temporary approval shall be granted in order to proceed with obtaining a certificate of occupancy. From the date the certificate of occupancy is issued, the property owner shall have five (5) business days to remove the pre-existing manufactured home.
- 6) Property owner/agent acknowledges that if the pre-existing manufactured home is not removed by the specified time of five (5) business days that he / or she shall be in direct violation of the Harnett County Zoning Ordinance. And by creating a violation of the Harnett County Zoning Ordinance shall subject themselves to enforcement actions, penalties, and fines specified within Article XV, (Administration, Enforcement, and Penalties) of the Harnett County Zoning Ordinance. Each day the violation continues is a separate offence and is a misdemeanor punishable by a fine not to exceed one hundred (\$100.00) dollars or imprisonment not to exceed thirty (30) days.
- 7) Property owner/agent acknowledges and affirms that the guidelines, procedures, and requirements associated with the replacement of a manufactured home and the penalties for creating a violation of the Harnett County Zoning Ordinance have been explained and accepts this document as an initial notice of violation.



Signature of Property Owner

12-16-16

Date

***By signing this form the owner/agent is stating that they have read and understand the information on this form**