

**HARNETT DEPARTMENT OF PUBLIC HEALTH PERMIT
TO CONSTRUCT A DRINKING WATER SUPPLY WELL**

PIN #: 1518-97-0694.000 _____ Parcel #: 02-1518-0140-08 _____ Application #: 11-5-26417R _____ Subdivision: ROY DUNN
Lot #: 2

Applicant Name: James and Jerryline Alston _____
Address: 146 Hobson Rd Dunn N.C. 28334

Type of Facility Served by Well: M/H

Sewage System: 25%Reduction System _____

Permit Conditions: _____

General Permit Conditions:

- Drinking water supply well construction must meet 15A NCAC 02C.100 rules
- The permitted drinking water supply well shall be located in accordance with the **SITE PLAN**
- **ANY ALTERATION** of the site of the site (including location of structures and appurtenance) or modification in use of the well, may subject this Permit to revocation

Authorized State Agent James E. Manhart Date 5-23-11

Grouting Inspection Witnessed _____ Date _____

Grouting self-certified by driller GW-1 provided? Yes No

See attachment for construction sketch

WELL CERTIFICATE OF COMPLETION

Date: _____ Application #: _____ Well Contractor: _____

Applicant Name: _____

Address: _____

Directions to Site: _____

Use of Well: _____ Date Drilled: _____ Total Depth: _____ Replacement Well? Yes No

Static Water Level: _____ Top of Casing is _____ in. above surface. Yield: _____ gpm at _____ ft.

Disinfection: Type _____ Amount _____

Water Zone (depth)

From _____ To _____

From _____ To _____

From _____ To _____

Casing

From _____ To _____

Diameter: _____ Material: _____ Thickness: _____

From _____ To _____

Diameter: _____ Material: _____ Thickness: _____

From _____ To _____

Diameter: _____ Material: _____ Thickness: _____

Grout

From 0 To _____

Material: _____ Method: _____

From _____ To _____

Material: _____ Method: _____

From _____ To _____

Material: _____ Method: _____

Inspector: _____ On Hold Date: _____ Release Date: _____

Remarks: _____

Well Head Information

Casing Height: _____ (above finished grade)

Access Port: _____

Vent Stack: _____

Well ID Tag: _____

Pump ID Tag: _____

Sampling Tap: _____

Backflow Preventer: _____

Sample Taken? Yes No

Well Head properly sealed: _____

Remarks: _____

Authorized State Agent _____ Date _____

See Attachment for completion sketch

Application #: 11-S-264172

Applicant Name: James + Jenny Line

Subdivision: 1244 H DONO

Lot #: 2

Well Construction Sketch

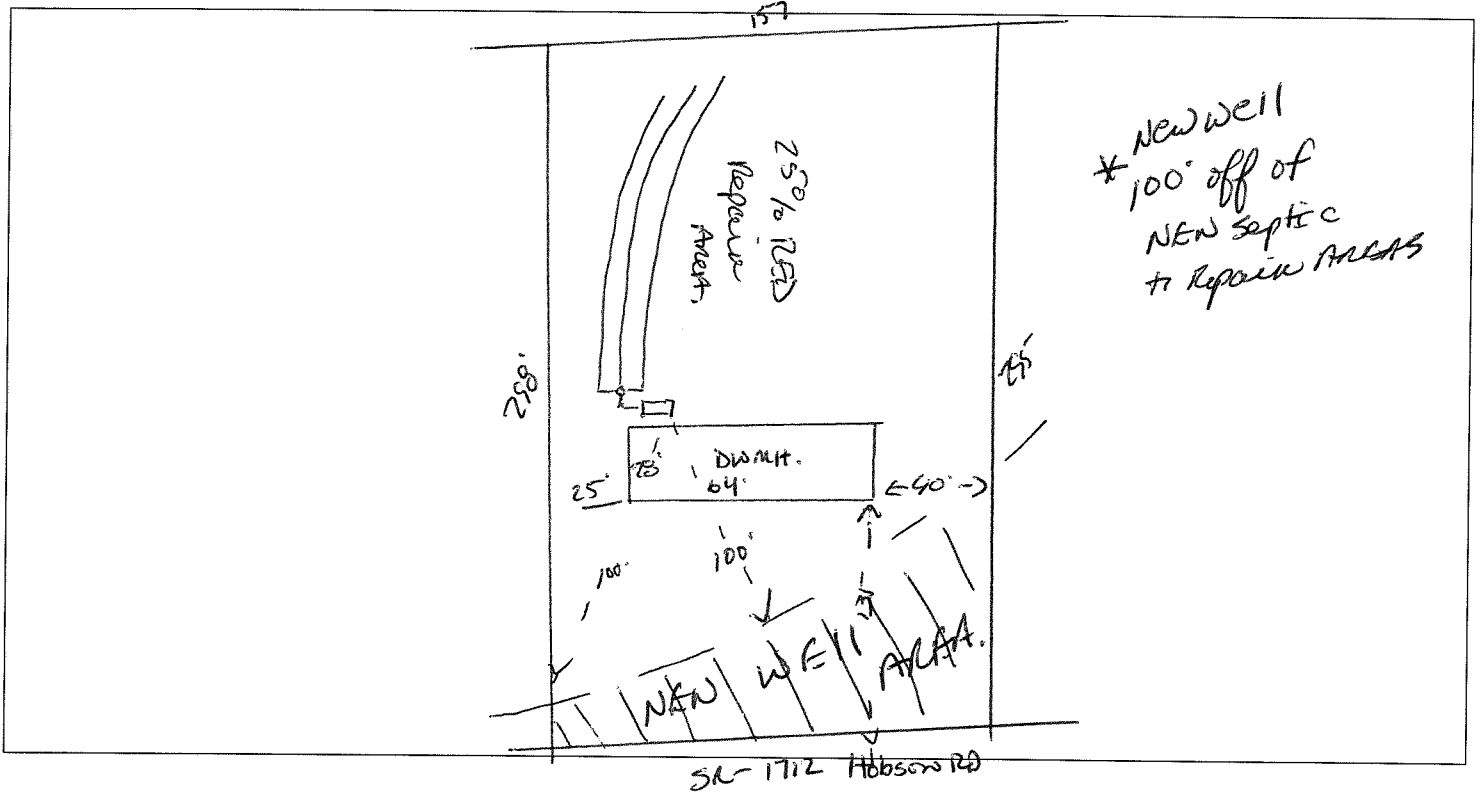

Well Completion Sketch

