

Improvement Permit

A building permit cannot be issued with only an Improvement Permit

ISSUED TO: Holly JD Whitehead
PROPERTY LOCATION: SC-2007 Clayhale RD
SUBDIVISION: Southwind LOT # 1
Type of Structure: DWMH 28x80
Proposed Wastewater System Type: 25% REDUCTION System
Projected Daily Flow: 480 GPD
Number of bedrooms: 4 Number of Occupants: 8 max
Basement: No
Pump Required: May be required based on final location and elevations of facilities
Type of Water Supply: Public
Permit conditions: CONTRACTOR TO MEET ON SITE PRIOR TO INSTALL

Authorized State Agent: James E. Marshall Date: 9-14-10 SEE ATTACHED SITE SKETCH
The issuance of this permit by the Health Department in no way guarantees the issuance of other permits. The permit holder is responsible for checking with appropriate governing bodies in meeting their requirements. This site is subject to revocation if the site plan, plat, or the intended use changes. The Improvement Permit shall not be affected by a change in ownership of the site. This permit is subject to compliance with the provisions of the Laws and Rules for Sewage Treatment and Disposal and to conditions of this permit.

Construction Authorization

(Required for Building Permit)

The construction and installation requirements of Rules .1950, .1952, .1954, .1955, .1956, .1957, .1958, and .1959 are incorporated by references into this permit and shall be met. Systems shall be installed in accordance with the attached system layout.

ISSUED TO: Holly JD Whitehead
PROPERTY LOCATION: SC 2007 Clayhale RD
SUBDIVISION: Southwind LOT # 1
Facility Type: DWMH 28x80 New
Basement? No Basement Fixtures? No
Type of Wastewater System: 25% REDUCTION System (Accepted) (Initial) Wastewater Flow: 480 GPD
Installation Requirements/Conditions:
Number of trenches: 2
Septic Tank Size: 1200 gallons
Exact length of each trench: 150 feet
Trench Spacing: 9 Feet on Center
Pump Tank Size: gallons
Trenches shall be installed on contour at a
Maximum Trench Depth of: 24" max inches
(Pump Requirements: ft. TDH vs. GPM)
Aggregate Depth: 6 inches below pipe, 2 inches above pipe, 12 inches total
Conditions: Contractor to meet on site prior to install.

**If applicable: I understand the system type specified is different from the type specified on the application. I accept the specifications of this permit.

Owner/Legal Representative Signature: _____ Date: _____

This Construction Authorization is subject to revocation if the site plan, plat, or the intended use changes. The Construction Authorization shall not be transferred when there is a change in ownership of the site. This Construction Authorization is subject to compliance with the provisions of the Laws and Rules for Sewage Treatment and Disposal and to the conditions of this permit. SEE ATTACHED SITE SKETCH

Authorized State Agent: James E. Marshall Date: 9-14-10
Construction Authorization Expiration Date: 9-14-15

HTE# 10-5-25094

Permit # 26075

Harnett County Department of Public Health Site Sketch

ISSUED TO: Holly Jo Whitehead PROPERTY LOCATOR: 512007 Clay Lake RD
SUBDIVISION Southwind LOT # 1

Authorized State Agent: James E. Markham 10048 Date: 9-14-10

* Contractor to MGMT
ON SITE Prior to INSTALL.

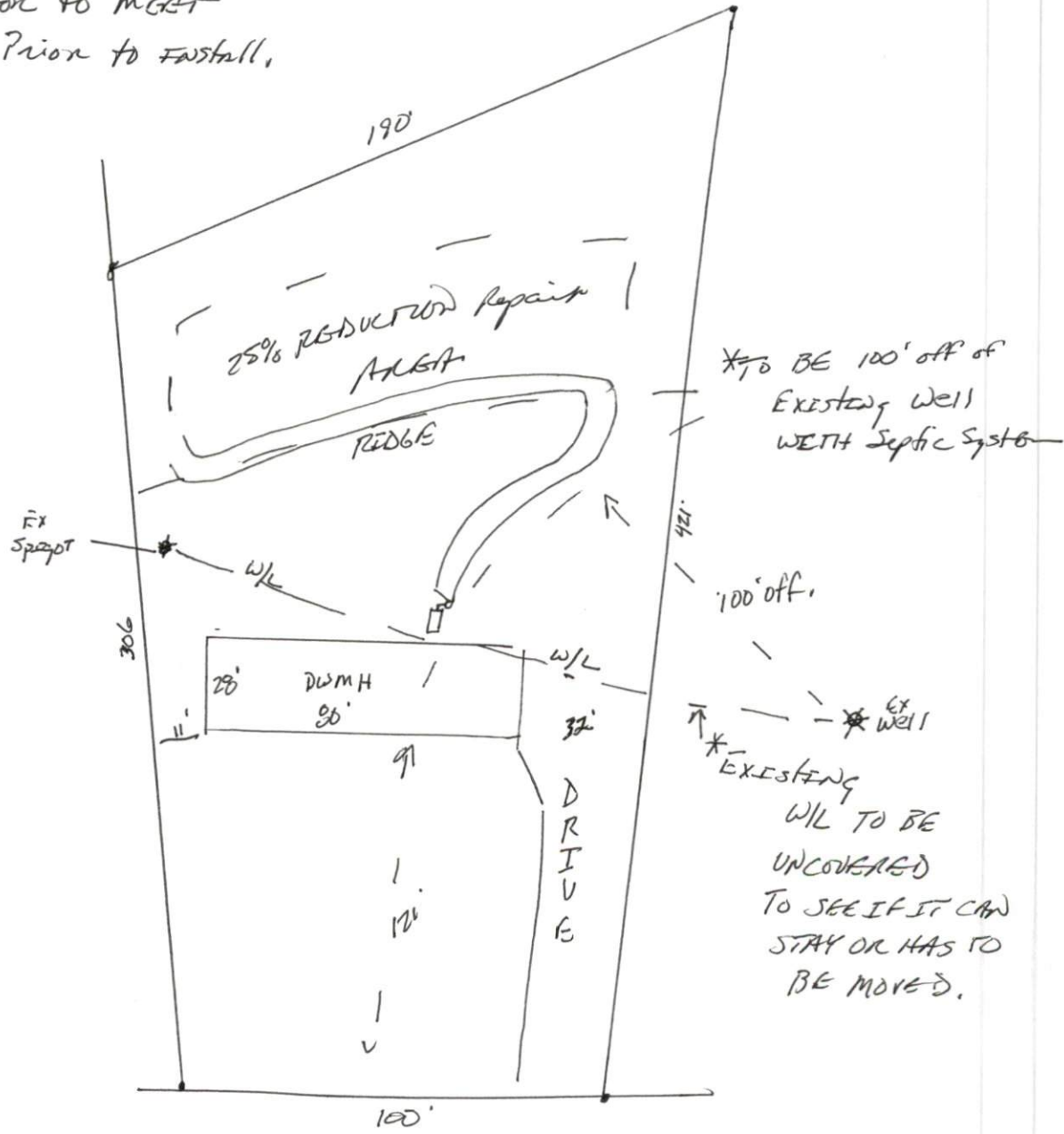

512007 CLAY LAKE RD