

Improvement Permit

A building permit cannot be issued with only an Improvement Permit

ISSUED TO: Martha Parsons
PROPERTY LOCATION: Su.H Rd
SUBDIVISION: Su.H Farms LOT # 4
Type of Structure: MH 32x48 3BR
Proposed Wastewater System Type: Gravel
Projected Daily Flow: 360 GPD
Number of bedrooms: 3 Number of Occupants: 6 max
Basement: No
Pump Required: No
Type of Water Supply: Public
Permit conditions: Stub out plumbing shallow at ground level or higher where shown. maintain all set back, meet onsite

Authorized State Agent: Joe W... Date: 11-27-07 SEE ATTACHED SITE SKETCH
The issuance of this permit by the Health Department in no way guarantees the issuance of other permits. The permit holder is responsible for checking with appropriate governing bodies in meeting their requirements. This site is subject to revocation if the site plan, plat, or the intended use changes. The Improvement Permit shall not be affected by a change in ownership of the site. This permit is subject to compliance with the provisions of the Laws and Rules for Sewage Treatment and Disposal and to conditions of this permit.

Construction Authorization

(Required for Building Permit)

This construction and installation requirements of Rules .1950, .1952, .1954, .1955, .1956, .1957, .1958, and .1959 are incorporated by references into this permit and shall be met. Systems shall be installed in accordance with the attached system layout.

ISSUED TO: Martha Parsons
PROPERTY LOCATION: Su.H Rd
SUBDIVISION: Su.H Farms LOT # 4
Facility Type: MH-32x48 3BR New
Basement? No
Type of Wastewater System: Gravel (Initial)
Wastewater Flow: 360 GPD
Pump to Gravel (Repair)

Installation Requirements/Conditions

Septic Tank Size 1000 gallons
Pump Tank Size
Exact length of each trench 1 x 300 feet
Trenches shall be installed on contour at a
Maximum Trench Depth of 18 inches
Trench Spacing: 9 Feet on Center
Soil Cover: 6 inches
Aggregate Depth: 6 inches below pipe, 2 inches above pipe, 12 inches total

**If applicable: I understand the system type specified is different from the type specified on the application. I accept the specifications of this permit.

Owner/Legal Representative Signature: Date:

This Construction Authorization is subject to revocation if the site plan, plat, or the intended use changes. The Construction Authorization shall not be transferred when there is a change in ownership of the site. This Construction Authorization is subject to compliance with the provisions of the Laws and Rules for Sewage Treatment and Disposal and to the conditions of this permit.

Authorized State Agent: Joe W... Date: 11-27-07 SEE ATTACHED SITE SKETCH
Construction Authorization Expiration Date: 11-27-2012

HTE# 07-500-18779

Permit # 23566

Harnett County Department of Public Health Site Sketch

ISSUED TO: Martha Parsons

PROPERTY LOCATOR: Suitt Rd

SUBDIVISION SUITT FARM

LOT # 4

Authorized State Agent: J. W. [Signature]

Date: 11-27-07

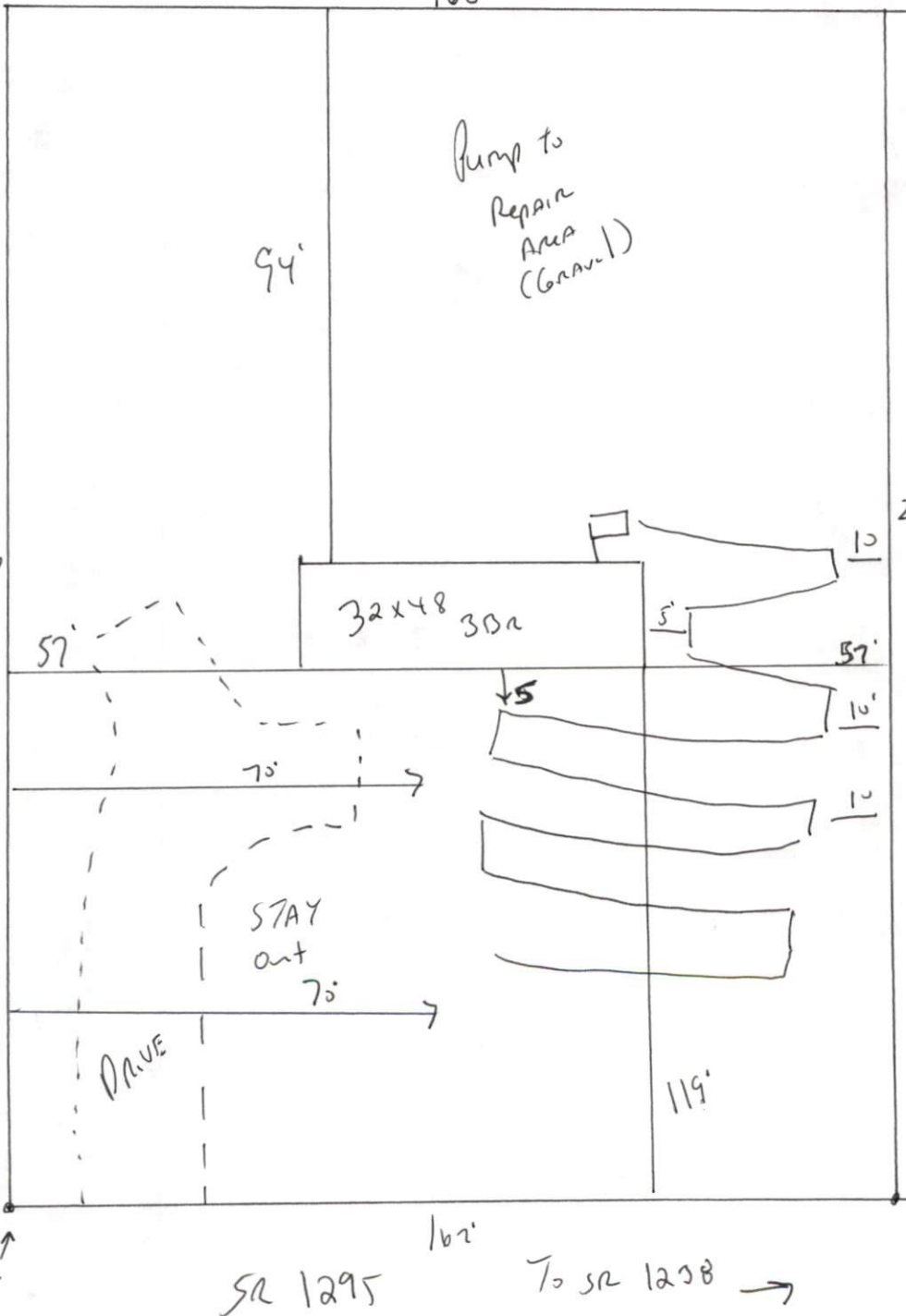

Meet on site for Final Layout

STUB out Plumbing Shallow, At Ground Level or higher Where shown

MAINTAIN all Setbacks

INSTALL 1x300 of gravel at 18"

Keep Drainfield 70' from Left hand property Line As shown.