

Initial Application Date: 05/19/05

Application # 0550012177

COUNTY OF HARNETT LAND USE APPLICATION
Central Permitting 102 E. Front Street, Lillington, NC 27546

Phone: (910) 893-4759 Fax: (910) 893-2793
938187

LANDOWNER: Mitchell Holland Mailing Address: PO Box 193
City: Lillington State: NC Zip: 27546 Phone #: _____
APPLICANT: Michael Coleman Mailing Address: PO Box 2242
City: Lillington State: NC Zip: 27546 Phone #: (910) 890-5134

PROPERTY LOCATION: SR #: 12057 SR Name: South River Rd
Address: South River Rd
Parcel: 130031001109 PIN: 17031-365367.000
Zoning: RABD Subdivision: _____ Lot #: _____ Lot Size: 5.86
Flood Plain: Y Panel: 0080 Watershed: IV Deed Book/Page: 11043/351 Plat Book/Page: 2007/009

DIRECTIONS TO THE PROPERTY FROM LILLINGTON: Take 401 towards Sanford, turn right on S River Rd to dirt rd pass three DUMH on right bottom of hill land on right.

PROPOSED USE:

- Sg. Family Dwelling (Size ___ x ___) # of Bedrooms ___ # Baths ___ Basement (w/wo bath) ___ Garage ___ Deck ___
- Multi-Family Dwelling No. Units ___ No. Bedrooms/Unit ___
- Manufactured Home (Size 27 x 72) # of Bedrooms 5 Garage N/A Deck N/A
- Number of persons per household 4
- Business Sq. Ft. Retail Space _____ Type _____
- Industry Sq. Ft. _____ Type _____
- Church Seating Capacity _____ Kitchen _____
- Home Occupation (Size ___ x ___) # Rooms _____ Use _____
- Additional Information: _____
- Accessory Building (Size ___ x ___) Use _____
- Addition to Existing Building (Size ___ x ___) Use _____
- Other _____

Additional Information: _____
Water Supply: County Well (No. dwellings ___) Other Environmental Health Site Visit Date: 5/25
Sewage Supply: New Septic Tank Existing Septic Tank County Sewer Other
Erosion & Sedimentation Control Plan Required? YES NO

Property owner of this tract of land own land that contains a manufactured home w/in five hundred feet (500') of tract listed above? YES NO

Structures on this tract of land: Single family dwellings _____ Manufactured homes 1 Other (specify) _____

Required Residential Property Line Setbacks:	Minimum	Actual
Front	35	<u>50'</u>
Rear	25	<u>400'</u>
Side	10	<u>40'</u>
Corner	20	<u>/</u>
Nearest Building	10	<u>/</u>

If permits are granted I agree to conform to all ordinances and the laws of the State of North Carolina regulating such work and the specifications or plans submitted. I hereby swear that the foregoing statements are accurate and correct to the best of my knowledge.

Michael C. Coleman 5/19/05
Signature of Owner or Owner's Agent

05/19/05
Date

This application expires 6 months from the initial date if no permits have been issued

A RECORDED SURVEY PLAT AND RECORDED DEED ARE REQUIRED WHEN APPLYING FOR A LAND USE APPLICATION

5/19 S 06/04

SITE PLAN APPROVAL

DISTRICT RA30 USE DW4H

#BEDROOMS 5

05/19/05 A. Driggers
Date Zoning Administrator

05/19/05 Michael C. Coleman

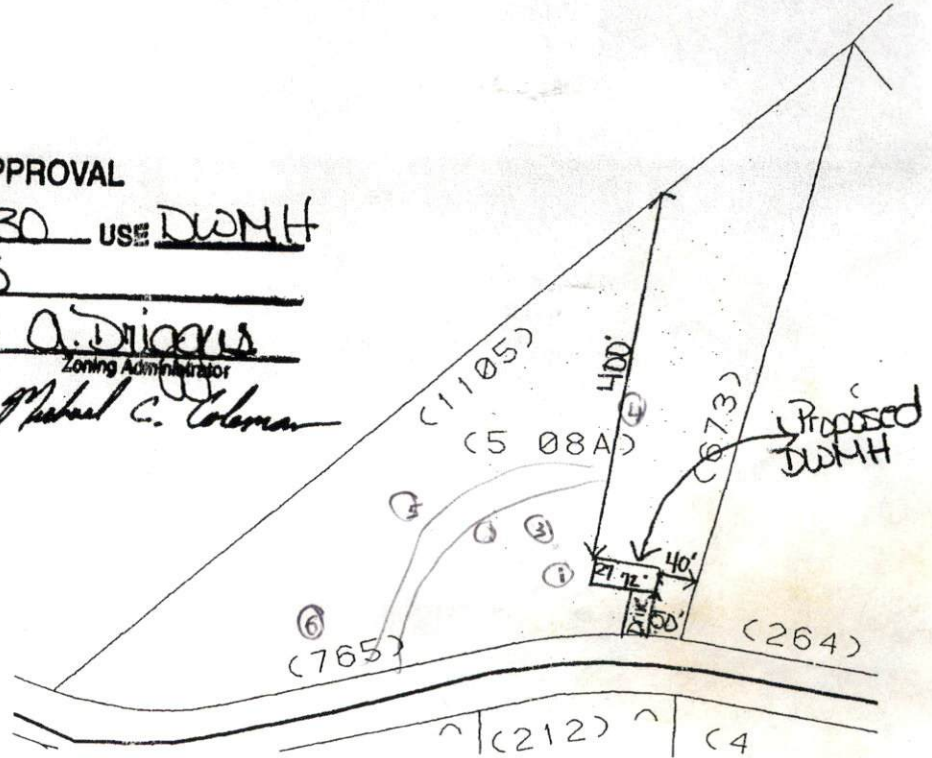

0631-36-5367

Scale: 1" = 200 ft

May 19, 2005

Harnett County Planning Department

PO Box 65, Lillington, NC 27546

910-893-7527

X

Environmental Health New Septic Systems Test

Environmental Health Code 800

- Place "property flags" in each corner of lot. All property lines must be clearly flagged approximately every 50 feet between corners.
- Place "house corner flags" at each corner of where the house/manufactured home will sit. Use additional flagging to outline driveways, garages, decks, out buildings, swimming pools, etc.
- Place flags at locations as developed on site plan by Customer Service Technician and you.
- Place Environmental Health "orange" card in location that is easily viewed from road.
- If property is thickly wooded, Environmental Health requires that you clean out the undergrowth to allow the soil evaluation to be performed. Inspectors should be able to walk freely around site. *No grading of property should be done.*
- After preparing proposed site call the voice permitting system at 910-893-7527 and give code 800 for Environmental Health confirmation.
- To hear results, call IVR again. Once approved, proceed to Central Permitting for permits

Environmental Health Existing Tank Inspections

Environmental Health Code 800

- Place Environmental Health "orange" card in location that is easily viewed from road.
- Prepare for inspection by removing soil over door as diagram indicates. Loosen trap door cover.
- After preparing trapdoor call the voice permitting system at 910-893-7527 and give code 800 for Environmental Health confirmation.
- To hear results, call IVR again. Once approved, proceed to Central Permitting for permits

Health and Sanitation Inspections

Health and Sanitation Plan Review 826

- After submitting plans fro food and lodging, call the voice permitting system at 910-893-7527 and give code 826.
- To hear results, call IVR again. Once approved, proceed to Central Permitting for permits

Fire Marshal Inspections

Fire Marshall Plan Review Code 804

- Call the voice permitting system at 910-893-7527 and give code 804 for plan review.
- Pick up Fire Marshal's letter and place on job site until work is completed.
- To hear results, call IVR again. Once approved, proceed to Central Permitting for permits

Public Utilities

- Place stake with "orange" tape/name thirty feet (30) from the center of the road at the location you wish to have water tap installed.
- Allow four to six weeks after application for water/sewer taps. Call Utilities at 893-7575 for technical assistance.

Planning

Planning Plan Review Code 806

- To hear results, call IVR again. Once the plans are approved, proceed to Central Permitting for permits

P

Building Inspections

~~Building Plan Review Code 802~~

to schedule inspections

- Call the voice permitting system at 910-893-7527 and give code 802 for building plan review.
- For new housing/set up permits ensure you meet E 911 / Addressing prior to calling for final inspection.
- To hear results, call IVR again. ~~Once the plans are approved, proceed to Central Permitting for permits~~

P

E911 Addressing

- Address numbers shall be mounted on the house, 3 inches high (5" for commercial).
- Numbers must be a contrasting color from house, must be clearly visible night and day at entrance of driveway if home is 100 ft or more from road, or if mailbox is on opposite side of road.
- Once you purchase permits and footing inspection has been approved call the voice permitting system at 910-893-7527 for address confirmation.
- To hear results, call IVR again.

Applicant Signature: Michael [Signature] Date: 5/19/05