

Initial Application Date: 3-22-05

Env. Rec'd 3/24/05

Application # 0550011725
878303

COUNTY OF HARNETT LAND USE APPLICATION

Central Permitting 102 E. Front Street, Lillington, NC 27546 Phone: (910) 893-4759 Fax: (910) 893-2793

LANDOWNER: Cary Construction Co. Mailing Address: PO Box 4302

City: Cary State: NC Zip: 27519 Phone #: 919-

APPLICANT: COLIN WATSON - CHOO CHOO HOMES Mailing Address: 4209 BRACC BLVD

City: FARETTVILLE State: NC Zip: 28307 Phone #: 910 860 8787

PROPERTY LOCATION: SR #: 1510 SR Name: MATTHEWS MILL POND RD TO CAROLINA DRIVE

Address: LOT # 7 78 CAROLINA DRIVE ANGIER N.C. 27501

Parcel: 040673015107 PIN: 0672-05-7046.000

Zoning: R430 Subdivision: CAROLINA ESTATES Lot #: 7 Lot Size: .47

Flood Plain: X Panel: 50 Watershed: n/a Deed Book/Page: OTP Plat Book/Page: PCD/38-B

DIRECTIONS TO THE PROPERTY FROM LILLINGTON: FROM STATE 401/215 TAKE 210 N FOR 6.7 MILES TURN RIGHT ON MATTHEWS MILL POND RD GO FOR 2.3 MILES T/R ON CAROLINA DRIVE PROCEED FOR ABOUT 120 YARDS TO 4TH LOT ON RIGHT

PROPOSED USE:

Sg. Family Dwelling (Size 28 x 48) # of Bedrooms 3 # Baths 2 Basement (w/wo bath) - Garage - Deck -

Multi-Family Dwelling No. Units _____ No. Bedrooms/Unit _____

Manufactured Home (Size 28 x 48) # of Bedrooms 3 Garage no Deck no

Number of persons per household 2

Business Sq. Ft. Retail Space _____ Type _____

Industry Sq. Ft. _____ Type _____

Church Seating Capacity _____ Kitchen _____

Home Occupation (Size x) # Rooms _____ Use _____

Additional Information: _____

Accessory Building (Size x) Use _____

Addition to Existing Building (Size x) Use _____

Other _____

Additional Information: _____

Water Supply: County Well (No. dwellings _____) Other _____

Sewage Supply: New Septic Tank Existing Septic Tank County Sewer Other _____

Erosion & Sedimentation Control Plan Required? YES NO

Property owner of this tract of land own land that contains a manufactured home w/in five hundred feet (500') of tract listed above? YES NO

Structures on this tract of land: Single family dwellings _____ Manufactured homes 1000 sq ft Other (specify) _____

Required Residential Property Line Setbacks:	Minimum	Actual
Front	<u>35</u>	<u>60</u>
Rear	<u>25</u>	<u>99-100</u>
Side	<u>10</u>	<u>30</u>
Corner	<u>20</u>	<u>75</u>
Nearest Building	<u>10</u>	<u>60</u>

If permits are granted I agree to conform to all ordinances and the laws of the State of North Carolina regulating such work and the specifications or plans submitted. I hereby swear that the foregoing statements are accurate and correct to the best of my knowledge.

[Signature]
Signature of Owner or Owner's Agent

3-23-05
Date

This application expires 6 months from the initial date if no permits have been issued

A RECORDED SURVEY PLAT AND RECORDED DEED ARE REQUIRED WHEN APPLYING FOR A LAND USE APPLICATION

3/23 N

SITE PLAN APPROVAL

DISTRICT RA30 USE DWMMH

#BEDROOMS 3

3/23/05 PJR

Date Zoning Administrator

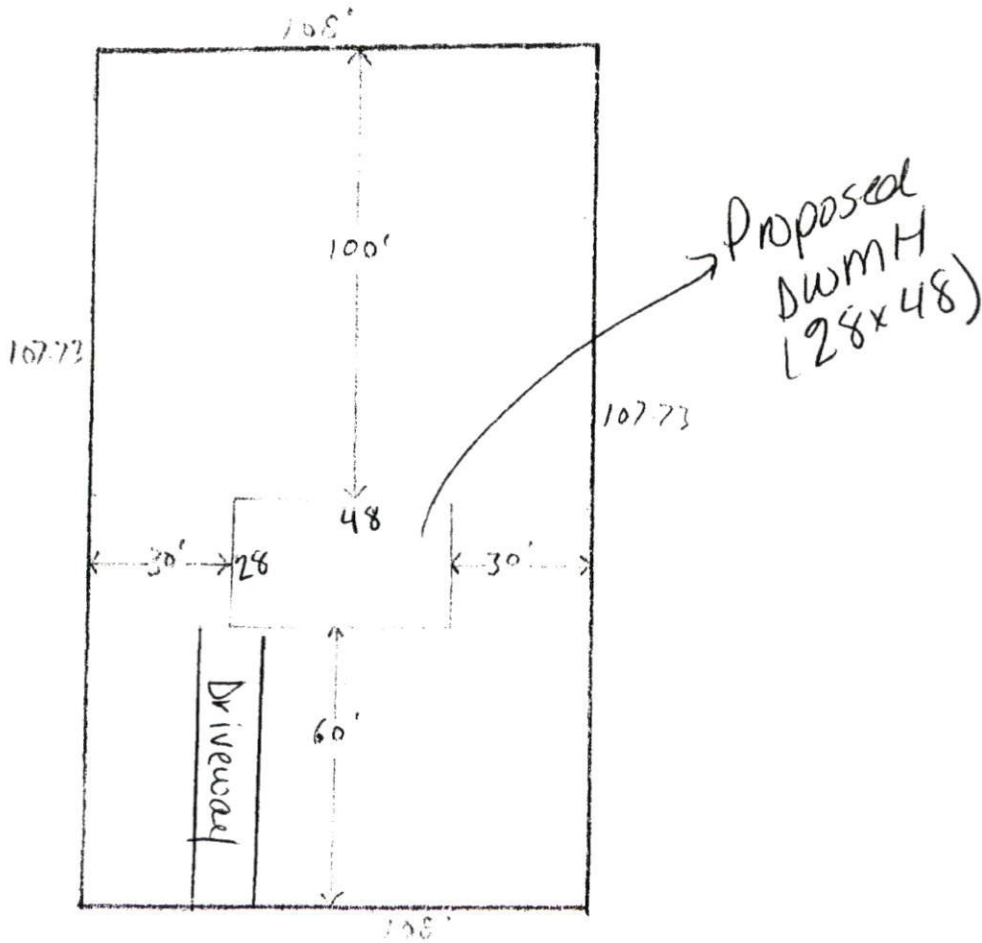

78 CAROLINA DRIVE

Harnett County Planning Department

PO Box 65, Lillington, NC 27546
910-893-7527

Environmental Health New Septic Systems Test
Environmental Health Code 800

- Place "property flags" in each corner of lot. All property lines must be clearly flagged approximately every 50 feet between corners.
- Place "house corner flags" at each corner of where the house/manufactured home will sit. Use additional flagging to outline driveways, garages, decks, out buildings, swimming pools, etc.
- Place flags at locations as developed on site plan by Customer Service Technician and you.
- Place Environmental Health "orange" card in location that is easily viewed from road.
- If property is thickly wooded, Environmental Health requires that you clean out the undergrowth to allow the soil evaluation to be performed. Inspectors should be able to walk freely around site. *No grading of property should be done.*
- After preparing proposed site call the voice permitting system at 910-893-7527 and give code 800 for Environmental Health confirmation.
- To hear results, call IVR again. Once approved, proceed to Central Permitting for permits

Environmental Health Existing Tank Inspections
Environmental Health Code 800

- Place Environmental Health "orange" card in location that is easily viewed from road.
- Prepare for inspection by removing soil over door as diagram indicates. Loosen trap door cover.
- After preparing trapdoor call the voice permitting system at 910-893-7527 and give code 800 for Environmental Health confirmation.
- To hear results, call IVR again. Once approved, proceed to Central Permitting for permits

Health and Sanitation Inspections
Health and Sanitation Plan Review 826

- After submitting plans fro food and lodging, call the voice permitting system at 910-893-7527 and give code 826.
- To hear results, call IVR again. Once approved, proceed to Central Permitting for permits

Fire Marshal Inspections
Fire Marshall Plan Review Code 804

- Call the voice permitting system at 910-893-7527 and give code 804 for plan review.
- Pick up Fire Marshal's letter and place on job site until work is completed.
- To hear results, call IVR again. Once approved, proceed to Central Permitting for permits

Public Utilities

- Place stake with "orange" tape/name thirty feet (30) from the center of the road at the location you wish to have water tap installed.
- Allow four to six weeks after application for water/sewer taps. Call Utilities at 893-7575 for technical assistance.

Planning
Planning Plan Review Code 806

- To hear results, call IVR again. Once the plans are approved, proceed to Central Permitting for permits

Building Inspections
Building Plan Review Code 802

- Call the voice permitting system at 910-893-7527 and give code 802 for building plan review.
- For new housing/set up permits ensure you meet E 911 / Addressing prior to calling for final inspection.
- To hear results, call IVR again. Once the plans are approved, proceed to Central Permitting for permits

E911 Addressing

- Address numbers shall be mounted on the house, 3 inches high (5" for commercial).
- Numbers must be a contrasting color from house, must be clearly visible night and day at entrance of driveway if home is 100 ft or more from road, or if mailbox is on opposite side of road.
- Once you purchase permits and footing inspection has been approved call the voice permitting system at 910-893-7527 for address confirmation.
- To hear results, call IVR again.

Applicant Signature: _____

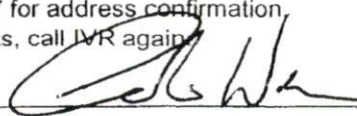

Date: _____

3-23-05