

# IMPROVEMENT PERMIT

20518

HTE 04-5-9434

Be it ordained by the Harnett County Board of Health as follows: Section III, Item B. "No Person shall begin construction of any building at which a septic tank system is to be used for disposal of sewage without first obtaining a written permit from the Harnett County Health Department."

Name: (owner) Deisy M. Stephens  New Installation  Septic Tank  
Property Location: SR# 27  Repairs  Nitrification Line

Subdivision \_\_\_\_\_ Lot # \_\_\_\_\_

Tax ID # \_\_\_\_\_ Quadrant # \_\_\_\_\_

Number of Bedrooms Proposed: 3 Lot Size: 5 Ac.

Basement with Plumbing:  Garage:

Water Supply:  Well  Public  Community

Distance From Well: 50 min. ft.

Following is the minimum specifications for sewage disposal system on above captioned property. Subject to final approval.

Type of system:  Conventional  Other \_\_\_\_\_

Size of tank: Septic Tank: 1000 gallons Pump Tank: \_\_\_\_\_ gallons

Subsurface Drainage Field No. of ditches 4 exact length of each ditch 100 ft. width of ditches 3 ft. depth of ditches 18-22 in.

French Drain Required: \_\_\_\_\_ Linear feet

Date: 5/27/2004

This permit is subject to revocation if site plans or intended use change.

Signed: [Signature]  
Environmental Health Specialist

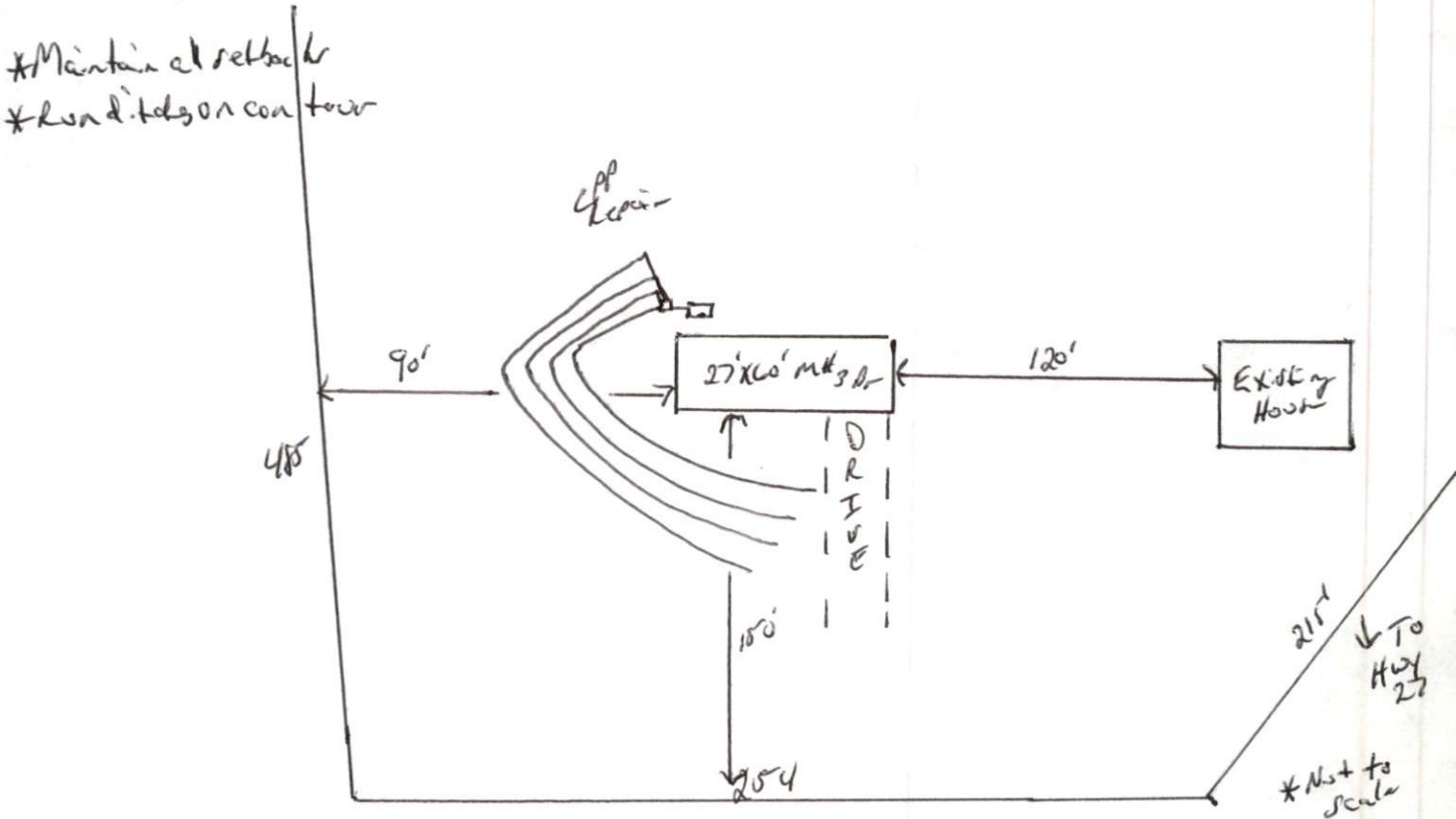

HARNETT COUNTY DEPARTMENT OF PUBLIC HEALTH  
AUTORIZATION TO CONSTRUCT

Authorization is hereby given to construct a wastewater system to the specifications described by Harnett County Department of Public Health, Improvement Permit # 20518. This authorization shall be valid for a period not to exceed five (5) years from the date of issuance. *This authorization will be invalid if ownership, site plans, or intended use change.*

Name Daisy M. Stephenson Telephone # 893 8801

Address 288 Dogwood Ln. C. Hinton NC 27546

Property Location SR# 27 Road Name \_\_\_\_\_

Subdivision \_\_\_\_\_ Lot # 3 # Bedrooms Proposed \_\_\_\_\_ Lot Size 5Ac

**TYPE OF SYSTEM**

New Installation  Repair  Septic Tank  Nitrification Lines

Conventional  Other \_\_\_\_\_

Basement  With Plumbing  Without Plumbing

Water Supply:  Well  Public Water Supply Minimum Well Setback: 50 Ft.

Septic Tank 1000 gal Pump Chamber \_\_\_\_\_ gal

**NITRIFICATION FIELD SPECIFICATIONS**

Number of fields 1 # of lines per field 4 Length of lines 100 Ft.

Width of ditches 3 ft. Depth of ditches 18-22 inches

French Drain: Linear feet required \_\_\_\_\_ Depth of gravel \_\_\_\_\_

No wastewater system shall be covered or placed into use by any person until an inspection by the Harnett County Health Department has determined that the system has been installed according to the conditions of the Improvement Permit and that a valid Operations Permit has been issued.

Signature of Authorized Agent for Harnett County Bryce McNeil

Date 5/27/2004