

**SOIL/SITE EVALUATION
for ON-SITE WASTEWATER SYSTEM**

Owner: Donald E Suggs

Applicant: Ronald Suggs

Address: Hwy 421

Date Evaluated: 11/19/03

Proposed Facility: 3 Odors

Design Flow (.1949): 360 gpd

Property Size: 12.34 Acres

Location of Site: 421 ~ 3 miles outside of Ellington, MD at Colonial

Property Recorded:

Water Supply: Public Individual Well

Pipeline
Let behind Spring Other

Evaluation Method: Auger Boring Pit

Substation Cut

Type of Wastewater: Sewage Industrial Process

Mixed

P R O F I L E #	1940 Landscape Position/ Slope%	Horizon Depth (IN.)	SOIL MORPHOLOGY .1941		OTHER PROFILE FACTORS				Profile Class & LTAR
			1941 Structure/ Texture	1941 Consistence Mineralogy	1942 Soil Wetness/ Color	1943 Soil Depth (IN.)	1956 Sapro Class	1944 Restr Horiz.	
1	30%	0-20	S4GR	SEXP, FR	10YR 5/6				RS
		20-26	SCL/SBK	SEXP	10YR 6/6				
		26-36	CL/SBK	SEXP	10YR 6/6				
		36-4	S1C/SBK	SEXP	10YR 6/6				
2		0-16	S1GR	SEXP, FR	10YR 5/6				US Reclassified RS
		16-20	SCL/SBK	SEXP	10YR 5/6				
		20-26	CL/SBK	SEXP	10YR 5/6				
		26-36	CL/SBK	SEXP	10YR 7/2 - 26"	26"	26"	-	
36-4	CL/SBK	EXP	10YR 5/6						
3		0-12	S4GR	SEXP, FR	10YR 5/6				RS
		12-42	SCL/SBK	SEXP	10YR 5/6				
		42-4	CL/SBK	SEXP	10YR 6/6				
4		0-18	S1S1/GR	SEXP, FR	10YR 6/6				US Reclassified RS
		18-32	SCL/SBK	SEXP	10YR 6/6				
		32-4	Saprolite		Parent Material	32"	32"	32"	

Description	Initial System	Repair System
Available Space (.1945)		
System Type(s)		
Site LTAR		

Other Factors (.1946): _____
 Site Classification (.1948): Unsuitable Reclassified
 Evaluated By: Melissa Teachey, RS
 Others Present: Joe West, RS / Heath Cain, RS

COMMENTS: _____

LANDSCAPE POSITIONS	GROUP	TEXTURES	.1955 LTAR	CONSISTENCE MOIST	WET
R-RIDGE	I	S-SAND	1.2 - 0.8	VFR-VERY FRIABLE	NS-NON-STICKY
S-SHOULDER SLOPE		LS-LOAMY SAND		FR-FRIABLE	SS-SLIGHTLY STICKY
L-LINEAR SLOPE	II	SL-SANDY LOAM	0.8 - 0.6	FI-FIRM	S-STICKY
FS-FOOT SLOPE		L-LOAM		VFI-VERY FIRM	VS-VERY STICKY
N-NOSE SLOPE	III	SI-SILT-	0.6 - 0.3	EFI-EXTREMELY FIRM	NP-NON-PLASTIC
H-HEAD SLOPE		SIL-SILT LOAM		SP-SLIGHTLY STICKY	
CC-CONCLAVE SLOPE		CL-CLAY LOAM		P-PLASTIC	
CV-CONVEX SLOPE		SCL-SANDY CLAY LOAM		VP-VERY PLASTIC	
T-TERRACE	IV	SIC-SILTY CLAY	0.4 - 0.1		
FP-FLOOD PLAN		C-CLAY			
		SC-SANDY CLAY			

STRUCTURE

- SG-SINGLE GRAIN
- M-MASSIVE
- CR-CRUMB
- GR-GRANULAR
- SBK-SUBANGULAR BLOCKY
- ABK-ANGULAR BLOCKY
- PL-PLATY
- PR-PRISMATIC

MINERALOGY

- SLIGHTLY EXPANSIVE
- EXPANSIVE

Show profile locations and other site features (dimensions, reference or benchmark, and North).

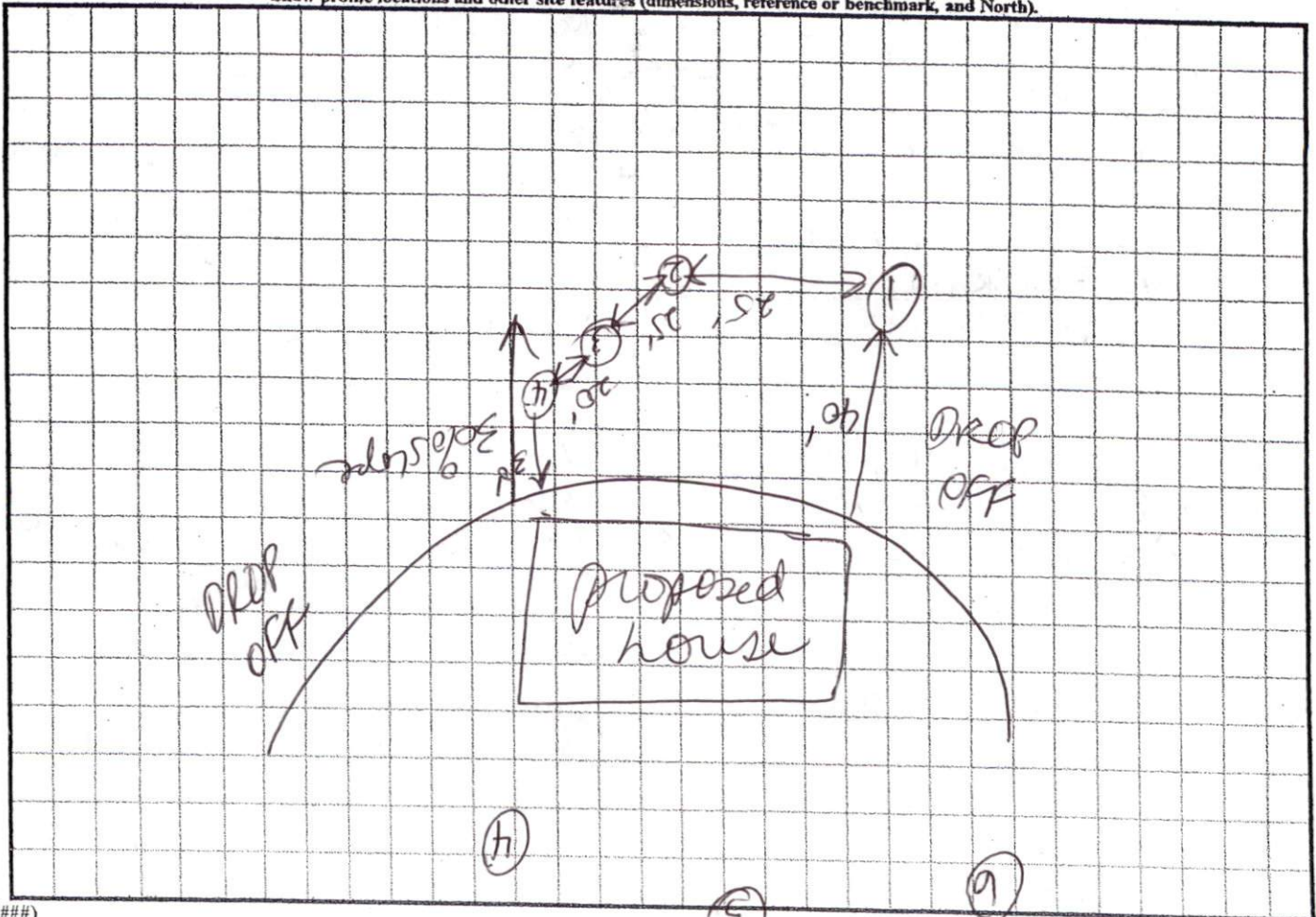

COMMENTS: _____

<u>LANDSCAPE POSITIONS</u>	<u>GROUP</u>	<u>TEXTURES</u>	<u>.1955 LTAR</u>	<u>CONSISTENCE MOIST</u>	<u>WET</u>
R-RIDGE	I	S-SAND	1.2 - 0.8	VFR-VERY FRIABLE	NS-NON-STICKY
S-SHOULDER SLOPE		LS-LOAMY SAND			
L-LINEAR SLOPE	II	SL-SANDY LOAM	0.8 - 0.6	FR-FRIABLE	SS-SLIGHTLY STICKY
FS-FOOT SLOPE		L-LOAM		FI-FIRM	S-STICKY
N-NOSE SLOPE				VFI-VERY FIRM	VS-VERY STICKY
H-HEAD SLOPE				EFI-EXTREMELY FIRM	NP-NON-PLASTIC
CC-CONCLAVE SLOPE	III	SI-SILT-	0.6 - 0.3		SP-SLIGHTLY STICKY
CV-CONVEX SLOPE		SIL-SILT LOAM			
T-TERRACE		CL-CLAY LOAM			
FP-FLOOD PLAN		SCL-SANDY CLAY LOAM			
	IV	SIC-SILTY CLAY	0.4 - 0.1		P-PLASTIC
		C-CLAY			
		SC-SANDY CLAY			

STRUCTURE
 SG-SINGLE GRAIN
 M-MASSIVE
 CR-CRUMB
 GR-GRANULAR
 SBK-SUBANGULAR BLOCKY
 ABK-ANGULAR BLOCKY
 PL-PLATY
 PR-PRISMATIC

MINERALOGY
 SLIGHTLY EXPANSIVE
 EXPANSIVE

Show profile locations and other site features (dimensions, reference or benchmark, and North).

