

01-5-3285

# IMPROVEMENT PERMIT

Be it ordained by the Harnett County Board of Health as follows: Section III, Item B. "No Person shall begin construction of any building at which a septic tank system is to be used for disposal of sewage without first obtaining a written permit from the Harnett County Health Department."

Name: (owner) Amy LEE O'KELLEY  New Installation  Septic Tank  
Property Location: SR# 421  Repairs  Nitrification Line

Subdivision \_\_\_\_\_ Lot # \_\_\_\_\_

Tax ID # \_\_\_\_\_ Quadrant # \_\_\_\_\_

Number of Bedrooms Proposed: 4 Lot Size: 2.96 AC

Basement with Plumbing:  Garage:

Water Supply:  Well  Public  Community

Distance From Well: 100 ft.

Following is the minimum specifications for sewage disposal system on above captioned property. Subject to final approval.

Type of system:  Conventional  Other \_\_\_\_\_

Size of tank: Septic Tank: 1000 gallons Pump Tank: \_\_\_\_\_ gallons

Subsurface Drainage Field No. of ditches 4 exact length of each ditch 80 ft. width of ditches 3 ft. depth of ditches 18 in.

French Drain Required: \_\_\_\_\_ Linear feet

Date: 11/21/01

**This permit is subject to revocation if site plans or intended use change.**

Signed: \_\_\_\_\_  
Environmental Health Specialist

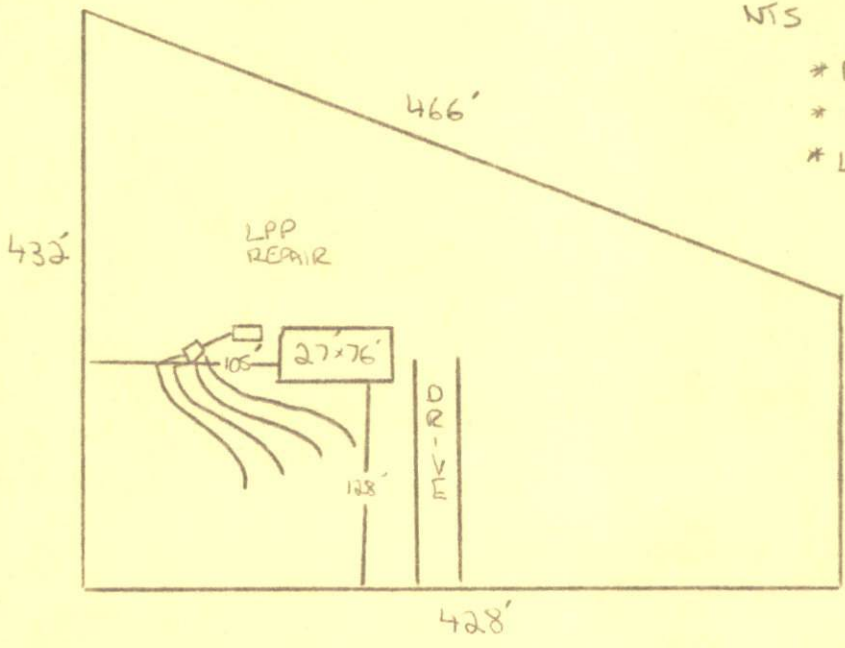

NTS

- \* MAINTAIN ALL SETBACKS
- \* RUN LINES ON CONTOUR
- \* LINES NOT LAYED OUT DUE TO VEGETATION. CALL PRIOR TO INSTALLATION IF ASSISTANCE IS REQUIRED TO LAY OUT LINES

HWY 421

