

**SOIL/SITE EVALUATION
 for ON-SITE WASTEWATER SYSTEM**

Owner: Applicant:
 Address: Date Evaluated:
 Proposed Facility: Design Flow (.1949): 360 SF
 Location of Site: Property Recorded: Property Size:
 Water Supply: Public Individual Well Spring Other
 Evaluation Method: Auger Boring Pit Cut
 Type of Wastewater: Sewage Industrial Process Mixed

P R O F I L E #	.1940 Landscape Position/ Slope %	Horizon Depth (In.)	SOIL MORPHOLOGY .1941		OTHER PROFILE FACTORS				Profile Class & LTAR
			.1941 Structure/ Texture	.1941 Consistence Mineralogy	.1942 Soil Wetness/ Color	.1943 Soil Depth (IN.)	.1956 Sapro Class	.1944 Restr Horiz	
1	LS 5-7	0-10	GS	VF2 NS/HP					
		10-15	SBKCL	F1 SS/HP					PS.2
2		0-18	GS	VF2 NS/HP					S.8
3		0-15	GS	VF2 NS/HP					
		15-29	SBK SCL	F2 SS/HP					
		29-42	SBK SCL	F1 SS/HP					PS.4
		BT e 42"							
4		0-18		VF2 NS/HP					S.8

Description	Initial System	Repair System	Other Factors (.1946): Site Classification (.1948): PS Evaluated By: CX Others Present: -
Available Space (.1945)			
System Type(s)	25' / 20'		
Site LTAR	4	2	

COMMENTS: _____

<u>LANDSCAPE POSITIONS</u>	<u>GROUP</u>	<u>TEXTURES</u>	<u>.1955 LTAR</u>	<u>CONSISTENCE MOIST</u>	<u>WET</u>
R-RIDGE	I	S-SAND	1.2 - 0.8	VFR-VERY FRIABLE FR-FRIABLE FI-FIRM VFI-VERY FIRM EFI-EXTREMELY FIRM	NS-NON-STICKY SS-SLIGHTLY STICKY S-STICKY VS-VERY STICKY NP-NON-PLASTIC SP-SLIGHTLY STICKY P-PLASTIC VP-VERY PLASTIC
S-SHOULDER SLOPE		LS-LOAMY SAND			
L-LINEAR SLOPE	II	SL-SANDY LOAM	0.8 - 0.6		
FS-FOOT SLOPE		L-LOAM			
N-NOSE SLOPE	III	SI-SILT	0.6 - 0.3		
H-HEAD SLOPE		SIL-SILT LOAM			
CC-CONCLAVE SLOPE		CL-CLAY LOAM			
CV-CONVEX SLOPE		SCL-SANDY CLAY LOAM			
T-TERRACE	IV	SIC-SILTY CLAY	0.4 - 0.1		
FP-FLOOD PLAN		C-CLAY			
		SC-SANDY CLAY			

STRUCTURE
 SG-SINGLE GRAIN
 M- MASSIVE
 CR-CRUMB
 GR-GRANULAR
 SBK-SUBANGULAR BLOCKY
 ABK-ANGULAR BLOCKY
 PL-PLATY
 PR-PRISMATIC

MINERALOGY
 SLIGHTLY EXPANSIVE
 EXPANSIVE

Show profile locations and other site features (dimensions, references or benchmark, and North)

A large grid for recording profile locations and site features. The grid consists of 20 columns and 20 rows of squares. The grid is intended for drawing or recording site features, dimensions, references, or benchmarks, and is oriented with North at the top.

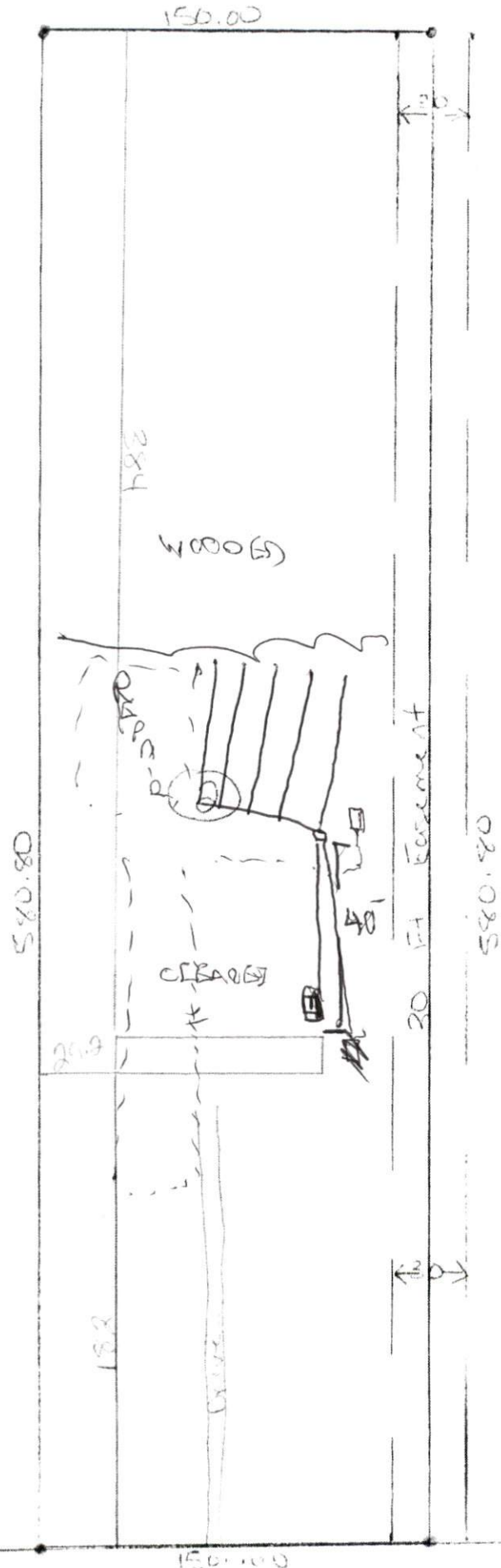

1=60

SITE PLAN APPROVAL

DISTRICT RA20M USE SwmH

#BEDROOMS 3

Date 10-21-14

[Signature]
Zoning Administrator

Bonnie Guerrero

(2)

(1)

SR# 1155 Block: Magnolia Rd