

HTE# 11-5-26877

# Harnett County Department of Public Health

PERMIT # 26610

## Operation Permit

22003

New Installation  Septic Tank  Nitrification Line  Repair  Expansion

PROPERTY LOCATION: McHean Chapel Church Rd

Name: (owner) Charles Bier SUBDIVISION Bethune Prop. LOT # 2

System Installer: Ottis Strickland Registration # \_\_\_\_\_

Basement with plumbing:  Garage  Number of Bedrooms 3

Type of Water Supply:  Community  Public  Well Distance from well 100 feet

System Type: III G Types V and VI Systems expire in 5 years.

(In accordance with Table V a) Owner must contact Health Department 6 months prior to expiration for permit renewal.

This system has been installed in compliance with applicable North Carolina General Statutes, Rules for Sewage Treatment and Disposal, and all conditions of the Improvement Permit and Construction Authorization.

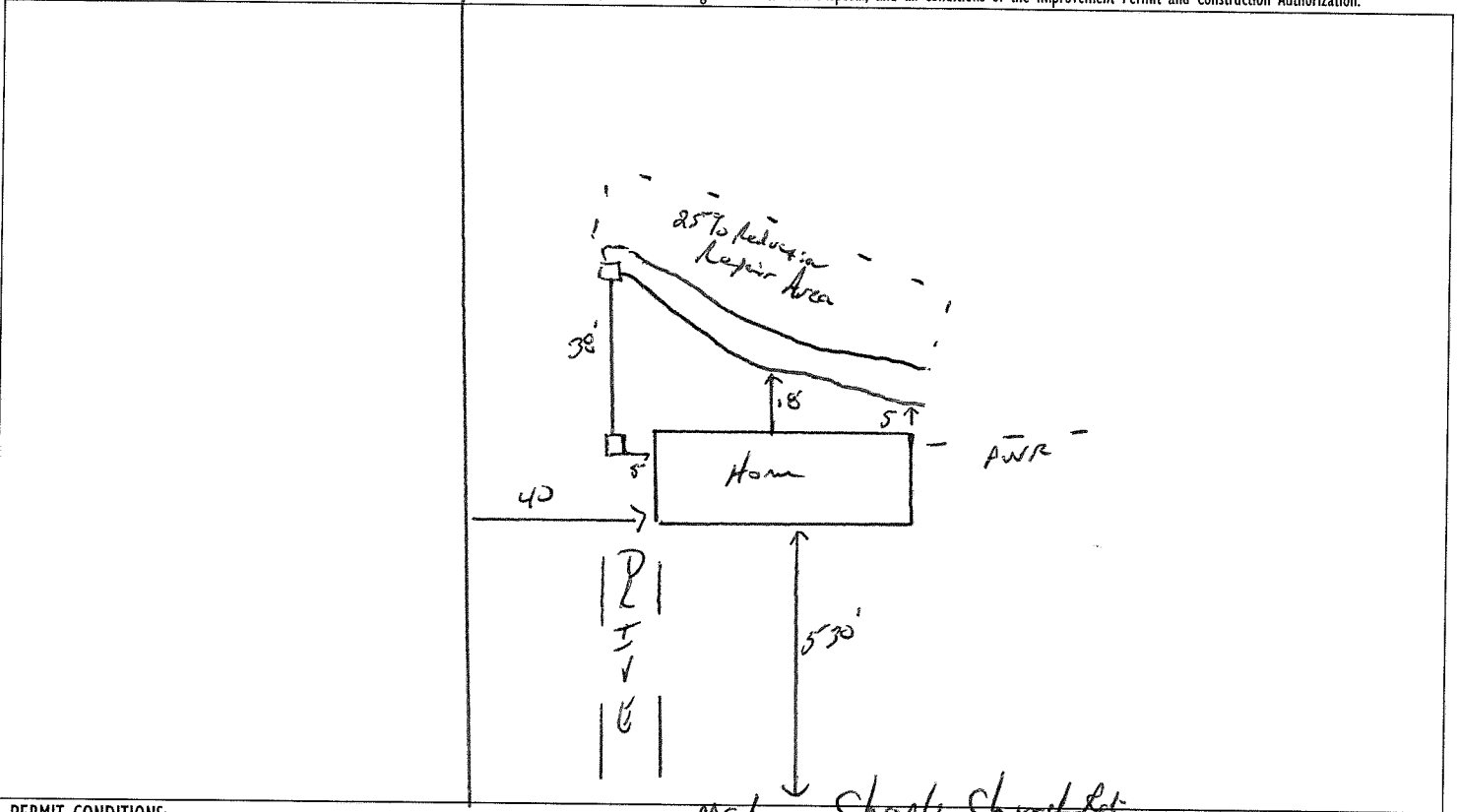

### PERMIT CONDITIONS:

- I. Performance: System shall perform in accordance with Rule .1961.
- II. Monitoring: As required by Rule .1961.
- III. Maintenance: As required by Rule .1961. Other: \_\_\_\_\_  
Subsurface system operator required? Yes  No   
If yes, see attached sheet for additional operation conditions, maintenance and reporting.
- IV. Operation: \_\_\_\_\_
- V. Other: \_\_\_\_\_

D-Box  Pump  Alarm  H2O Line  PWR Line

Following are the specifications for the sewage disposal system on the above captioned property.

Type of system:  Conventional  Other EZ Flow Septic Tank: 1000 gallons Pump Tank: \_\_\_\_\_ gallons  
 Subsurface Drainage Field No. of ditches 2 exact length of each ditch 90 feet width of ditches 3 feet depth of ditches 24 inches  
 French Drain Required: \_\_\_\_\_ Linear feet

Authorized State Agent Bryan McSwain, RPH Date 6/28/2011