

HTE# 10-5-24511R

Harnett County Department of Public Health

26126

Improvement Permit

A building permit cannot be issued with only an Improvement Permit

ISSUED TO: PINE GROVE DEV. CORP PROPERTY LOCATION: HWY 24
 NEW REPAIR EXPANSION SUBDIVISION: NATURES CROSSROADS LOT # 60
 Type of Structure: MAN. HOME (30'x76') Site Improvements required prior to Construction Authorization Issuance:
 Proposed Wastewater System Type: 25% REDUCTION SYSTEM
 Projected Daily Flow: 480 GPD
 Number of bedrooms: 4 Number of Occupants: 8 max
 Basement Yes No
 Pump Required: Yes No May be required based on final location and elevations of facilities
 Type of Water Supply: Community Public Well Distance from well 100 feet Permit valid for: Five years
 Permit conditions: No expiration

Authorized State Agent: [Signature] REAS Date: 6/11/10 SEE ATTACHED SITE SKETCH
 The issuance of this permit by the Health Department in no way guarantees the issuance of other permits. The permit holder is responsible for checking with appropriate governing bodies in meeting their requirements. This site is subject to revocation if the site plan, plat, or the intended use changes. The Improvement Permit shall not be affected by a change in ownership of the site. This permit is subject to compliance with the provisions of the Laws and Rules for Sewage Treatment and Disposal and to conditions of this permit.

Construction Authorization

(Required for Building Permit)

The construction and installation requirements of Rules .1950, .1952, .1954, .1955, .1956, .1957, .1958, and .1959 are incorporated by references into this permit and shall be met. Systems shall be installed in accordance with the attached system layout.

ISSUED TO: PINE GROVE DEV. CORP PROPERTY LOCATION: HWY 24
 SUBDIVISION: NATURES CROSSROADS LOT # 60
 Facility Type: MAN. HOME (30'x76') New Expansion Repair
 Basement? Yes No Basement Fixtures? Yes No
 Type of Wastewater System** 25% REDUCTION SYSTEM (Initial) Wastewater Flow: 480 GPD
 (See note below, if applicable 25% REDUCTION SYSTEM (Repair))

Installation Requirements/Conditions
 Septic Tank Size 1000 gallons Number of trenches 1
 Pump Tank Size _____ gallons Exact length of each trench 400 feet Trench Spacing: 9 Feet on Center
 Trenches shall be installed on contour at a Soil Cover: 6 inches
 Maximum Trench Depth of: 18 inches (Maximum soil cover shall not exceed 36" above the trench bottom)
 (Trench bottoms shall be level to +/-1/4" in all directions)
 Pump Requirements: _____ ft. TDH vs. _____ GPM _____ inches below pipe
 Aggregate Depth: _____ inches above pipe
 Conditions: WATER LINE MUST BE 10' FROM SEPTIC SYSTEM. NO UTILITIES MAY ENCRACH ON INITIAL OR REPAIR AREAS.

**If applicable: I understand the system type specified is different from the type specified on the application. I accept the specifications of this permit.
 Owner/Legal Representative Signature: _____ Date: _____

This Construction Authorization is subject to revocation if the site plan, plat, or the intended use changes. The Construction Authorization shall not be transferred when there is a change in ownership of the site. This Construction Authorization is subject to compliance with the provisions of the Laws and Rules for Sewage Treatment and Disposal and to the conditions of this permit. SEE ATTACHED SITE SKETCH

Authorized State Agent: [Signature] REAS Date: 6/11/10 & 6/28/10 OT
 Construction Authorization Expiration Date: 6/11/15

HTE# 10-5-24511R

Permit # 26126

Harnett County Department of Public Health Site Sketch

ISSUED TO: PINE GROVE DEV. CORP PROPERTY LOCATOR: Hwy 24
SUBDIVISION NATURES CROSSROADS LOT # 60

Authorized State Agent: [Signature] RENS (OLIVER TOLKSOOD) Date: 6/11/10

DRAWING
NTS

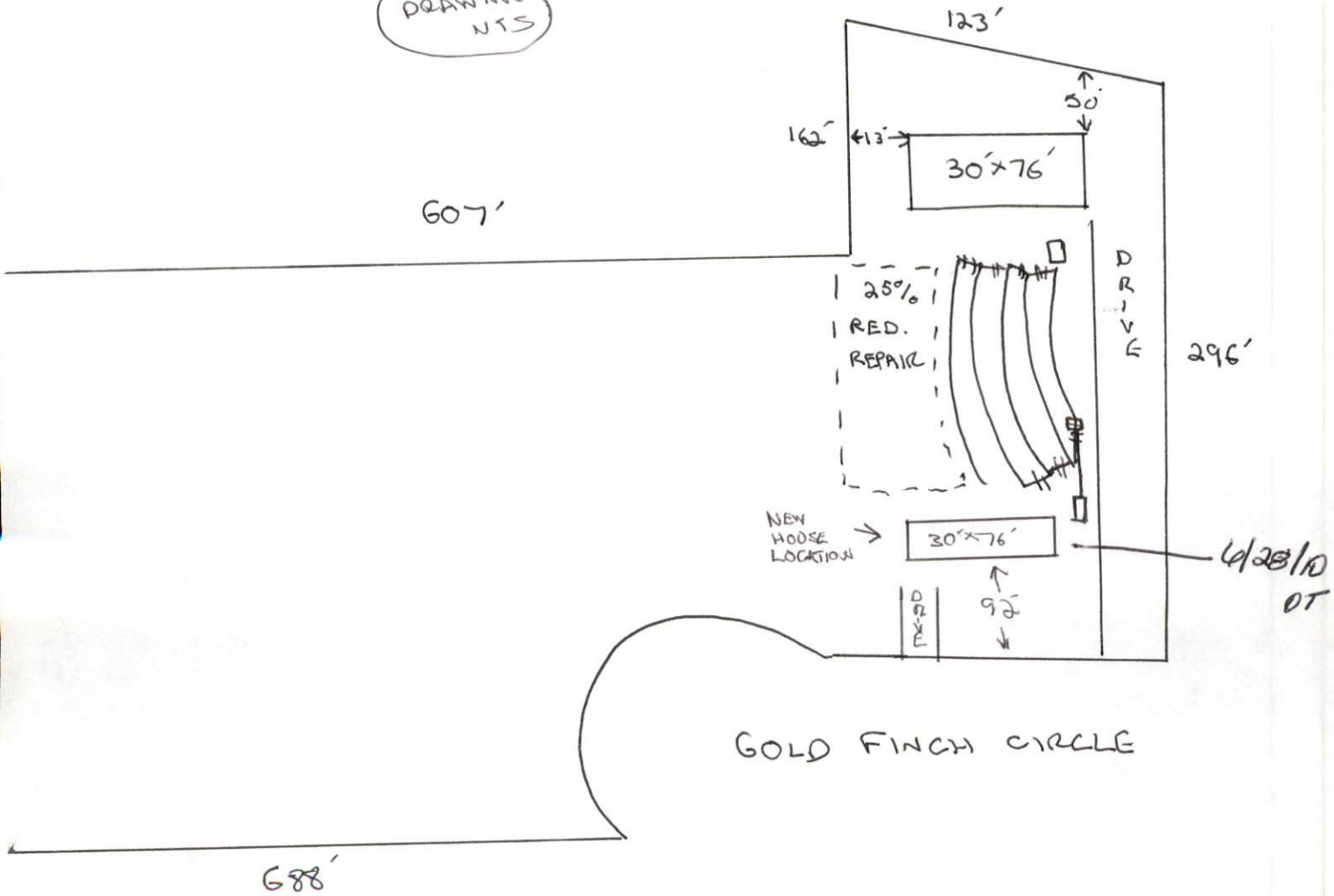

*CALL W/ QUESTIONS
PRIOR TO INSTALLATION