

HTE# 09-500-21424

Hitt County Department of Public Health

20637

PERMIT # 25224

Operation Permit

New Installation Septic Tank Repair Nitrification Line Expansion

PROPERTY LOCATION: NC24

Name: (owner) Pine Grove Dev Corp SUBDIVISION NATURAL CROSS RD LOT # 27

System Installer: Ted Brown Registration # _____

Basement with plumbing: Garage Number of Bedrooms 4

Type of Water Supply: Community Public Well Distance from well 100 feet

System Type: Duck 4 #8 Types V and VI Systems expire in 5 years.

(In accordance with Table V a)

Owner must contact Health Department 6 months prior to expiration for permit renewal.

This system has been installed in compliance with applicable North Carolina General Statutes, Rules for Sewage Treatment and Disposal, and all conditions of the Improvement Permit and Construction Authorization.

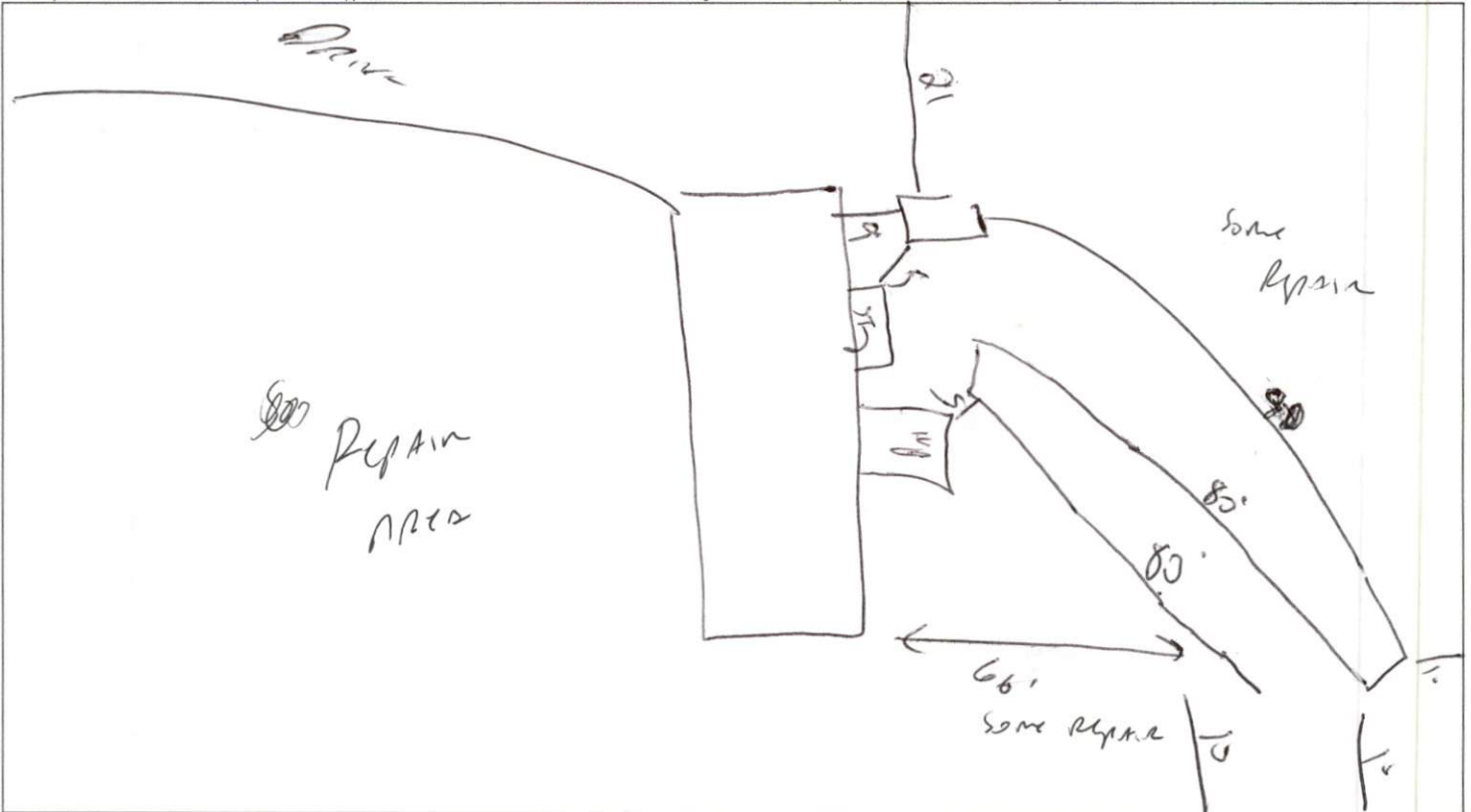

PERMIT CONDITIONS:

- I. Performance: System shall perform in accordance with Rule .1961.
- II. Monitoring: As required by Rule .1961.
- III. Maintenance: As required by Rule .1961. Other: _____
Subsurface system operator required? Yes No
If yes, see attached sheet for additional operation conditions, maintenance and reporting.
- IV. Operation: _____
- V. Other: _____

Following are the specifications for the sewage disposal system on the above captioned property.

Type of system: Conventional Other Duck 4
 Subsurface No. of 1 exact length of each ditch 240 feet
 Drainage Field ditches 1 of each ditch 240 feet
 Septic Tank: 1000 gallons Pump Tank: _____ gallons
 width of ditches 3 feet depth of ditches 18.25 inches
 French Drain Required: _____ Linear feet

Authorized State Agent [Signature] Date 03-24-09