

HTE# 08-500-2139

Harnett County Department of Public Health

25096

Improvement Permit

A building permit cannot be issued with only an Improvement Permit

ISSUED TO: Choo Choo Home (coln water) PROPERTY LOCATION: Tom Myers Rd SUBDIVISION Prof. Med Rec LOT # 4F-B

NEW [X] REPAIR [] EXPANSION [] Type of Structure: MH-24x52-3BR Proposed Wastewater System Type: GRAVEL Projected Daily Flow: 360 GPD Number of bedrooms: 3 Number of Occupants: 6 max Basement [] Yes [X] No

Site Improvements required prior to Construction Authorization Issuance: 1AC

Pump Required: [] Yes [] No [X] May be required based on final location and elevations of facilities Type of Water Supply: [] Community [X] Public [] Well Distance from well 100 feet Permit valid for: [X] Five years [] No expiration

Permit conditions: Meet on site for final layout maintain all at bark, STUB out plumbing shallow, at ground level or higher where shown

Authorized State Agent: J. Waters Date: 10-29-08 SEE ATTACHED SITE SKETCH

The issuance of this permit by the Health Department in no way guarantees the issuance of other permits. The permit holder is responsible for checking with appropriate governing bodies in meeting their requirements. This site is subject to revocation if the site plan, plat, or the intended use changes. The Improvement Permit shall not be affected by a change in ownership of the site. This permit is subject to compliance with the provisions of the Laws and Rules for Sewage Treatment and Disposal and to conditions of this permit.

Construction Authorization

(Required for Building Permit)

The construction and installation requirements of Rules .1950, .1952, .1954, .1955, .1956, .1957, .1958, and .1959 are incorporated by references into this permit and shall be met. Systems shall be installed in accordance with the attached system layout.

ISSUED TO: Choo Choo Home (coln water) PROPERTY LOCATION: Tom Myers Rd SUBDIVISION Prof Med Rec LOT # 4F-B

Facility Type: MH-24x52-3BR [X] New [] Expansion [] Repair Basement? [] Yes [X] No Basement Fixtures? [] Yes [X] No Type of Wastewater System** GRAVEL (Initial) Wastewater Flow: 360 GPD (See note below, if applicable [X]) GRAVEL (Repair)

Installation Requirements/Conditions Number of trenches 1 Septic Tank Size 1000 gallons Exact length of each trench 200 feet Trench Spacing: 9 Feet on Center Pump Tank Size gallons Trenches shall be installed on contour at a Soil Cover: 6 inches Maximum Trench Depth of: 18.24 inches (Maximum soil cover shall not exceed 36" above the trench bottom) (Trench bottoms shall be level to +/- 1/4" in all directions) Pump Requirements: ft. TDH vs. GPM Aggregate Depth: 6 inches below pipe 2 inches above pipe 12 inches total Conditions:

**If applicable: I understand the system type specified is different from the type specified on the application. I accept the specifications of this permit.

Owner/Legal Representative Signature: Date:

This Construction Authorization is subject to revocation if the site plan, plat, or the intended use changes. The Construction Authorization shall not be transferred when there is a change in ownership of the site. This Construction Authorization is subject to compliance with the provisions of the Laws and Rules for Sewage Treatment and Disposal and to the conditions of this permit. SEE ATTACHED SITE SKETCH

Authorized State Agent: J. Waters Date: 10-29-08 Construction Authorization Expiration Date: 10-29-08

HTE# 08-500-21139

Permit # 25096

Harnett County Department of Public Health Site Sketch

ISSUED TO: Chas Chas Homes - (Col. Watson) PROPERTY LOCATION: Tom Myers Rd
SUBDIVISION: Pr. F. Med. Rec. LOT # 45-B
1.5 ac

Authorized State Agent: J. L. LAKS Date: 10-29-28

Tom Myers Rd
98' ← TO SR 1116

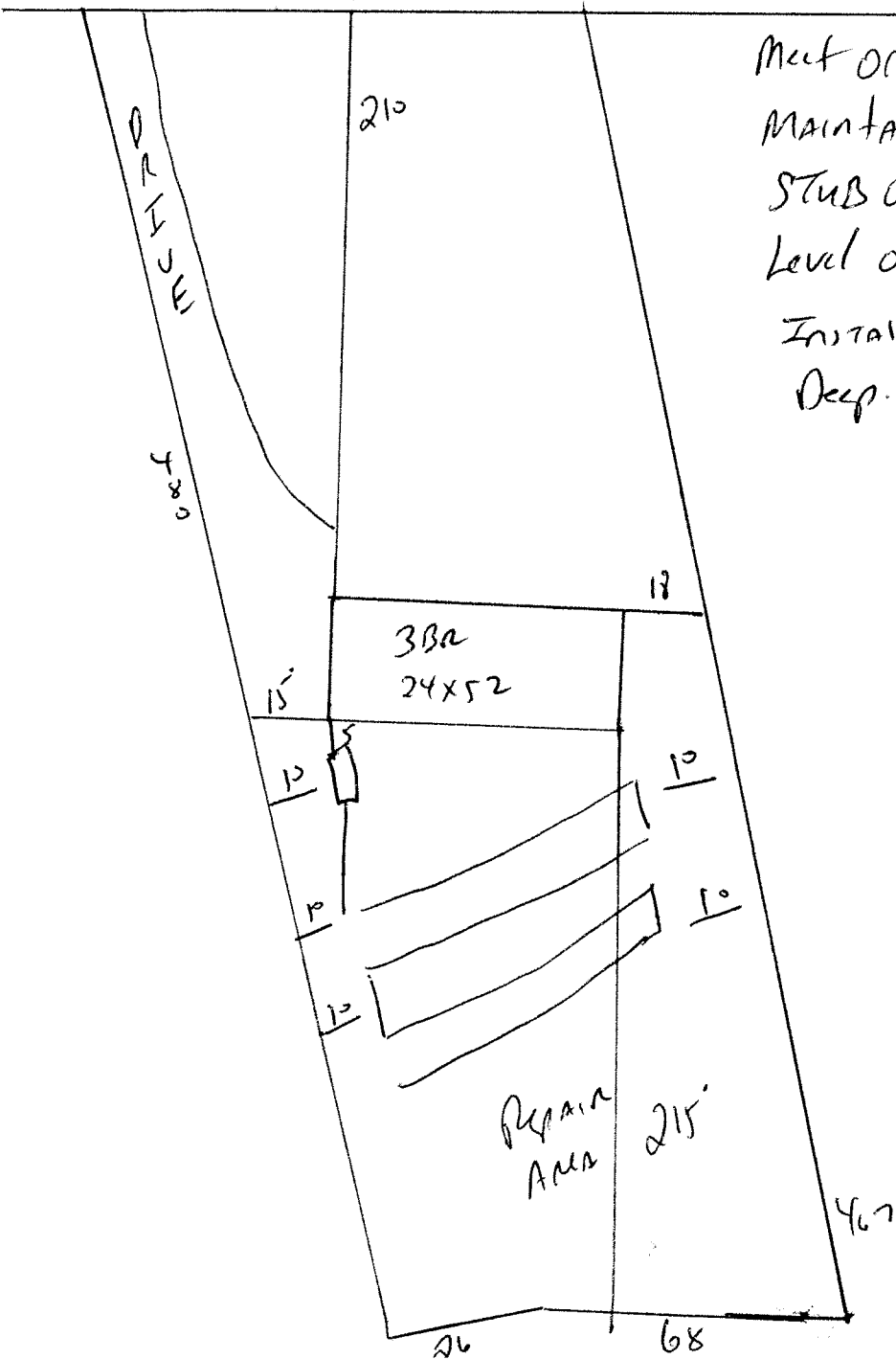

Meet onsite for Final Layout
 Maintain All setbacks
 Stub out Plumbing shallow at ground
 Level or higher where shown.
 Install 200' of gravel at 18 to 24"
 Deep.