

Improvement Permit

A building permit cannot be issued with only an Improvement Permit

ISSUED TO: Clayton Homes
PROPERTY LOCATION: Cox Mill Rd
SUBDIVISION: Kevin Spivey
LOT # 1
Type of Structure: DWMH-32x60 BBR
Proposed Wastewater System Type: Pump to 25% Reduction System
Projected Daily Flow: 360 GPD
Number of bedrooms: 3 Number of Occupants: 6 max
Basement: No

Pump Required: May be required based on final location and elevations of facilities
Type of Water Supply: Well
Distance from well: 75 feet
Permit valid for: Five years
Permit conditions: Meet onsite for final layout - maintain all set back
Meet with Spivey Engineering & Plumber so that we can determine if pump will be required
If tank can be placed 75' from well & maintain 18" O.D. depth then pump will not be required
Authorized State Agent: J. W. [Signature] Date: 10-27-08 SEE ATTACHED SITE SKETCH

The issuance of this permit by the Health Department in no way guarantees the issuance of other permits. The permit holder is responsible for checking with appropriate governing bodies in meeting their requirements. This site is subject to revocation if the site plan, plat, or the intended use changes. The Improvement Permit shall not be affected by a change in ownership of the site. This permit is subject to compliance with the provisions of the Laws and Rules for Sewage Treatment and Disposal and to conditions of this permit.

Construction Authorization

(Required for Building Permit)

The construction and installation requirements of Rules .1950, .1952, .1954, .1955, .1956, .1957, .1958, and .1959 are incorporated by references into this permit and shall be met. Systems shall be installed in accordance with the attached system layout.

ISSUED TO: Clayton Homes
PROPERTY LOCATION: Cox Mill Rd
SUBDIVISION: Kevin Spivey
LOT # 1
Facility Type: DWMH-32x60 BBR
Basement? No
Type of Wastewater System: Pump to 25% Reduction System
(See note below, if applicable) 25% Reduction System (Repair)

Installation Requirements/Conditions
Septic Tank Size: 1000 gallons
Pump Tank Size: 1000 gallons
Number of trenches: 1
Exact length of each trench: 300 feet
Trench Spacing: 9 Feet on Center
Soil Cover: 6 inches
Maximum Trench Depth: 18 inches
Pump Requirements: ft. TDH vs. GPM
Aggregate Depth: inches below pipe, inches above pipe, inches total

**If applicable: I understand the system type specified is different from the type specified on the application. I accept the specifications of this permit.

Owner/Legal Representative Signature: Date:

This Construction Authorization is subject to revocation if the site plan, plat, or the intended use changes. The Construction Authorization shall not be transferred when there is a change in ownership of the site. This Construction Authorization is subject to compliance with the provisions of the Laws and Rules for Sewage Treatment and Disposal and to the conditions of this permit. SEE ATTACHED SITE SKETCH

Authorized State Agent: J. W. [Signature] Date: 10-27-08
Construction Authorization Expiration Date: 10-27-2013

HTE# 08-500-21039RR

Permit # 25093

Harnett County Department of Public Health Site Sketch

ISSUED TO: Clayton Homes

PROPERTY LOCATION: Cox Mill Rd

SUBDIVISION: Kevin Spivey

LOT # 1

Authorized State Agent: *[Signature]*

Date: 10-27-08

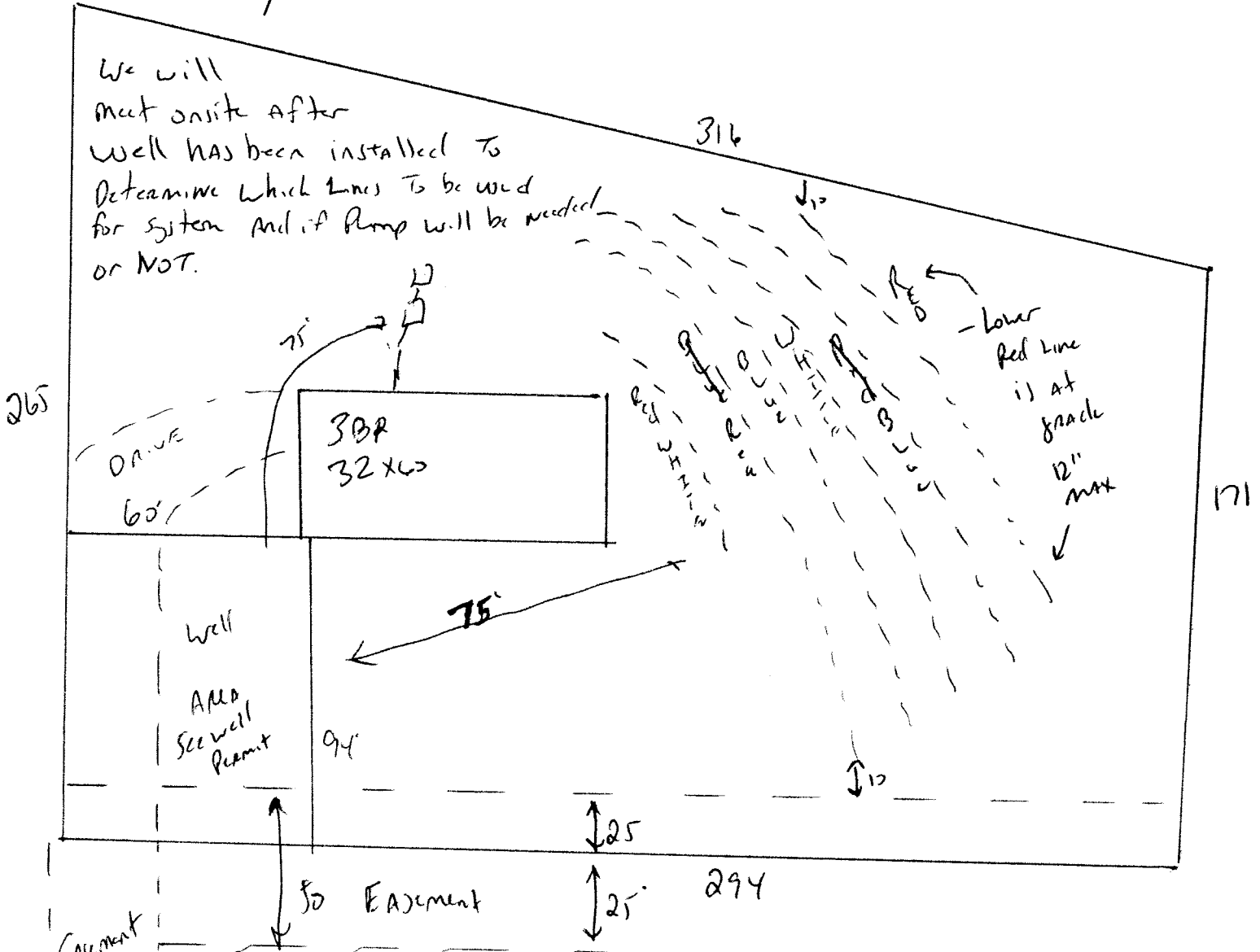

Easement
To
Cox Mill
Rd
↓

NOTE All parts of septic system must be 75' from the well. Final well location will determine final septic location and if pump will be required or not. Must meet after well is in to determine final layout of septic system - Install 300' of 25% Reduction System at 18" max Ditch Depth. DO NOT Drive or park on any part of septic system. For well details please see well permit.