

HTE# 08-520655

Harnett County Department of Public Health

20345

PERMIT # 24942

Operation Permit

New Installation Septic Tank Repair Nitrification Line Expansion

PROPERTY LOCATION: Hwy 210

Name: (owner) KENNETH MOSS SUBDIVISION _____ LOT # _____

System Installer: LONNIE JOHNSON Registration # _____

Basement with plumbing: Garage Number of Bedrooms 3
Type of Water Supply: Community Public Well Distance from well 100 feet

System Type: IIIg Types V and VI Systems expire in 5 years.

(In accordance with Table V a) Owner must contact Health Department 6 months prior to expiration for permit renewal.

This system has been installed in compliance with applicable North Carolina General Statutes, Rules for Sewage Treatment and Disposal, and all conditions of the Improvement Permit and Construction Authorization.

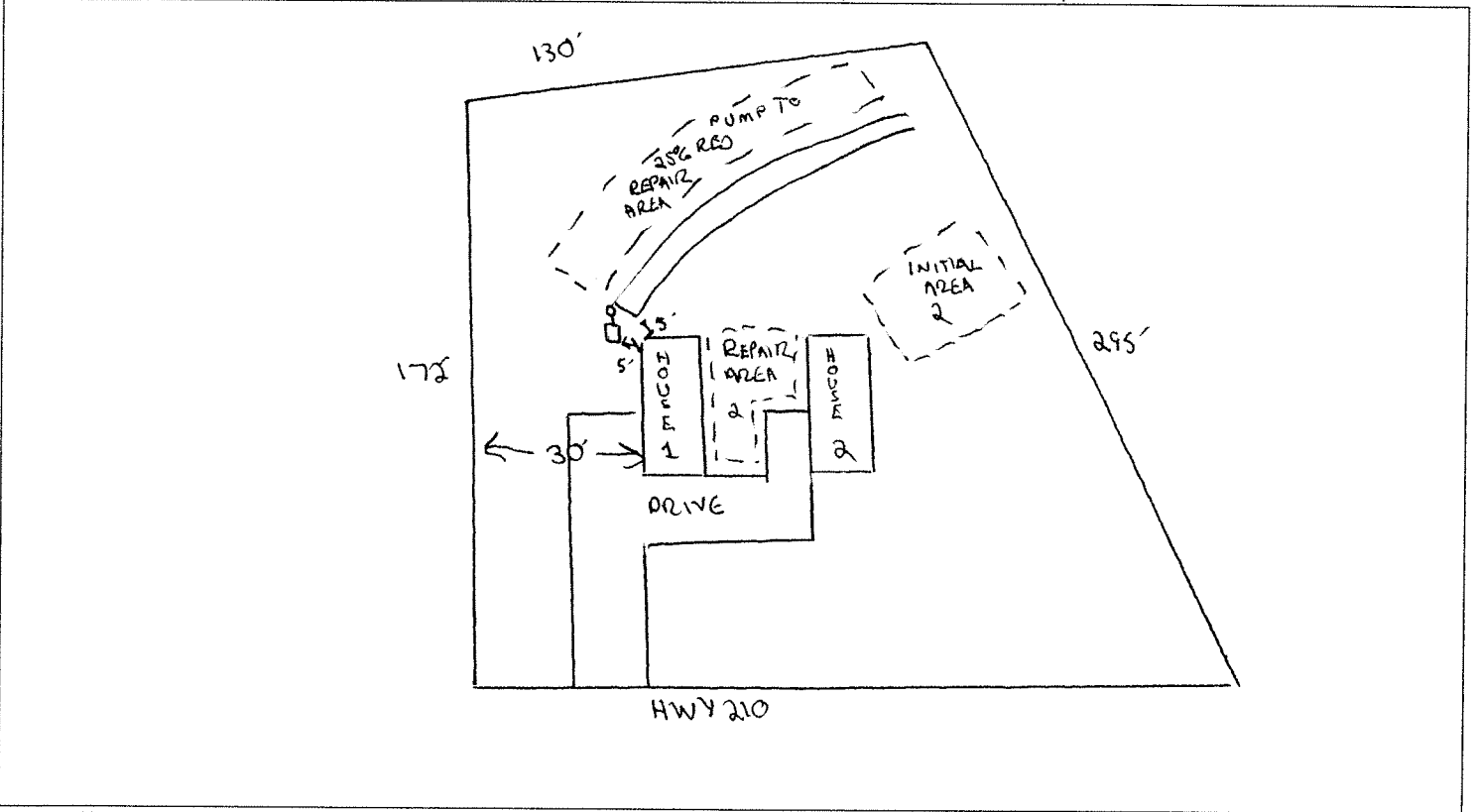

PERMIT CONDITIONS:

- I. Performance: System shall perform in accordance with Rule .1961.
- II. Monitoring: As required by Rule .1961.
- III. Maintenance: As required by Rule .1961. Other: _____
Subsurface system operator required? Yes No
If yes, see attached sheet for additional operation conditions, maintenance and reporting.
- IV. Operation: _____
- V. Other: _____

Following are the specifications for the sewage disposal system on the above captioned property.

Type of system: Conventional Other E2 Flow Septic Tank: 1000 ^{MCP-1000} gallons Pump Tank: _____ gallons
 Subsurface No. of exact length width of depth of
 Drainage Field ditches 2 of each ditch 100 feet ditches 3 feet ditches 24-30 inches
 French Drain Required: _____ Linear feet

Authorized State Agent _____

Date 11/3/08