

HTE# 07-50017785R

Harnett County Department of Public Health

24183

Improvement Permit

A building permit cannot be issued with only an Improvement Permit

ISSUED TO: Pine Grove Dev. Corp. PROPERTY LOCATION: NC24 SUBDIVISION: NATURE'S CROSSROADS LOT # 43
Type of Structure: MH 76x26-4BR
Proposed Wastewater System Type: Pump to 25% Red. system
Projected Daily Flow: 480 GPD
Number of bedrooms: 4 Number of Occupants: 8 max
Basement: No
Pump Required: Yes
Type of Water Supply: Public
Permit conditions: STD out plumbing shallow where shown maintain All set Backs

Authorized State Agent: [Signature] Date: 07-13-07 SEE ATTACHED SITE SKETCH
The issuance of this permit by the Health Department in no way guarantees the issuance of other permits. The permit holder is responsible for checking with appropriate governing bodies in meeting their requirements. This site is subject to revocation if the site plan, plat, or the intended use changes. The Improvement Permit shall not be affected by a change in ownership of the site. This permit is subject to compliance with the provisions of the Laws and Rules for Sewage Treatment and Disposal and to conditions of this permit.

Construction Authorization

(Required for Building Permit)

The construction and installation requirements of Rules .1950, .1952, .1954, .1955, .1956, .1957, .1958, and .1959 are incorporated by references into this permit and shall be met. Systems shall be installed in accordance with the attached system layout.

ISSUED TO: Pine Grove Dev. PROPERTY LOCATION: NC24 SUBDIVISION: NATURE'S CROSSROADS LOT # 43
Facility Type: MH 76x26-4BR New
Basement? No
Type of Wastewater System: Pump to 25% Red. system (Initial)
Wastewater Flow: 480 GPD
(See note below, if applicable) 480 LFS LPP (Repair)

Installation Requirements/Conditions

Septic Tank Size: 1000 gallons
Pump Tank Size: 1000 gallons
Exact length of each trench: 1x300 feet
Trenches shall be installed on contour at a Maximum Trench Depth of: 18 inches
Trench Spacing: 9 Feet on Center
Soil Cover: 6 inches
(Pump Requirements: ft. TDH vs. GPM)
Aggregate Depth: inches below pipe, inches above pipe, inches total

**If applicable: I understand the system type specified is different from the type specified on the application. I accept the specifications of this permit.

Owner/Legal Representative Signature: Date:

This Construction Authorization is subject to revocation if the site plan, plat, or the intended use changes. The Construction Authorization shall not be transferred when there is a change in ownership of the site. This Construction Authorization is subject to compliance with the provisions of the Laws and Rules for Sewage Treatment and Disposal and to the conditions of this permit.

Authorized State Agent: [Signature] Date: 07-13-07 SEE ATTACHED SITE SKETCH
Construction Authorization Expiration Date: 07-17-2012

HTE# 07-50017785R

Permit # 24183

Harnett County Department of Public Health Site Sketch

ISSUED TO: Pine Grove Dev.

PROPERTY LOCATOR: NC 24
SUBDIVISION: NATURE CROSS RD LOT # 43

Authorized State Agent: [Signature]

Date: 07-13-07

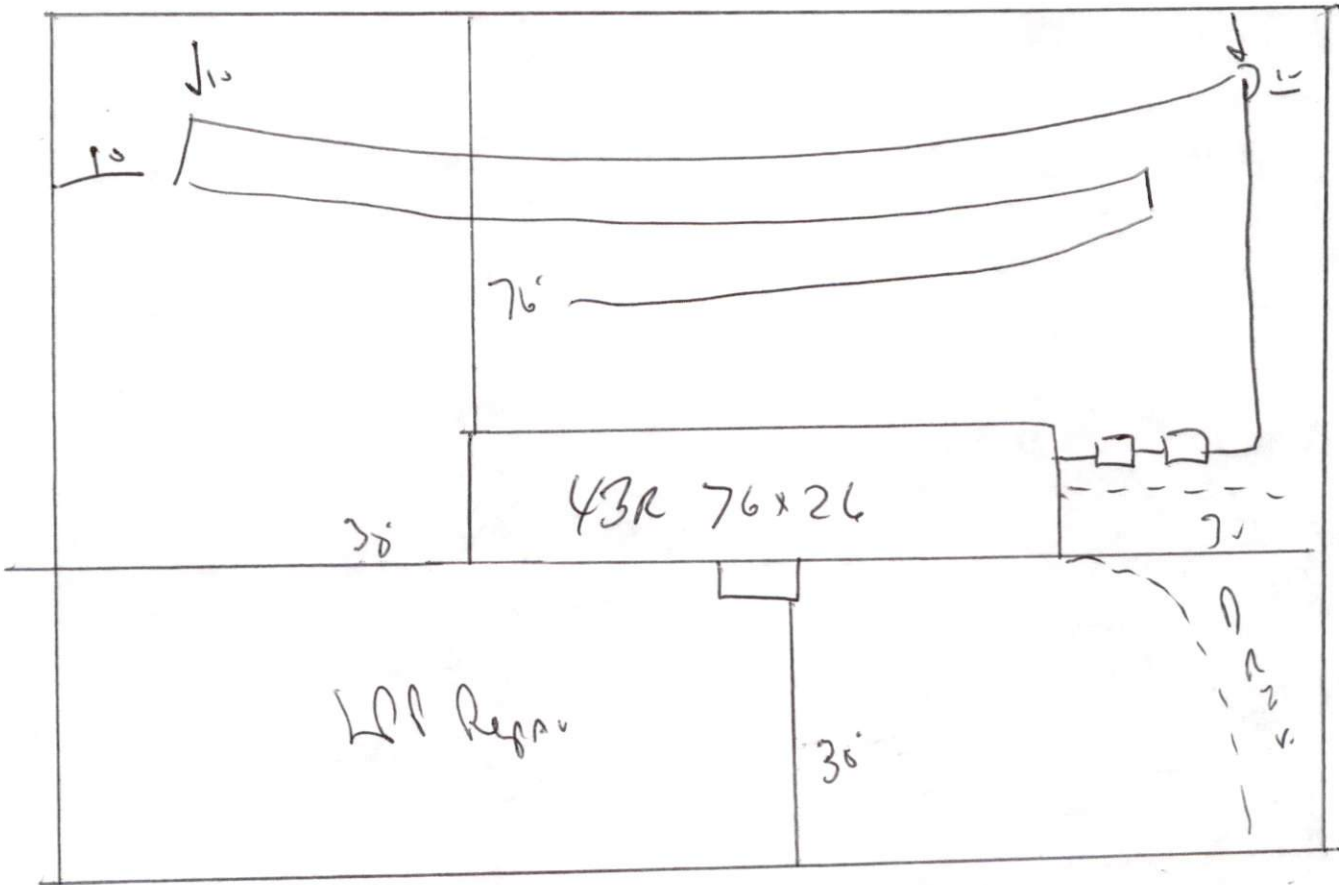

Meet onsite for Final

Install 1x300 of 25% Reductor system at 18"

Maintain All setbacks

STUD out Plumbing shallow where shown