

HTE# 07-500-16984 Harnett County Department of Public Health 23700

Improvement Permit

A building permit cannot be issued with only an Improvement Permit

ISSUED TO: Pine Grove Dev. PROPERTY LOCATION: NC 24
 SUBDIVISION NATURE CROSSROADS LOT # 19
 Type of Structure: MH-30x76 YDA Site Improvements required prior to Construction Authorization Issuance:
 Proposed Wastewater System Type: Pump to 25% Reduction ssk
 Projected Daily Flow: 480 GPD
 Number of bedrooms: 4 Number of Occupants: 8 max
 Basement Yes No
 Pump Required: Yes No May be required based on final location and elevations of facilities
 Type of Water Supply: Community Public Well Distance from well 50 feet Permit valid for: Five years
 Permit conditions: Meet onsite for Final Layout & maintain all set D/keys No expiration
Meet plumber onsite for Final Plumbing stub out - may not need Pump
If stubbed High enough

Authorized State Agent: J. L. Adams Date: 03-14-07 SEE ATTACHED SITE SKETCH
 The issuance of this permit by the Health Department in no way guarantees the issuance of other permits. The permit holder is responsible for checking with appropriate governing bodies in meeting their requirements. This site is subject to revocation if the site plan, plat, or the intended use changes. The Improvement Permit shall not be affected by a change in ownership of the site. This permit is subject to compliance with the provisions of the Laws and Rules for Sewage Treatment and Disposal and to conditions of this permit.

Construction Authorization

(Required for Building Permit)

The construction and installation requirements of Rules .1950, .1952, .1954, .1955, .1956, .1957, .1958, and .1959 are incorporated by references into this permit and shall be met. Systems shall be installed in accordance with the attached system layout.

ISSUED TO: Pine Grove Dev. PROPERTY LOCATION: NC 24
 SUBDIVISION NATURE CROSSROADS LOT # 19
 Facility Type: MH-30x76-4DA New Expansion Repair
 Basement? Yes No Basement Fixtures? Yes No
 Type of Wastewater System** Pump to 25% Red. ssk (Initial) Wastewater Flow: 480 GPD
 (See note below, if applicable) 64 LF of LPP (Repair)

Installation Requirements/Conditions

Septic Tank Size 1000 gallons Exact length of each trench 12400 feet Trench Spacing: 9 Feet on Center
 Pump Tank Size 1000 gallons Trenches shall be installed on contour at a Soil Cover: 6 inches
 ↳ IF Needed Maximum Trench Depth of: 18 MAX inches (Maximum soil cover shall not exceed 36" above the trench bottom)
 Pump Requirements: _____ ft. TDH vs. _____ GPM Aggregate Depth: _____ inches below pipe
 Conditions: _____ inches above pipe
 _____ inches total

**If applicable: I understand the system type specified is different from the type specified on the application. I accept the specifications of this permit.

Owner/Legal Representative Signature: _____ Date: _____

This Construction Authorization is subject to revocation if the site plan, plat, or the intended use changes. The Construction Authorization shall not be transferred when there is a change in ownership of the site. This Construction Authorization is subject to compliance with the provisions of the Laws and Rules for Sewage Treatment and Disposal and to the conditions of this permit.

Authorized State Agent: J. L. Adams Date: 03-14-07 SEE ATTACHED SITE SKETCH
 Construction Authorization Expiration Date: 03-14-2012

HTE# 07-50016984

Permit # 23700

Harnett County Department of Public Health Site Sketch

ISSUED TO: Pine Grove Dev. Corp

PROPERTY LOCATOR: NC24
SUBDIVISION: NATURE CROSS Roads LOT # 19

Authorized State Agent: J. L. [Signature]

Date: 3-17-07

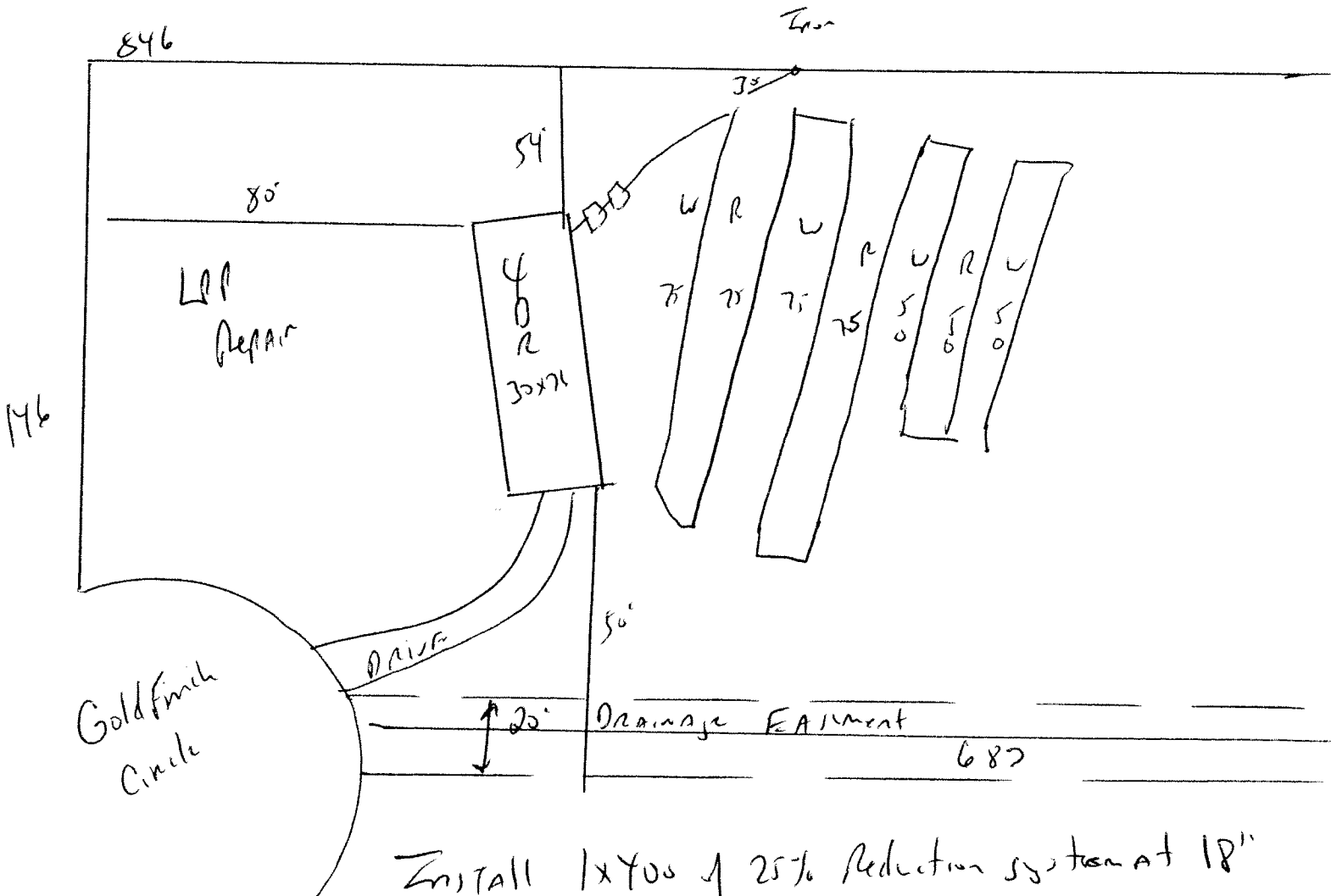

Install 1x400 of 25% Reduction system at 18"
 Maintain All set Backs
 Stub out Plumbing shallow, At ground level or
 higher where shown & Pump may not be needed
 Mark note