

HTE# 07-500-16910

Harn County Department of Public Health

23688

Improvement Permit

A building permit cannot be issued with only an Improvement Permit

ISSUED TO: Terry Anderson
PROPERTY LOCATION: Ballard Rd
SUBDIVISION: Pineview
LOT #:
NEW [X] REPAIR [ ] EXPANSION [ ]
Type of Structure: MH - 12x45 - 2BR
Proposed Wastewater System Type: 25% Red. SYSTEM
Projected Daily Flow: 240 GPD
Number of bedrooms: 2 Number of Occupants: 4 max

Site Improvements required prior to Construction Authorization Issuance:
MH is already set up as 1 bed room
min I can size is 2 Bed room

Basement [ ] Yes [X] No
Pump Required: [ ] Yes [X] No
Type of Water Supply: [ ] Community [X] Public [X] Well
Distance from well 100 feet
Permit valid for: [X] Five years [ ] No expiration
Permit conditions: Meet on site for final layout, in order to maintain fall to the lines at 18' max depth the tank will need to be at ground level.
Stod out plumbing shallow to match tank - if well is being used well must be 10' from septic system

Authorized State Agent: J. L. ... Date: 03-06-07 SEE ATTACHED SITE SKETCH
The issuance of this permit by the Health Department in no way guarantees the issuance of other permits. The permit holder is responsible for checking with appropriate governing bodies in meeting their requirements. This site is subject to revocation if the site plan, plat, or the intended use changes. The Improvement Permit shall not be affected by a change in ownership of the site. This permit is subject to compliance with the provisions of the Laws and Rules for Sewage Treatment and Disposal and to conditions of this permit.

Construction Authorization

(Required for Building Permit)

The construction and installation requirements of Rules .1950, .1952, .1954, .1955, .1956, .1957, .1958, and .1959 are incorporated by references into this permit and shall be met. Systems shall be installed in accordance with the attached system layout.

ISSUED TO: Terry Anderson
PROPERTY LOCATION: Ballard Rd
SUBDIVISION: Pineview
LOT #:
Facility Type: MH 12x45-2BR [X] New [ ] Expansion [ ] Repair
Basement? [ ] Yes [X] No Basement Fixtures? [ ] Yes [X] No
Type of Wastewater System\*\* 25% Reduction system (Initial)
Wastewater Flow: 240 GPD
(See note below, if applicable [X]) 25% reduction system (Repair)

Installation Requirements/Conditions

Septic Tank Size 1000 gallons
Pump Tank Size
Exact length of each trench 1 x 150 feet
Trench Spacing: 9 Feet on Center
Trenches shall be installed on contour at a
Soil Cover: 6 inches
Maximum Trench Depth of: 18 MAX inches
(Maximum soil cover shall not exceed 36" above the trench bottom)
(Pump requirements shall be level to +/- 1/4" in all directions)
Pump Requirements: ft. TDH vs. GPM
Aggregate Depth: inches below pipe
Conditions: inches above pipe
inches total

\*\*If applicable: I understand the system type specified is different from the type specified on the application. I accept the specifications of this permit.

Owner/Legal Representative Signature: Date:

This Construction Authorization is subject to revocation if the site plan, plat, or the intended use changes. The Construction Authorization shall not be transferred when there is a change in ownership of the site. This Construction Authorization is subject to compliance with the provisions of the Laws and Rules for Sewage Treatment and Disposal and to the conditions of this permit.

Authorized State Agent: J. L. ... Date: 03-06-07 SEE ATTACHED SITE SKETCH
Construction Authorization Expiration Date: 03-06-2012

HTE# 07-50016910

Permit # 23688

# Harnett County Department of Public Health Site Sketch

ISSUED TO: Terry Anderson PROPERTY LOCATOR: Bullard Rd  
SUBDIVISION Pineview LOT # —

Authorized State Agent: J. W. [Signature] Date: 3-06-07

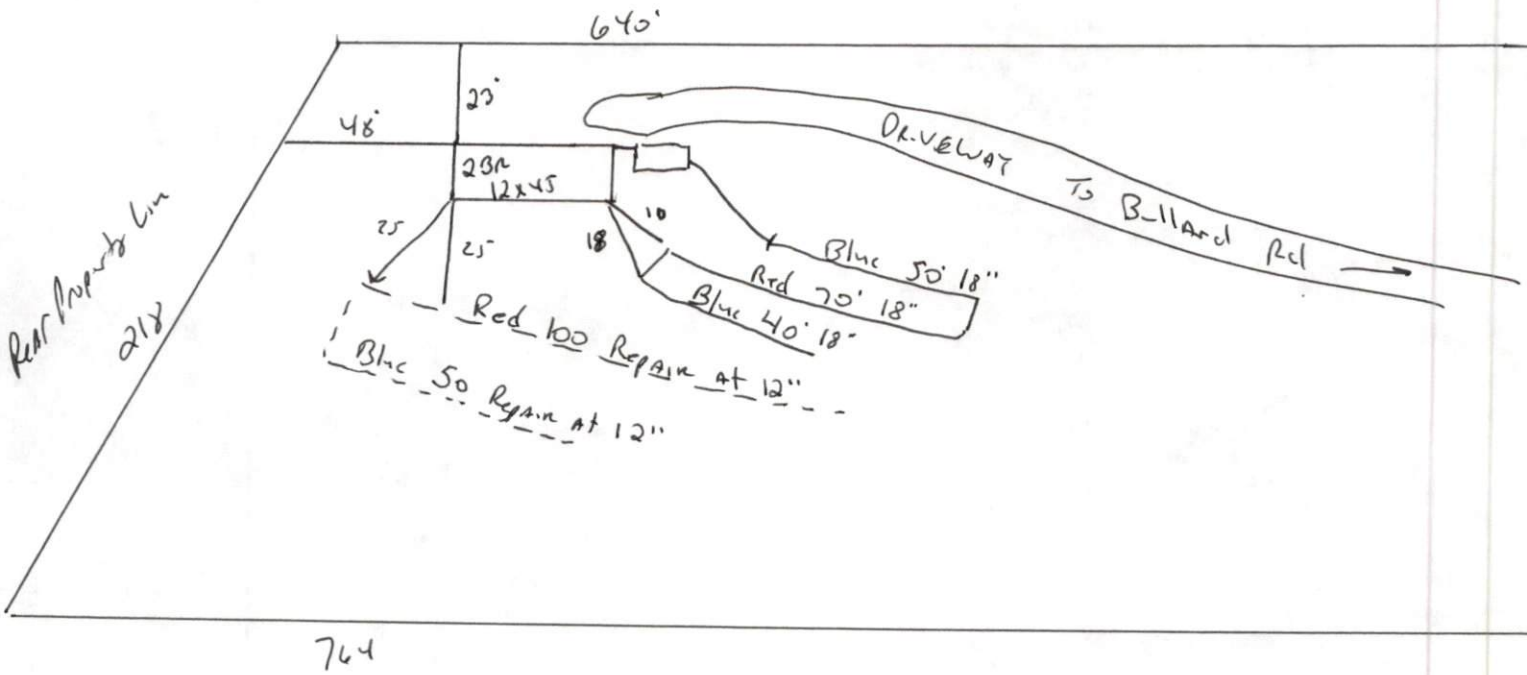

Meet on site MAINTAIN ALL SETBACKS

INSTALL TANK AT GROUND LEVEL OR HIGHER TO MAINTAIN 18" MAX DITCH DEPTHS - DO NOT DRIVE OR PARK ON SEPTIC SYSTEM IF WELL IS BEING USED KEEP WELL 100' FROM ANY PART OF SEPTIC SYSTEM

INSTALL 1x150 @ 25% REDUCTION SYSTEM AT 18" MAX DITCH DEPTH  
REPAIR IS 1x150 @ 25% REDUCTION SYSTEM AT 12"