

HTE# 07-500/6701

Harnett County Department of Public Health

23635

Improvement Permit

A building permit cannot be issued with only an Improvement Permit

ISSUED TO: Pine Grove Dev. PROPERTY LOCATION: NC24 SUBDIVISION: NATURAL CROSS ROAD LOT #: 30
Type of Structure: MH 76x30 YDA
Proposed Wastewater System Type: 25% Reduction System
Projected Daily Flow: 480 GPD
Number of bedrooms: 4 Number of Occupants: 8 max
Basement: No
Pump Required: No
Type of Water Supply: Public
Permit valid for: Five years
STUB out Plumbing shall be (AT GROUND LEVEL OR HIGHER) where shown

Authorized State Agent: J. WARR Date: 01-31-07 SEE ATTACHED SITE SKETCH
The issuance of this permit by the Health Department in no way guarantees the issuance of other permits. The permit holder is responsible for checking with appropriate governing bodies in meeting their requirements. This site is subject to revocation if the site plan, plat, or the intended use changes. The Improvement Permit shall not be affected by a change in ownership of the site. This permit is subject to compliance with the provisions of the Laws and Rules for Sewage Treatment and Disposal and to conditions of this permit.

Construction Authorization

(Required for Building Permit)

The construction and installation requirements of Rules .1950, .1952, .1954, .1955, .1956, .1957, .1958, and .1959 are incorporated by references into this permit and shall be met. Systems shall be installed in accordance with the attached system layout.

ISSUED TO: Pine Grove Dev. PROPERTY LOCATION: NC24 SUBDIVISION: NATURAL CROSS ROAD LOT #: 30
Facility Type: MH 76x30 YDA New
Basement? No
Type of Wastewater System: 25% Reduction (Initial)
Wastewater Flow: 480 LF / LPP (Repair)

Installation Requirements/Conditions

Septic Tank Size: 1000 gallons
Pump Tank Size: _____ gallons
Exact length of each trench: 2x150 feet
Trenches shall be installed on contour at a Maximum Trench Depth of: 18 inches
Trench Spacing: 3 Feet on Center
Soil Cover: 6 inches
(Pump Requirements: _____ ft. TDH vs. _____ GPM)
Aggregate Depth: _____ inches below pipe, _____ inches above pipe, _____ inches total

**If applicable: I understand the system type specified is different from the type specified on the application. I accept the specifications of this permit.

Owner/Legal Representative Signature: _____ Date: _____

This Construction Authorization is subject to revocation if the site plan, plat, or the intended use changes. The Construction Authorization shall not be transferred when there is a change in ownership of the site. This Construction Authorization is subject to compliance with the provisions of the Laws and Rules for Sewage Treatment and Disposal and to the conditions of this permit.

Authorized State Agent: J. WARR Date: 01-31-07 SEE ATTACHED SITE SKETCH
Construction Authorization Expiration Date: 01-31-2012

HTE# 07-500 16701

Permit # 23635

Harnett County Department of Public Health Site Sketch

ISSUED TO: Pine Grove Dev.

PROPERTY LOCATOR: N/24

SUBDIVISION NATURAL (R01) Road

LOT # 36

Authorized State Agent: J. W. W.

Date: 01-31-07

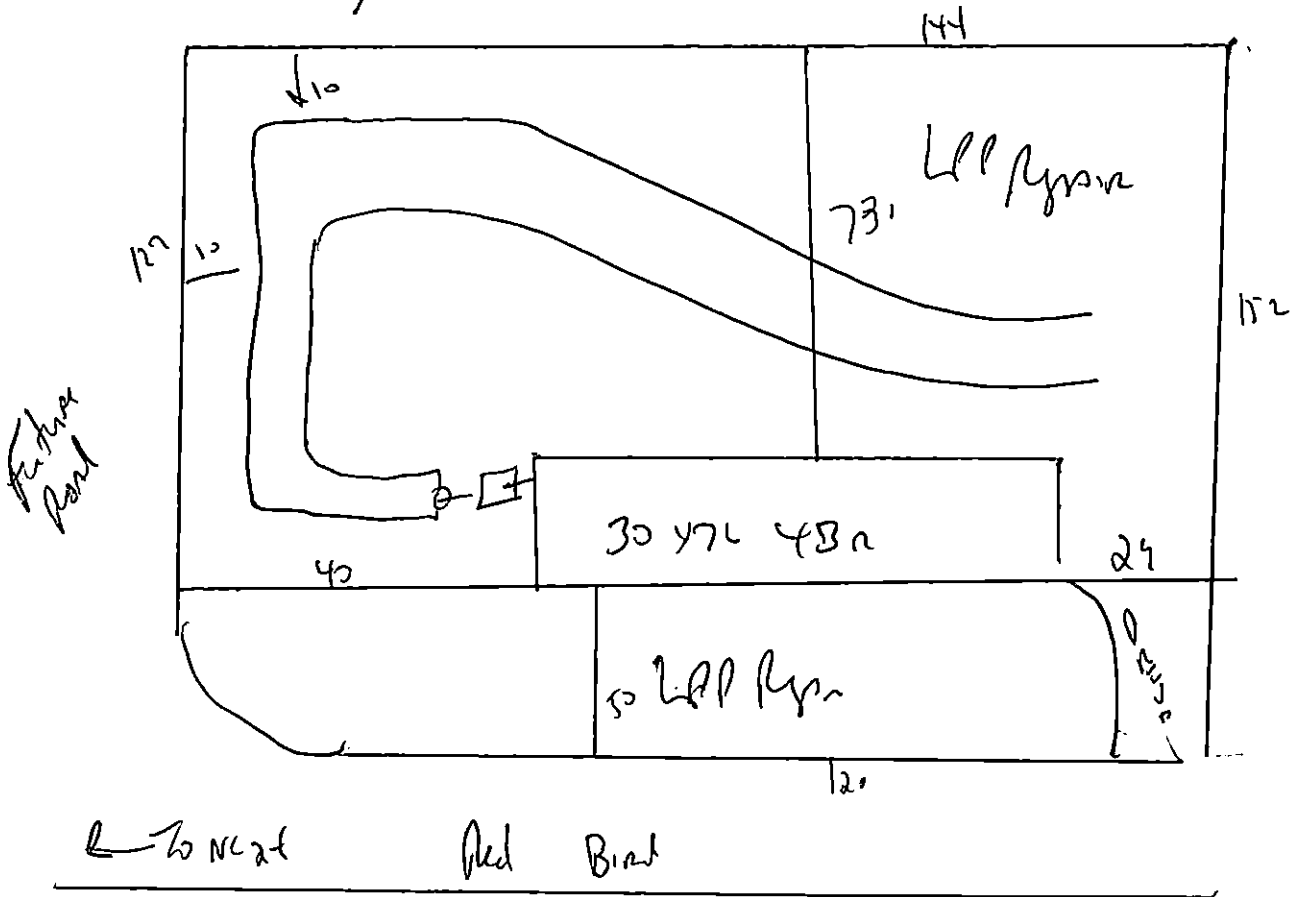

Meet on site
 STUB out Plumbing shallow, at ground level or higher
 where shown
 MAINTAIN ALL SETBACKS