

HTE# 06-500 16264

Harnett County Department of Public Health

23421

### Improvement Permit

A building permit cannot be issued with only an Improvement Permit

ISSUED TO: Wendy Jeter PROPERTY LOCATION: Nc27  
 SUBDIVISION CLEARVIEW LOT # 3  
 NEW  REPAIR  EXPANSION  Site Improvements required prior to Construction Authorization Issuance:  
 Type of Structure: MH 28x80 SBR  
 Proposed Wastewater System Type: 25% Reduction System  
 Projected Daily Flow: 600 GPD  
 Number of bedrooms: 5 Number of Occupants: 10 max  
 Basement  Yes  No  
 Pump Required:  Yes  No  May be required based on final location and elevations of facilities  
 Type of Water Supply:  Community  Public  Well Distance from well 50 feet Permit valid for:  Five years  
 Permit conditions: Meet on site for final layout start plumbing shallow  No expiration  
At ground level or higher where shown maintain all setbacks

Authorized State Agent: J. W. [Signature] Date: 12-12-06 SEE ATTACHED SITE SKETCH  
 The issuance of this permit by the Health Department in no way guarantees the issuance of other permits. The permit holder is responsible for checking with appropriate governing bodies in meeting their requirements. This site is subject to revocation if the site plan, plat, or the intended use changes. The Improvement Permit shall not be affected by a change in ownership of the site. This permit is subject to compliance with the provisions of the Laws and Rules for Sewage Treatment and Disposal and to conditions of this permit.

### Construction Authorization

(Required for Building Permit)

The construction and installation requirements of Rules .1950, .1952, .1954, .1955, .1956, .1957, .1958, and .1959 are incorporated by references into this permit and shall be met. Systems shall be installed in accordance with the attached system layout.

ISSUED TO: Wendy Jeter PROPERTY LOCATION: Nc27  
 SUBDIVISION CLEARVIEW LOT # 3  
 Facility Type: MH 28x80 SBR  New  Expansion  Repair  
 Basement?  Yes  No Basement Fixtures?  Yes  No  
 Type of Wastewater System\*\* 25% Reduction System (Initial) Wastewater Flow: 600 GPD  
 (See note below, if applicable )  
400 LF of LPP (Repair)

#### Installation Requirements/Conditions

Septic Tank Size 1200 gallons Exact length of each trench 3x100 feet Trench Spacing: 9 Feet on Center  
 Pump Tank Size \_\_\_\_\_ gallons Trenches shall be installed on contour at a Soil Cover: 6 inches  
 Maximum Trench Depth of: 18-24 inches (Maximum soil cover shall not exceed 36" above the trench bottom)  
 (Trench bottoms shall be level to +1-1/4" in all directions)  
 Pump Requirements: \_\_\_\_\_ ft. TDH vs. \_\_\_\_\_ GPM Aggregate Depth: \_\_\_\_\_ inches below pipe  
 \_\_\_\_\_ inches above pipe  
 \_\_\_\_\_ inches total  
 Conditions: \_\_\_\_\_

\*\*If applicable: *I understand the system type specified is different from the type specified on the application. I accept the specifications of this permit.*

Owner/Legal Representative Signature: \_\_\_\_\_ Date: \_\_\_\_\_

This Construction Authorization is subject to revocation if the site plan, plat, or the intended use changes. The Construction Authorization shall not be transferred when there is a change in ownership of the site. This Construction Authorization is subject to compliance with the provisions of the Laws and Rules for Sewage Treatment and Disposal and to the conditions of this permit.

Authorized State Agent: J. W. [Signature] Date: 12-12-06 SEE ATTACHED SITE SKETCH  
 Construction Authorization Expiration Date: 12-12-2011

HTE# 06-500-16264

Permit # 23421

# Harnett County Department of Public Health Site Sketch

ISSUED TO: Wendy Jeter

PROPERTY LOCATOR: NC 27

SUBDIVISION CLEARVIEW

LOT # 3

Authorized State Agent: J. W. [Signature]

Date: 12-17-04

Part A way  
LAWC  
125'  
23'  
27'  
↓

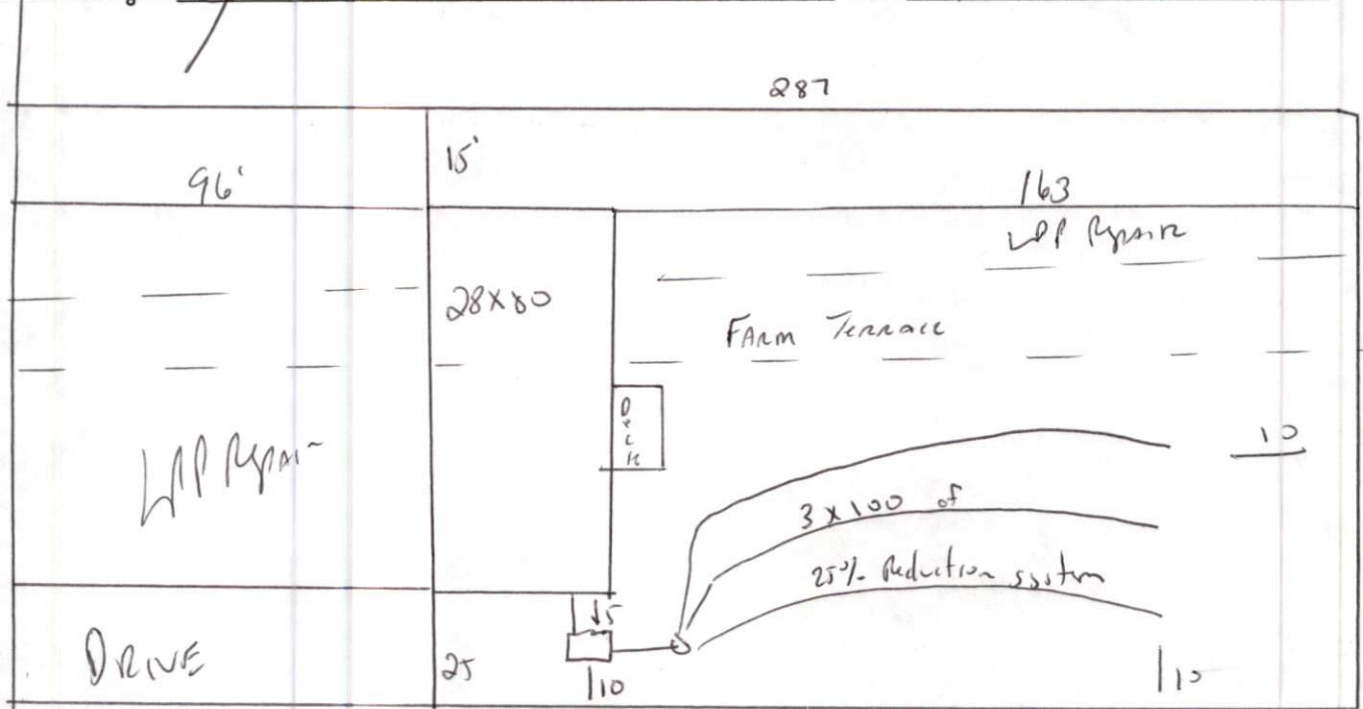

STUB out Plumbing shallow, at ground level or higher where shown  
 Maintain all set backs Meet onsite for Final layout  
 Install 3x100 of 25% reduction system at 18 to 24"