

HTE# 06-50014743

IMPROVEMENT PERMIT 22942

Be it ordained by the Harnett County Board of Health as follows: Section III, Item B. "No person shall begin construction of any building at which a septic tank system is to be used for disposal of sewage without first obtaining a written permit from the Harnett County Health Department."

Name: (owner) Steve Chrises New Installation Septic Tank Repair

Property Location: SR# 1205 Olman M Nitrification Line Expansion

Subdivision --- Lot # ~~9222~~ 9222

Tax ID# --- Quadrant # ---

Number of Bedrooms Proposed: 3 (28x40) 360 gpd Lot Size: 9.09 Ac

Basement with Plumbing: Garage:

Water Supply: Well Public Community

Distance From Well: 50 ft.

Following is the minimum specifications for sewage disposal system on above captioned property. Subject to final approval.

Type of system: Conventional Other ---

Size of tank: Septic Tank: 1000 gallons Pump Tank: --- gallons

Subsurface Drainage Field No. of ditches 1 exact length of each ditch 240 ft. width of ditches 3 ft. depth of ditches 18 1/4 in.

French Drain Required: --- Linear feet

Date: 05-10-06
PERMIT EXPIRES 5 YEARS FROM ABOVE DATE

This permit is subject to revocation if site plans or intended use change.

Signed: J. L. Wray
Environmental Health Specialist

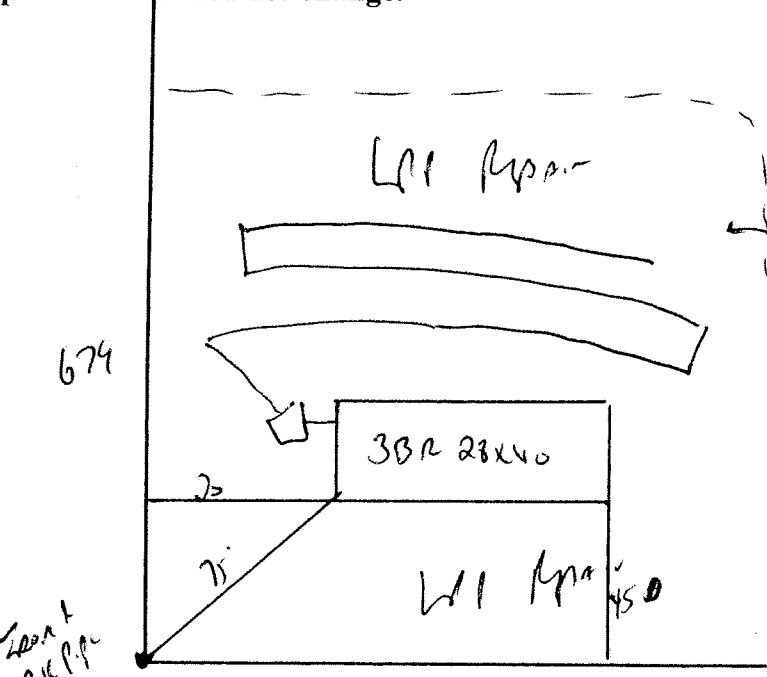

STUB out
Plumbing shallow
At ground level
or higher.
Meet on site for
layout

2" DIA. PVC P.P.

HARNETT COUNTY DEPARTMENT OF PUBLIC HEALTH
AUTHORIZATION TO CONSTRUCT

Authorization is hereby given to construct a wastewater system to the specifications described by Harnett County Department of Public Health, Improvement Permit # 22942. This authorization shall be valid for a period not to exceed five (5) years from the date of issuance. *This authorization will be invalid if ownership, site plans, or intended use change.*

Steve Christen
Name

Telephone #

Address

1205

Property Location SR#

Road Name

—
Subdivision

—
Lot #

3(28x40) 360 gal
Bedrooms Proposed

9.09 ac
Lot Size

TYPE OF SYSTEM

New Installation [] Repair Septic Tank Nitrification Lines

Conventional [] Other _____

[] Basement [] With Plumbing [] Without Plumbing

Water Supply: [] Well Public Water Supply Minimum Well Setback: 50 Ft.

Septic Tank 1000 gal Pump Chamber _____ gal

NITRIFICATION FIELD SPECIFICATIONS

Number of fields 1 # of lines per field 1 Length of lines 270 Ft.

Width of ditches 3 ft. Depth of ditches 18 1/2 inches

French Drain: Linear feet required _____ Depth of gravel _____

No wastewater system shall be covered or placed into use by any person until an inspection by the Harnett County Health Department has determined that the system has been installed according to the conditions of the Improvement Permit and that a valid Operations Permit has been issued.

Jon West RS
Signature of Authorized Agent for Harnett County

05-10-06
Date