

Improvement Permit

A building permit cannot be issued with only an Improvement Permit.

ISSUED TO: Charles White PROPERTY LOCATION: NE 24 / NE 87 (Wilson Rd)
 SUBDIVISION _____ LOT # 1
 NEW REPAIR EXPANSION Site Improvements required prior to Construction Authorization Issuance: _____
 Type of Structure: MH 32x80 3BR
 Proposed Wastewater System Type: Pump to P
 Projected Daily Flow: 360 GPD
 Number of bedrooms: 3 Number of Occupants: 6 max
 Basement Yes No
 Pump Required: Yes No May be required based on final location and elevations of facilities
 Type of Water Supply: Community Public Well Distance from well 100 feet Permit valid for: Five years
 Permit conditions: Met State for Final Layout mandan All Set OK No expiration

Authorized State Agent: J. WAN Date: 08-31-07 SEE ATTACHED SITE SKETCH
 The issuance of this permit by the Health Department in no way guarantees the issuance of other permits. The permit holder is responsible for checking with appropriate governing bodies in meeting their requirements. This site is subject to revocation if the site plan, plat, or the intended use changes. The Improvement Permit shall not be affected by a change in ownership of the site. This permit is subject to compliance with the provisions of the Laws and Rules for Sewage Treatment and Disposal and to conditions of this permit.

Construction Authorization

(Required for Building Permit)

The construction and installation requirements of Rules .1950, .1952, .1954, .1955, .1956, .1957, .1958, and .1959 are incorporated by references into this permit and shall be met. Systems shall be installed in accordance with the attached system layout.

ISSUED TO: Charles White PROPERTY LOCATION: NE 24 / NE 87 (Wilson Rd)
 SUBDIVISION _____ LOT # 1
 Facility Type: MH 22x80 3BR New Expansion Repair
 Basement? Yes No Basement Fixtures? Yes No
 Type of Wastewater System** Pump to 25% Reduction (Initial) Wastewater Flow: 360 GPD
 (See note below, if applicable) LLP Repair (Repair)

Installation Requirements/Conditions

Septic Tank Size 1000 gallons Exact length of each trench 3x100 feet Trench Spacing: 9 Feet on Center
 Pump Tank Size 1000 gallons Trenches shall be installed on contour at a Soil Cover: 6 inches
 Maximum Trench Depth of: 18 inches (Maximum soil cover shall not exceed 36" above the trench bottom)
 (Trench bottoms shall be level to +/- 1/4" in all directions)
 Pump Requirements: _____ ft. TDH vs. _____ GPM Aggregate Depth: _____ inches below pipe
 _____ inches above pipe
 _____ inches total
 Conditions: _____

**If applicable: I understand the system type specified is different from the type specified on the application. I accept the specifications of this permit.

Owner/Legal Representative Signature: _____ Date: _____

This Construction Authorization is subject to revocation if the site plan, plat, or the intended use changes. The Construction Authorization shall not be transferred when there is a change in ownership of the site. This Construction Authorization is subject to compliance with the provisions of the Laws and Rules for Sewage Treatment and Disposal and to the conditions of this permit.

Authorized State Agent: J. WAN Date: 08-31-07 SEE ATTACHED SITE SKETCH
 Construction Authorization Expiration Date: 08-31-2012

HTE# 0650014314R

Permit # 24296

Harnett County Department of Public Health Site Sketch

ISSUED TO: Charles White

PROPERTY LOCATOR: N124/N187 Wilson Rd
SUBDIVISION _____ LOT # 1

Authorized State Agent: *[Signature]*

Date: 0831-07

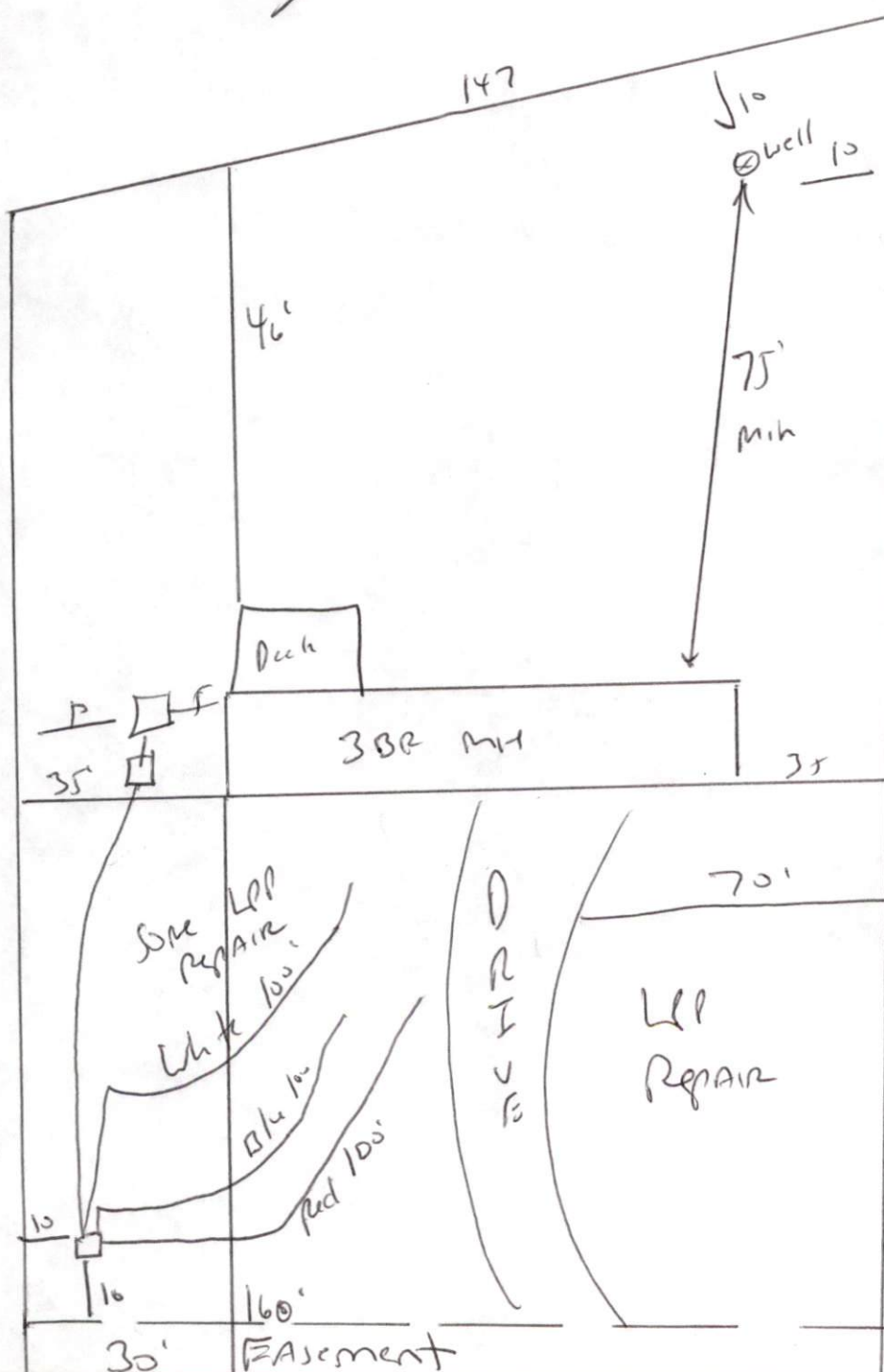

Meet onsite
 Maintain
 All set backs
 keep well
 100' from any
 part of septic
 system

Install
 3x100' of
 25% Reductor
 system

Wilson Rd to N124/127