

HTE # 05-50013728

ARNETT COUNTY HEALTH DEPARTMENT
ENVIRONMENTAL HEALTH SECTION

18273

OPERATIONS PERMIT

Name: (owner) Pine Grove Dev. New Installation Septic Tank Repair

Property Location: SR# 1141 Nitrification Line Expansion
Subdivision Cherokee Ridge Lot # 50 Tax ID # _____ Quadrant # _____

Contractor: Ted Brown Registration # _____

Basement with Plumbing: Garage: Lines ok Tanks ok 3-28-06
Water Supply: Well Public Community Needs Alarm & Alarm Box checked
Distance From Well: 50 ft. Need pump checked

Following are the specifications for the sewage disposal system on above captioned property.

Type of system: Conventional Other Pump to 25% Reduction System Infiltrator
Size of tank: Septic Tank: 1000 gallons Pump Tank: 1200 gallons Quick
4

Subsurface Drainage Field No. of ditches 1 exact length of each ditch 300 ft. width of ditches 3 ft. depth of ditches 18-24 in.

French Drain Required: _____ Linear feet 4 chamber Date: 4-3-06

PERMIT NO. 22432 Inspected by: [Signature]

MCP-1000
STB 814
1-22-06

MCP-1000
ST-57
1-12-06

Proposed Tank

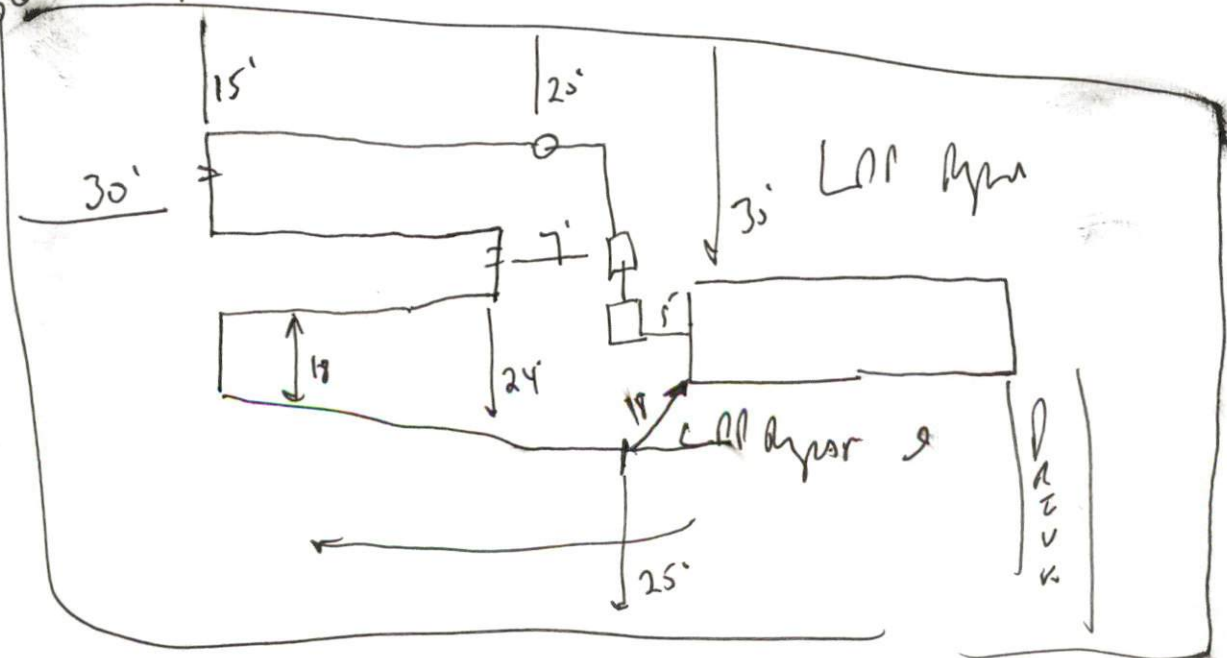

0170