

HTE# 05-50012729

12731
12732

IMPROVEMENT PERMIT

22721

Be it ordained by the Harnett County Board of Health as follows: Section III, Item B. "No person shall begin construction of any building at which a septic tank system is to be used for disposal of sewage without first obtaining a written permit from the Harnett County Health Department."

Name: (owner) Terri Cicci New Installation Septic Tank Repair

Property Location: SR# NC 24/27 Nitrification Line Expansion

Subdivision The Ridge @ Sherwood Forest Lot # 16

Tax ID# _____ Quadrant # _____

Number of Bedrooms Proposed: 4 (76x45) 4 ro sep Lot Size: 93

Basement with Plumbing: Garage:

Water Supply: Well Public Community

Distance From Well: 50 ft.

Following is the minimum specifications for sewage disposal system on above captioned property. Subject to final approval.

Type of system: Conventional Other Pumps to Conventional

Size of tank: Septic Tank: 1200 gallons Pump Tank: 1200 gallons

Subsurface Drainage Field No. of ditches 3 exact length of each ditch 110 ft. width of ditches 2 ft. depth of ditches 18-24 in.

French Drain Required: _____ Linear feet

Date: 08-08-05

This permit is subject to revocation if site plans or intended use change.

PERMIT EXPIRES 5 YEARS FROM ABOVE DATE

Signed: [Signature]
Environmental Health Specialist

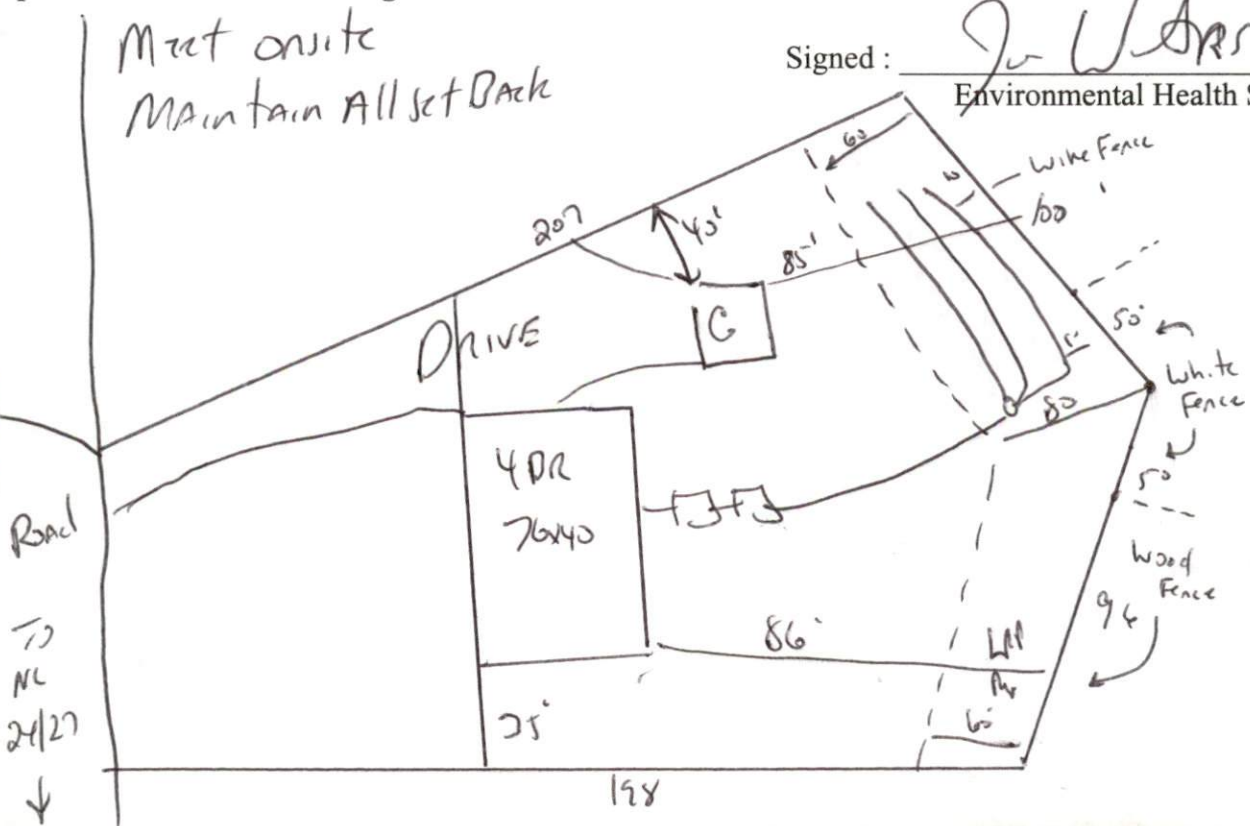

HARNETT COUNTY DEPARTMENT OF PUBLIC HEALTH
AUTHORIZATION TO CONSTRUCT

Authorization is hereby given to construct a wastewater system to the specifications described by Harnett County Department of Public Health, Improvement Permit # 22721. This authorization shall be valid for a period not to exceed five (5) years from the date of issuance. *This authorization will be invalid if ownership, site plans, or intended use change.*

Terri Cren

Name

Telephone #

Address

N124/27

Property Location SR#

Road Name

The Ridge @ Sherwood Forest

16

4 (76x40)

480 sq ft

.93

Subdivision

Lot #

Bedrooms Proposed

Lot Size

TYPE OF SYSTEM

New Installation [] Repair Septic Tank Nitrification Lines

[] Conventional Other Pump To Crawl

[] Basement [] With Plumbing [] Without Plumbing

Water Supply: [] Well Public Water Supply Minimum Well Setback: 50 Ft.

Septic Tank ~~1000~~ 1200 gal Pump Chamber ~~1000~~ 1200 gal

NITRIFICATION FIELD SPECIFICATIONS

Number of fields 1 # of lines per field 3 Length of lines 110 Ft.

Width of ditches 3 ft. Depth of ditches 18 in inches

French Drain: Linear feet required _____ Depth of gravel _____

No wastewater system shall be covered or placed into use by any person until an inspection by the Harnett County Health Department has determined that the system has been installed according to the conditions of the Improvement Permit and that a valid Operations Permit has been issued.

Joe West RS

Signature of Authorized Agent for Harnett County

08-08-05

Date