

Initial Application Date: 7-18-05

Application # 05-50012632  
994552

COUNTY OF HARNETT LAND USE APPLICATION  
Central Permitting 102 E. Front Street, Lillington, NC 27546 Phone: (910) 893-4759 Fax: (910) 893-2793

LANDOWNER: KILARNOLD CORP Mailing Address: HWY 24W  
City: CAMERON State: NC Zip: 28326 Phone #: \_\_\_\_\_  
APPLICANT: COLE WATSON Mailing Address: 4207 BRACE BLVD  
City: FAYETTEVILLE State: NC Zip: 28303 Phone #: 910 818 7731

PROPERTY LOCATION: SR #: 24 SR Name: HWY 24  
Address: LOT 621 CONNECTICUT WAY  
Parcel: 09 957503 0185 21 PIN: 9575-52-5512-000  
Zoning: R20R Subdivision: HERITAGE VILLAGE Lot #: 621 Lot Size: .47  
Flood Plain: X Panel: 0150 Watershed: NA Deed Book/Page: OTI Plat Book/Page: #F/731

DIRECTIONS TO THE PROPERTY FROM LILLINGTON: HWY 27W TO HWY 24 T/L ON HWY 24E  
FOR 1 MILE T/R INTO HERITAGE VILLAGE T/R INTO HERITAGE WAY  
FOR 500 YARDS T/R INTO CONNECTICUT WAY 200 YARDS TO LOT ON RIGHT  
left

PROPOSED USE:

- Sg. Family Dwelling (Size \_\_\_ x \_\_\_) # of Bedrooms \_\_\_ # Baths \_\_\_ Basement (w/wo bath) \_\_\_ Garage \_\_\_ Deck \_\_\_
- Multi-Family Dwelling No. Units \_\_\_ No. Bedrooms/Unit \_\_\_
- Manufactured Home (Size 32 x 76) # of Bedrooms 3 Garage \_\_\_ Deck \_\_\_
- Number of persons per household 4
- Business Sq. Ft. Retail Space \_\_\_ Type \_\_\_
- Industry Sq. Ft. \_\_\_ Type \_\_\_
- Church Seating Capacity \_\_\_ Kitchen \_\_\_
- Home Occupation (Size \_\_\_ x \_\_\_) # Rooms \_\_\_ Use \_\_\_
- Additional Information: \_\_\_\_\_
- Accessory Building (Size \_\_\_ x \_\_\_) Use \_\_\_
- Addition to Existing Building (Size \_\_\_ x \_\_\_) Use \_\_\_
- Other \_\_\_\_\_

Additional Information: \_\_\_\_\_  
Water Supply:  County  Well (No. dwellings \_\_\_)  Other \_\_\_\_\_ Environmental Health Site Visit Date: \_\_\_\_\_

Sewage Supply:  New Septic Tank  Existing Septic Tank  County Sewer  Other \_\_\_\_\_

Erosion & Sedimentation Control Plan Required? YES  NO

Property owner of this tract of land own land that contains a manufactured home w/in five hundred feet (500') of tract listed above? YES  NO

Structures on this tract of land: Single family dwellings \_\_\_ Manufactured homes 1 proposed owner Other (specify) \_\_\_\_\_

Required Residential Property Line Setbacks:	Minimum	Actual
Front	35	40
Rear	25	157
Side	10	10
Corner	20	43
Nearest Building	10	20

If permits are granted I agree to conform to all ordinances and the laws of the State of North Carolina regulating such work and the specifications or plans submitted. I hereby swear that the foregoing statements are accurate and correct to the best of my knowledge.

[Signature] \_\_\_\_\_ Date: 7-18-05

\*\*This application expires 6 months from the initial date if no permits have been issued\*\*

A RECORDED SURVEY PLAT AND RECORDED DEED ARE REQUIRED WHEN APPLYING FOR A LAND USE APPLICATION

7/19/05

1=40

SITE PLAN APPROVAL

DISTRICT B20R USE Permit

#BEDROOMS 3

7-18-05

JAB  
ZONING ADMINISTRATOR

*[Signature]*

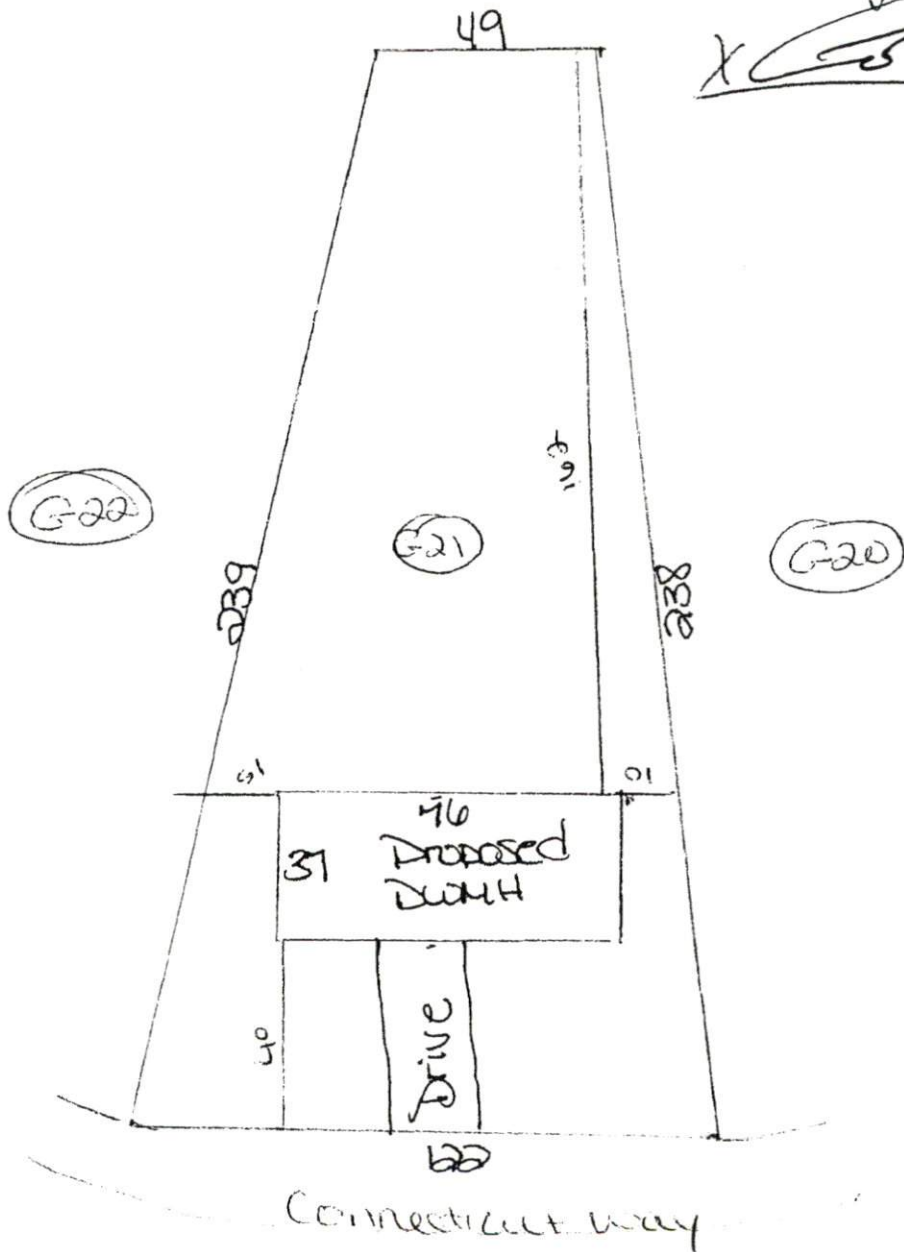

**Harnett County Planning Department**

PO Box 65, Lillington, NC 27546  
910-893-7527

Environmental Health New Septic Systems Test

**Environmental Health Code 800**

- Place "property flags" in each corner of lot. All property lines must be clearly flagged approximately every 50 feet between corners.
- Place "house corner flags" at each corner of where the house/manufactured home will sit. Use additional flagging to outline driveways, garages, decks, out buildings, swimming pools, etc.
- Place flags at locations as developed on site plan by Customer Service Technician and you.
- Place Environmental Health "orange" card in location that is easily viewed from road.
- If property is thickly wooded, Environmental Health requires that you clean out the undergrowth to allow the soil evaluation to be performed. Inspectors should be able to walk freely around site. *No grading of property should be done.*
- After preparing proposed site call the voice permitting system at 910-893-7527 and give code **800** for Environmental Health confirmation. Please note confirmation number given at end of recording for proof of request.
- To hear results, call IVR again. Once approved, proceed to Central Permitting for permits

Environmental Health Existing Tank Inspections

**Environmental Health Code 800**

- Place Environmental Health "orange" card in location that is easily viewed from road.
- Prepare for inspection by removing soil over door as diagram indicates. Loosen trap door cover. (Unless inspection is for a septic tank in a mobile home park)
- After preparing trapdoor call the voice permitting system at 910-893-7527 and give code **800** for Environmental Health confirmation. Please note confirmation number given at end of recording for proof of request.
- To hear results, call IVR again. Once approved, proceed to Central Permitting for permits

Health and Sanitation Inspections

**Health and Sanitation Plan Review 826**

- After submitting plans for food and lodging, call the voice permitting system at 910-893-7527 and give code **826** for Health and Sanitation confirmation. Please note confirmation number given at end of recording for proof of request.
- To hear results, call IVR again. Once approved, proceed to Central Permitting for permits

Fire Marshal Inspections

**Fire Marshall Plan Review Code 804**

- Call the voice permitting system at 910-893-7527 and give code **804** for plan review. Please note confirmation number given at end of recording for proof of request.
- To hear results, call IVR again. Once approved, proceed to Central Permitting for permits
- Pick up Fire Marshal's letter and place on job site until work is completed.

Public Utilities

- Place stake with "orange" tape/name thirty feet (30) from the center of the road at the location you wish to have water tap installed.
- Allow four to six weeks after application for water/sewer taps. Call Utilities at 893-7575 for technical assistance.

Building Inspections

- Call the voice permitting system at 910-893-7527 to schedule inspections. Please note confirmation number given at end of recording for proof of request.
- For new housing/set up permits must meet E 911 / Addressing guidelines prior to calling for final inspection.
- To hear results of inspections, call IVR again.

E911 Addressing

**Addressing Confirmation Code 814**

- Address numbers shall be mounted on the house, 3 inches high (5" for commercial).
- Numbers must be a contrasting color from house, must be clearly visible night and day at entrance of driveway if home is 100 ft or more from road, or if mailbox is on opposite side of road.
- Once you purchase permits and footing inspection has been approved call the voice permitting system at 910-893-7527 and give code **814** for address confirmation. This must be called in even if you have contacted E911 for verbal confirmation

Applicant Signature: \_\_\_\_\_

Date: 7-18-05