

SOIL/SITE EVALUATION
for ON-SITE WASTEWATER SYSTEM

Owner: 05-50012583

Applicant: Same

Address:

Date Evaluated: 7/14/05

Proposed Facility: MH

Design Flow (.1949): 240

Property Size: 1.00ac

Location of Site: S21215

Property Recorded: 2004

Water Supply: Public Individual Well Spring Other

Evaluation Method: Auger Boring Pit Cut

Type of Wastewater: Sewage Industrial Process Mixed

Profile #	.1940 Landscape Position/Slope%	Horizon Depth (IN.)	SOIL MORPHOLOGY .1941		OTHER PROFILE FACTORS				Profile Class & LTAR
			.1941 Structure/Texture	.1941 Consistence Mineralogy	.1942 Soil Wetness/Color	.1943 Soil Depth (IN.)	.1956 Sapro Class	.1944 Restr Horiz	
		0-18	GR SL	VFA SR					
		18-36	SDH SL	FR SR		48			.40
		36-48	SDH SL	F2 SR					
		0-24	GR SL	VFA SR					
		11-40	SDH SL	FR SR		41			.4-3
		40-48	SDH SL	F2 SR					
		0-18	GR SL	VFA SR					
		18-36	SDH SL	FR SR		48			.38
		36-48	SDH SL	F2 SR					
		0-18	GR SL	VFA SR					
		11-38	SDH SL	FR SR		48			.38
		38-48	SDH SL	F2 SR					
		0-18	GR SL	VFA SR					
		11-38	SDH SL	FR SR		48			.38
		38-48	SDH SL	F2 SR					

Description	Initial System	Repair System
Available Space (.1945)	<input checked="" type="checkbox"/>	<input checked="" type="checkbox"/>
System Type(s)	GRAV	LAA
Site LTAR	2x1701321	32011

Other Factors (.1946):
 Site Classification (.1948):
 Evaluated By:
 Others Present:

COMMENTS: _____

<u>LANDSCAPE POSITIONS</u>	<u>GROUP</u>	<u>TEXTURES</u>	<u>.1955 LTAR</u>	<u>CONSISTENCE MOIST</u>	<u>WET</u>
R-RIDGE	I	S-SAND	1.2 - 0.8	VFR-VERY FRIABLE	NS-NON-STICKY
S-SHOULDER SLOPE		LS-LOAMY SAND			
L-LINEAR SLOPE	II	SL-SANDY LOAM	0.8 - 0.6	FR-FRIABLE	SS-SLIGHTLY STICKY
FS-FOOT SLOPE		L-LOAM			
N-NOSE SLOPE	III	SI-SILT-	0.6 - 0.3	FI-FIRM	S-STICKY
H-HEAD SLOPE		SIL-SILT LOAM			
CC-CONCLAVE SLOPE		CL-CLAY LOAM			
CV-CONVEX SLOPE		SCL-SANDY CLAY LOAM			
T-TERRACE	IV	SIC-SILTY CLAY	0.4 - 0.1	VFI-VERY FIRM	VS-VERY STICKY
FP-FLOOD PLAN		C-CLAY			
		SC-SANDY CLAY			

STRUCTURE
 SG-SINGLE GRAIN
 M-MASSIVE
 CR-CRUMB
 GR-GRANULAR
 SBK-SUBANGULAR BLOCKY
 ABK-ANGULAR BLOCKY
 PL-PLATY
 PR-PRISMATIC

MINERALOGY
 SLIGHTLY EXPANSIVE
 EXPANSIVE

Show profile locations and other site features (dimensions, reference or benchmark, and North).

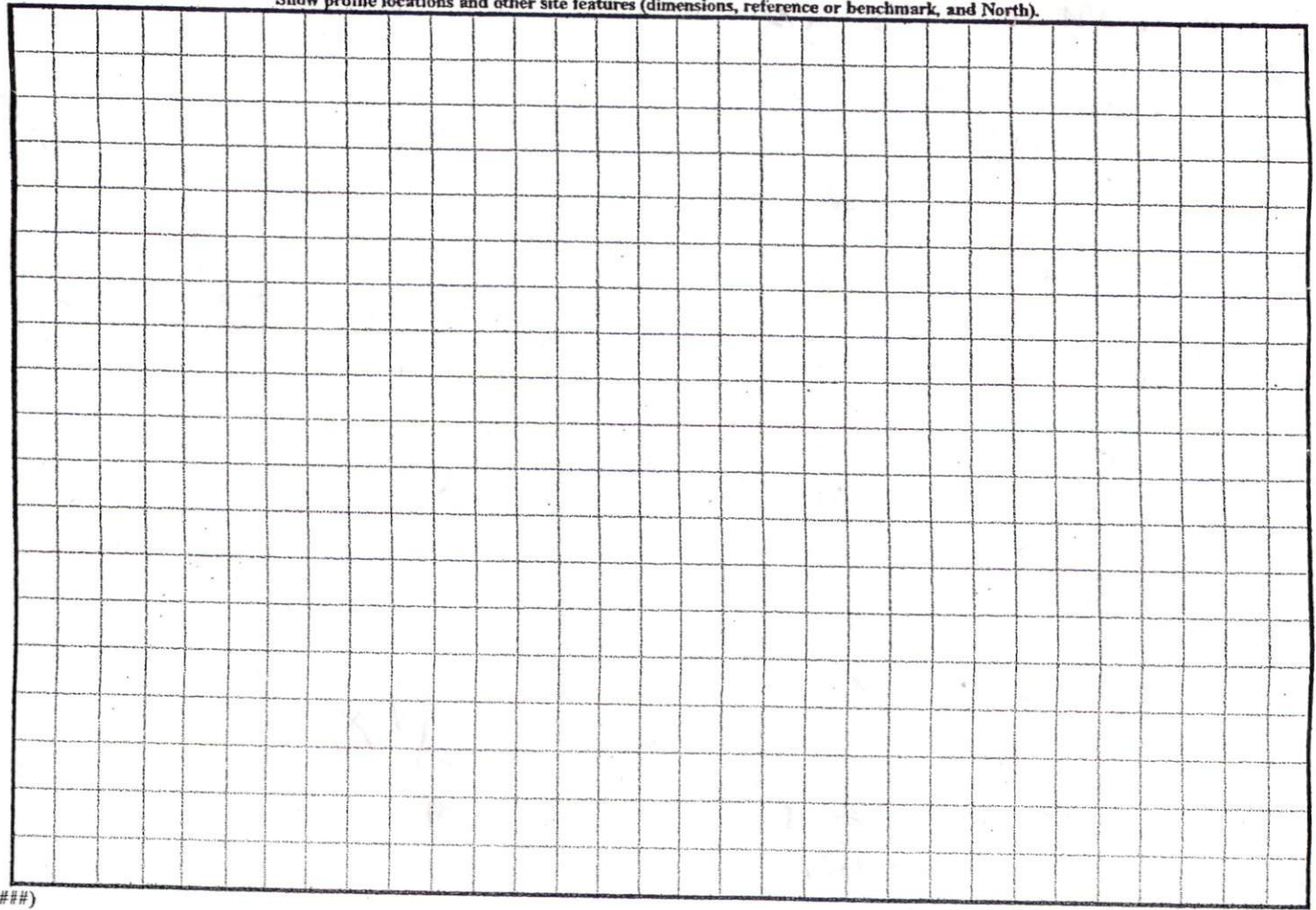



SITE PLAN APPROVAL

DISTRICT RA2em USE sumh

#BEDROOMS 2

7-1105

ZONING ADMINISTRATOR

OTHER CATEGORY, SUCH AS
EXISTING PARCELS, A
OF OTHER EXCEPTION TO
DIVISION.



2004011614

FOR REGISTRATION REGISTER OF DEEDS
KIMBERLY S. HARGROVE
HARNETT COUNTY, NC
2004 JUN 23 03:01:58 PM
BK: 2004 PG: 614-615 FEE: \$21.00

INSTRUMENT # 2004011614

NORTH CAROLINA, HARNETT COUNTY
PRESENTED FOR REGISTRATION ON THE 23 D

OF June 20 04 AT 3:01P

RECORDED AT MAP NUMBER 2004-1614

Kimberly S. Hargrove
REGISTER OF DEEDS ASST. DEPUTY

Max lower

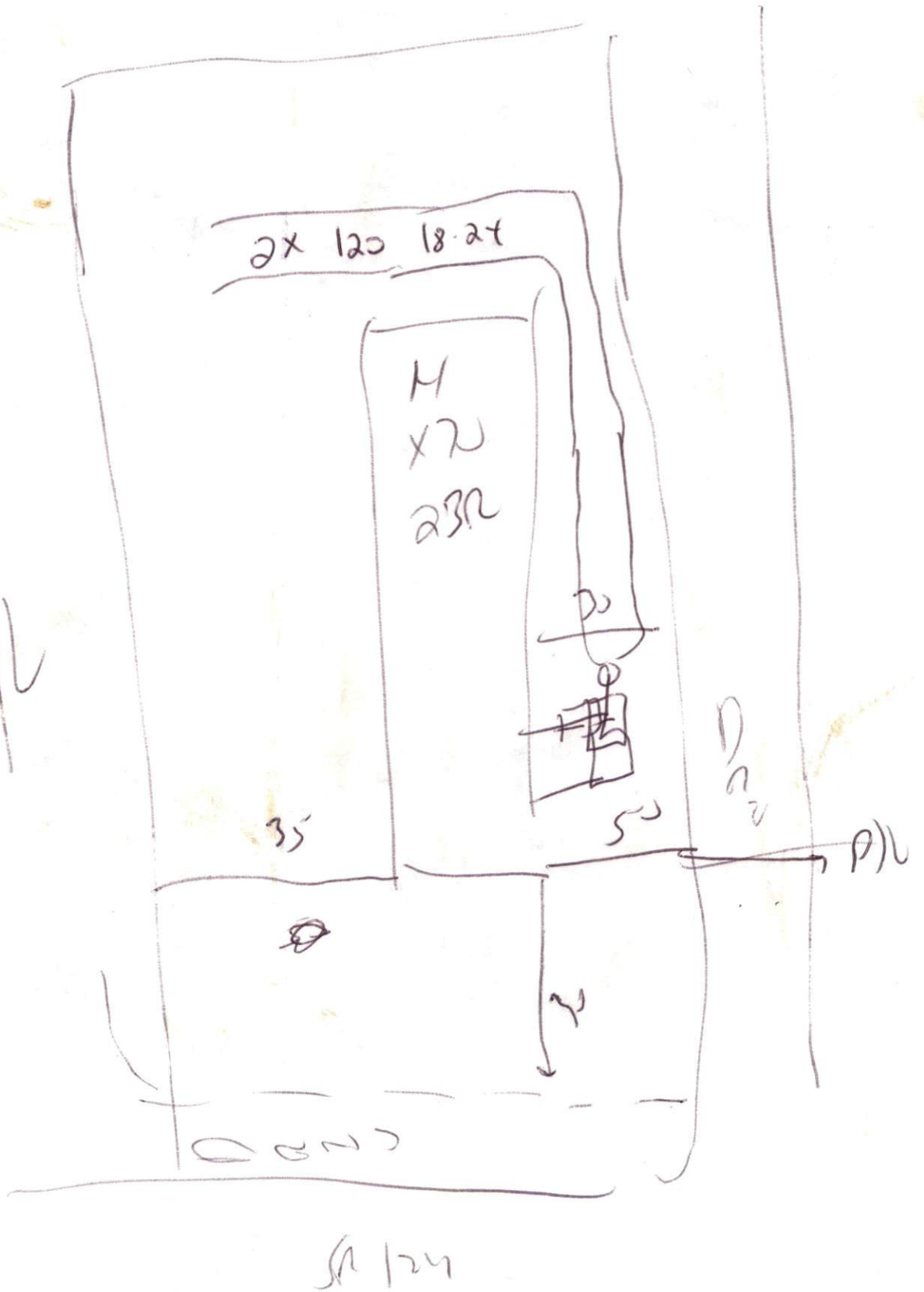

M

1
 35
 115
 50

124