

HTE 045-9875

IMPROVEMENT PERMIT

Be it ordained by the Harnett County Board of Health as follows: Section III, Item B. "No Person shall begin construction of any building at which a septic tank system is to be used for disposal of sewage without first obtaining a written permit from the Harnett County Health Department."

Name: (owner) PINE GROVE DEVELOPMENT CORP

New Installation

Septic Tank

Property Location: SR# 1141 MICROTOWER

Repairs

Nitrification Line

Subdivision CHEROKEE RIDGE Lot # 38

Tax ID # _____ Quadrant # _____

Number of Bedrooms Proposed: 3 Lot Size: 1 AC

Basement with Plumbing: Garage:

Water Supply: Well Public Community

Distance From Well: 100 ft.

Following is the minimum specifications for sewage disposal system on above captioned property. Subject to final approval.

Type of system: Conventional Other _____

Size of tank: Septic Tank: 1000 gallons Pump Tank: _____ gallons

Subsurface Drainage Field: No. of ditches 3 exact length of each ditch 70 ft. width of ditches 3 ft. depth of ditches 18-24 in.

French Drain Required: _____ Linear feet

Date: 7/14/04

This permit is subject to revocation if site plans or intended use change.

Signed: [Signature] Environmental Health Specialist

DRAWING NTS

* MAINTAIN ALL SETBACKS

* CALL WITH ANY QUESTIONS PRIOR TO INSTALLATION

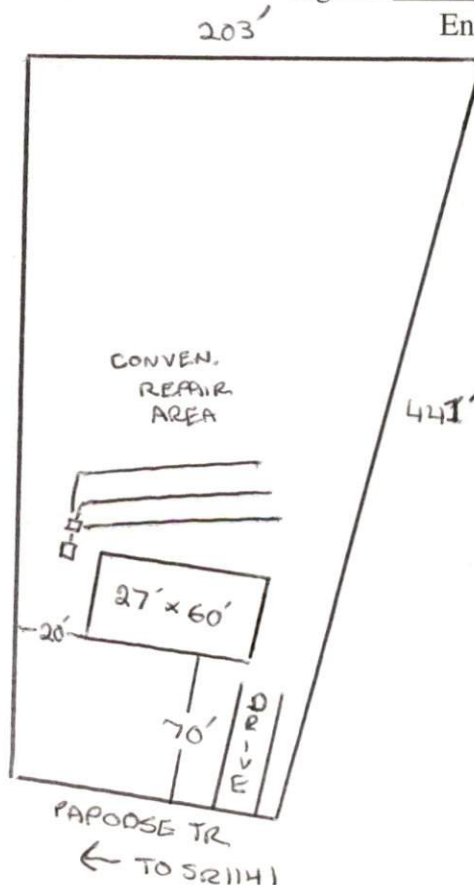

HARNETT COUNTY DEPARTMENT OF PUBLIC HEALTH
AUTHORIZATION TO CONSTRUCT

Authorization is hereby given to construct a wastewater system to the specifications described by Harnett County Department of Public Health, Improvement Permit # 20924. This authorization shall be valid for a period not to exceed five (5) years from the date of issuance. *This authorization will be invalid if ownership, site plans, or intended use change.*

PINE GROVE DEV. CORP 498-2204
Name Telephone #

622 BUFFALO LAKE RD SANFORD NC 27332
Address

1141 MICROTOWER
Property Location SR# Road Name

CHEROKEE ROBE 38 3 1 AC
Subdivision Lot # # Bedrooms Proposed Lot Size

TYPE OF SYSTEM

New Installation [] Repair Septic Tank Nitrification Lines
 Conventional [] Other _____
[] Basement [] With Plumbing [] Without Plumbing

Water Supply: [] Well Public Water Supply Minimum Well Setback: 100 Ft.
Septic Tank 1000 gal Pump Chamber _____ gal

NITRIFICATION FIELD SPECIFICATIONS

Number of fields 1 # of lines per field 3 Length of lines 70 Ft.
Width of ditches 3 ft. Depth of ditches 18-24 inches
French Drain: Linear feet required _____ Depth of gravel _____

No wastewater system shall be covered or placed into use by any person until an inspection by the Harnett County Health Department has determined that the system has been installed according to the conditions of the Improvement Permit and that a valid Operations Permit has been issued.

[Signature] 7/14/04
Signature of Authorized Agent for Harnett County Date