

IMPROVEMENT PERMIT

03-57431

Be it ordained by the Harnett County Board of Health as follows: Section III, Item B. "No Person shall begin construction of any building at which a septic tank system is to be used for disposal of sewage without first obtaining a written permit from the Harnett County Health Department."

Name: (owner) Pine Grove Dev.

New Installation Septic Tank

Property Location: SR# NC24/27

Repairs Nitrification Line

Subdivision Wood Bridge Lot # 28

Tax ID # _____ Quadrant # _____

Number of Bedrooms Proposed: 3 (27x76) Lot Size: 62 AC

Basement with Plumbing: Garage:

Water Supply: Well Public Community

Distance From Well: 50 ft.

Following is the minimum specifications for sewage disposal system on above captioned property. Subject to final approval.

Type of system: Conventional Other Pump to Conventional

Size of tank: Septic Tank: 1000 gallons Pump Tank: 1000 gallons

Subsurface Drainage Field No. of ditches 1 exact length of each ditch 350 ft. width of ditches 3 ft. depth of ditches 18 in. max

French Drain Required: _____ Linear feet

Date: 7-15-03

This permit is subject to revocation if site plans or intended use change.

Signed: [Signature]
Environmental Health Specialist

172

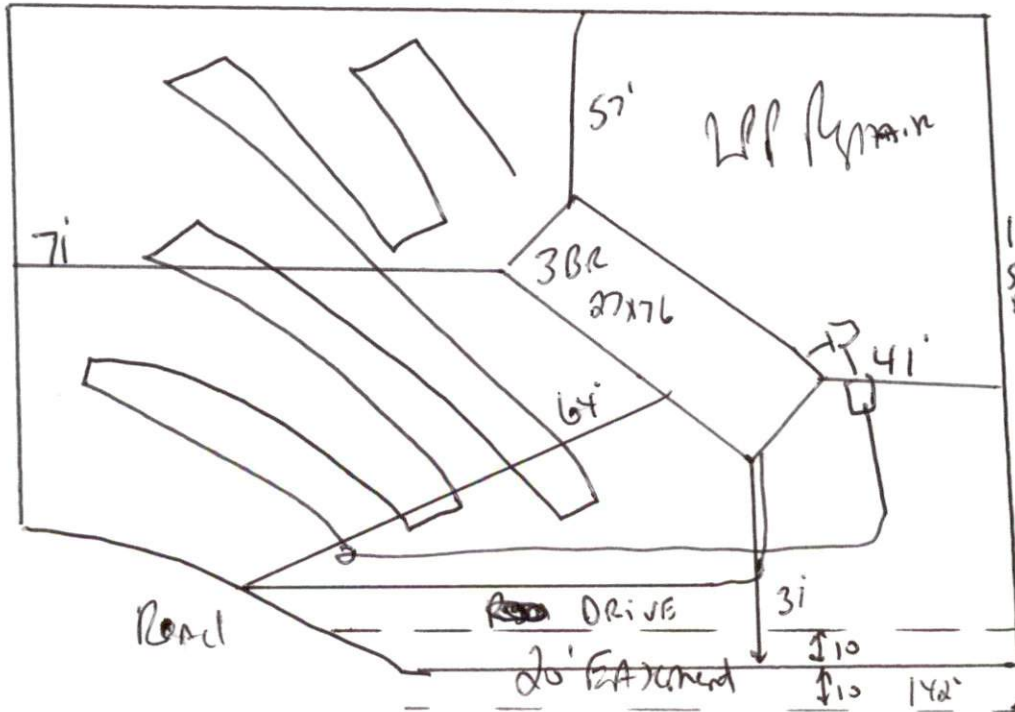

Maintain
All set Baths
Do not
DRIVE OR
PARK ON
SEPTIC SYSTEM

HARNETT COUNTY HEALTH DEPARTMENT
AUTHORIZATION TO CONSTRUCT

Authorization is hereby given to construct a wastewater system to the specifications described by Harnett County Health Department, Improvement Permit # 20763. This authorization shall be valid for a period not to exceed five (5) years from the date of issuance. This authorization will be invalid if ownership, site plans, or intended use change.

Pine Grove 498-2204
Name Telephone#

Address

NC 24/27
Property Location SR#

Wood Bridge 28 3(27x76) .62 ac
Subdivision Lot # # Bedrooms Proposed Lot Size

TYPE OF SYSTEM

- New Installation Repair Septic Tank Nitrification Lines
 Conventional Other Plug to Council
 Basement With Plumbing Without Plumbing

Water Supply: Well Public Water Supply Minimum Well Setback: _____ Ft.

Septic Tank 1000 gal Pump Chamber 1000 gal

NITRIFICATION FIELD SPECIFICATIONS

Number of fields 1 # of lines per field 1 Length of lines 350 Ft.

Width of ditches 3 ft. Depth of ditches 18 in inches

French Drain: Linear feet required _____ Depth of gravel _____

No wastewater system shall be covered or placed into use by any person until an inspection by the Harnett County Health Department has determined that the system has been installed according to the conditions of the Improvement Permit and that a valid Operations Permit has been issued.

[Signature] 7-15-03
Signature of Authorized Agent for Harnett County of Harnett Date