

IMPROVEMENT PERMIT

03-5-7037

Be it ordained by the Harnett County Board of Health as follows: Section III, Item B. "No Person shall begin construction of any building at which a septic tank system is to be used for disposal of sewage without first obtaining a written permit from the Harnett County Health Department."

Name: (owner) Jacob Mundy

New Installation  Septic Tank

Property Location: SR# 1201

Repairs  Nitrification Line

Subdivision MORLEY FARM Lot # 2

Tax ID # \_\_\_\_\_ Quadrant # \_\_\_\_\_

Number of Bedrooms Proposed: 4 (27x76) Lot Size: 1.05 AC

Basement with Plumbing:  Garage:

Water Supply:  Well  Public  Community

Distance From Well: 50 ft.

Following is the minimum specifications for sewage disposal system on above captioned property. Subject to final approval.

Type of system:  Conventional  Other \_\_\_\_\_

Size of tank: Septic Tank: 1000 gallons Pump Tank: \_\_\_\_\_ gallons

Subsurface Drainage Field No. of ditches 1 exact length 360 ft. width of ditches 3 ft. depth of ditches 18 in.

French Drain Required: 4 1/2 x 500' Linear feet

To Be At least 54" Deep with 48" x 18" gravel Date: 5-29-03

This permit is subject to revocation if site plans or intended use change.

Signed: [Signature]  
Environmental Health Specialist

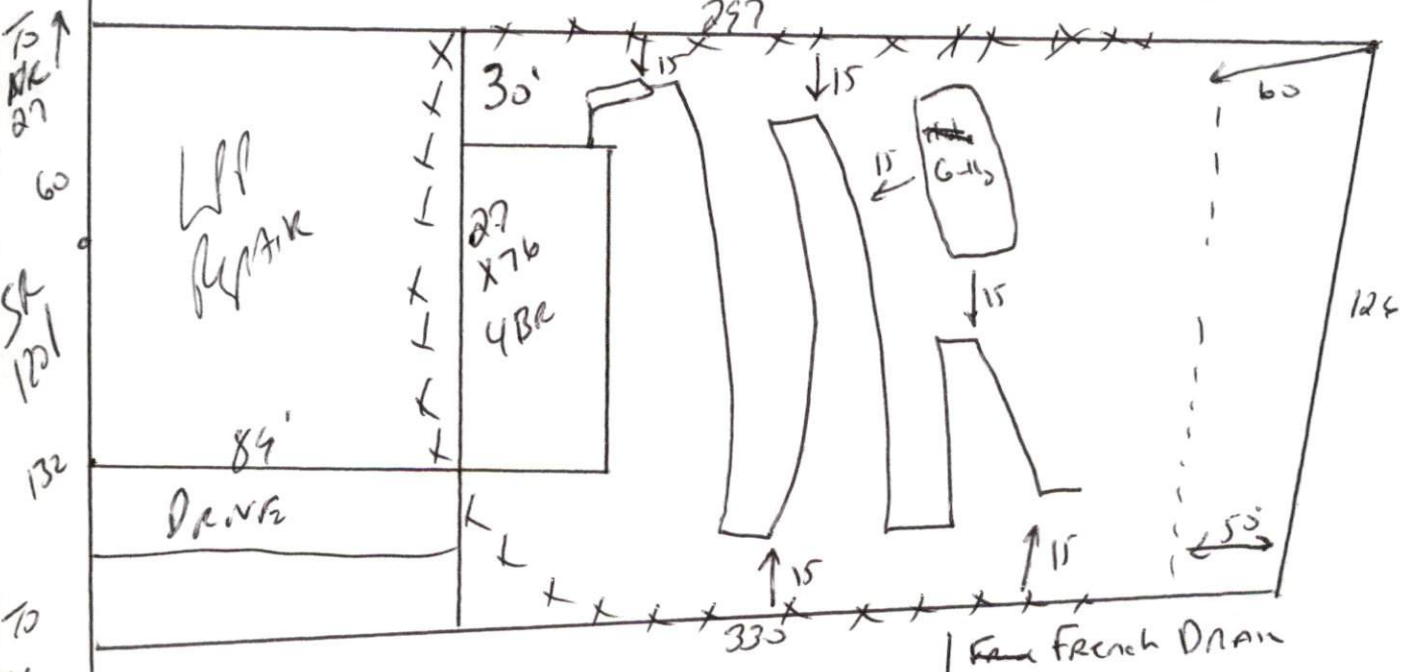

Maintain all set backs  
 Do not Drive or park on septic system  
 French Drain to Be 54" Deep with 48" of gravel & to extend  
 20' past ~~the~~ septic system Drain Lines to 15' from French Drain

**HARNETT COUNTY HEALTH DEPARTMENT  
AUTHORIZATION TO CONSTRUCT**

Authorization is hereby given to construct a wastewater system to the specifications described by Harnett County Health Department, Improvement Permit # 19412. This authorization shall be valid for a period not to exceed five (5) years from the date of issuance. *This authorization will be invalid if ownership, site plans, or intended use change.*

Jacob Munch 488 498-3896  
Name Telephone#

Address \_\_\_\_\_

1201  
Property Location, SR# Road Name

Morky Farm  
Subdivision Lot # # Bedrooms Proposed Lot Size

**TYPE OF SYSTEM**

New Installation [ ] Repair  Septic Tank  Nitrification Lines  
 Conventional [ ] Other \_\_\_\_\_

[ ] Basement [ ] With Plumbing [ ] Without Plumbing

Water Supply: [ ] Well  Public Water Supply Minimum Well Setback: 50 Ft.

Septic Tank 1000 gal Pump Chamber \_\_\_\_\_ gal

**NITIRFICATION FIELD SPECIFICATIONS**

Number of fields 1 # of lines per field 1 Length of lines 360 Ft.

Width of ditches 3 ft. Depth of ditches 18 inches

French Drain: Linear feet required 500 Depth of gravel 48"

No wastewater system shall be covered or placed into use by any person until an inspection by the Harnett County Health Department has determined that the system has been installed according to the conditions of the Improvement Permit and that a valid Operations Permit has been issued.

[Signature] 5-29-07  
Signature of Authorized Agent for Harnett County of Harnett Date