

IMPROVEMENT PERMIT

03-5-6593

Be it ordained by the Harnett County Board of Health as follows: Section III, Item B. "No Person shall begin construction of any building at which a septic tank system is to be used for disposal of sewage without first obtaining a written permit from the Harnett County Health Department."

Name: (owner) Pine Grove Dev.
Property Location: SR# NC24/27
New Installation, Septic Tank, Repairs, Nitrification Line

Subdivision Wood Bridge Lot # 7

Tax ID # Quadrant #

Number of Bedrooms Proposed: 3 (27x56) Lot Size: .73 ac

Basement with Plumbing: Garage: NOTE The change in house location

Water Supply: Well, Public, Community

Distance From Well: ft.

Following is the minimum specifications for sewage disposal system on above captioned property. Subject to final approval.

Type of system: Conventional, Other

Size of tank: Septic Tank: 1000 gallons Pump Tank: gallons

Subsurface Drainage Field No. of ditches 1 exact length of each ditch 300 width of ditches 3 ft. depth of ditches 18 in.

French Drain Required: Linear feet

Date: 03-06-03

Signed: Joe Waters Environmental Health Specialist

This permit is subject to revocation if site plans or intended use change.

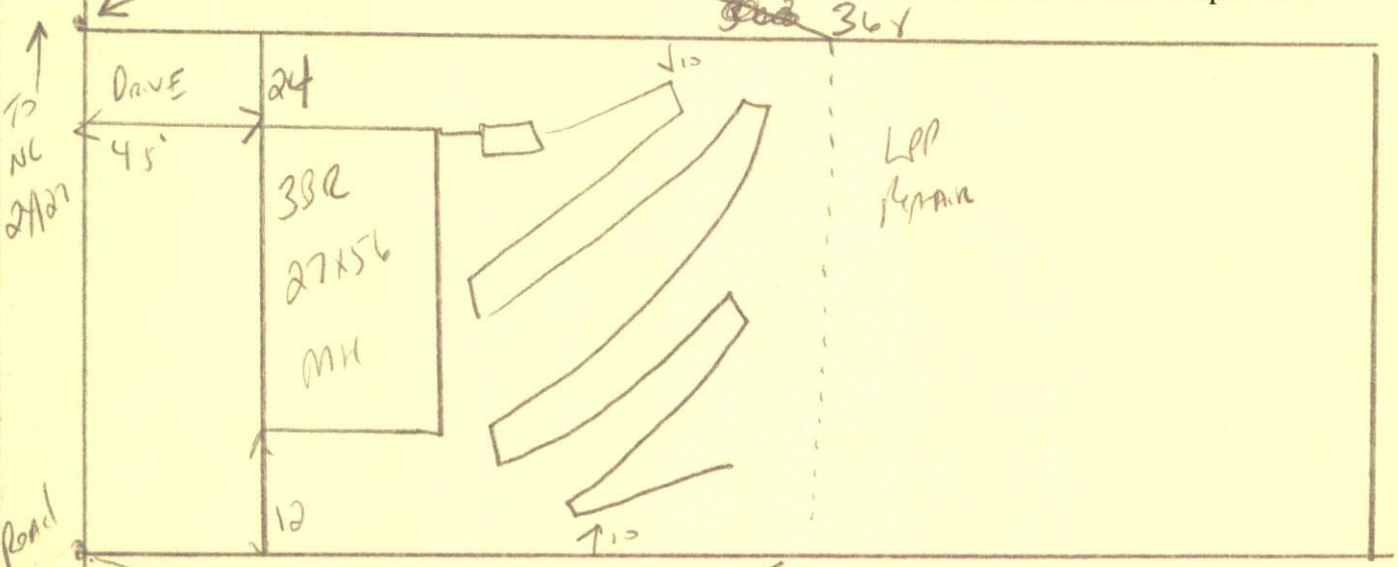

NOTE change in house location
Maintain all set back
Keep system between house & 130' from front property line

Do not Drive or park on septic system

HARNETT COUNTY HEALTH DEPARTMENT  
AUTHORIZATION TO CONSTRUCT

Authorization is hereby given to construct a wastewater system to the specifications described by Harnett County Health Department, Improvement Permit # 19258. This authorization shall be valid for a period not to exceed five (5) years from the date of issuance. This authorization will be invalid if ownership, site plans, or intended use change.

Name Pine Grove Dev Telephone# 798-2204

Address \_\_\_\_\_

Property Location SR# Nc24/27 Road Name \_\_\_\_\_

Subdivision Wood Bridge Lot # 7 # Bedrooms Proposed 3(27x56) Lot Size 732

**TYPE OF SYSTEM**

- New Installation     Repair     Septic Tank     Nitrification Lines
- Conventional     Other \_\_\_\_\_
- Basement     With Plumbing     Without Plumbing

Water Supply:  Well     Public Water Supply    Minimum Well Setback: \_\_\_\_\_ Ft.

Septic Tank 10000 Pump Chamber \_\_\_\_\_

**NITIRIFICATION FIELD SPECIFICATIONS**

Number of fields 1 # of lines per field 1 Length of lines 300 Ft.

Width of ditches 3 ft. Depth of ditches 18 inches

French Drain: Linear feet required \_\_\_\_\_ Depth of gravel \_\_\_\_\_

No wastewater system shall be covered or placed into use by any person until an inspection by the Harnett County Health Department has determined that the system has been installed according to the conditions of the Improvement Permit and that a valid Operations Permit has been issued.

Signature of Authorized Agent for Harnett County of Harnett \_\_\_\_\_ Date 03-06-07