

IMPROVEMENT PERMIT

03-5-6504

Be it ordained by the Harnett County Board of Health as follows: Section III, Item B. "No Person shall begin construction of any building at which a septic tank system is to be used for disposal of sewage without first obtaining a written permit from the Harnett County Health Department."

Name: (owner) Pine Grove Des. Corp.

- New Installation
- Septic Tank
- Repairs
- Nitrification Line

Property Location: SR# NC 24/27

Subdivision Wood Bridge Lot # 37

Tax ID # _____ Quadrant # _____

Number of Bedrooms Proposed: 3 (27x60) Lot Size: .64 AC.

Basement with Plumbing: Garage:

Water Supply: Well Public Community

Distance From Well: 50 ft.

Following is the minimum specifications for sewage disposal system on above captioned property. Subject to final approval.

Type of system: Conventional Other _____

Size of tank: Septic Tank: 1000 gallons Pump Tank: _____ gallons

Subsurface Drainage Field No. of ditches 4 exact length of each ditch 100 ft. width of ditches 3 ft. depth of ditches 18 in. ^{MAX}

French Drain Required: _____ Linear feet

Date: 02-24-03

This permit is subject to revocation if site plans or intended use change.

Signed: [Signature]
Environmental Health Specialist

STUB out Plumbing where shown
 MAINTAIN ALL SET BACK
 DO NOT DRIVE OR PARK ON SEPTIC SYSTEM
 18" MAX Ditch Depth

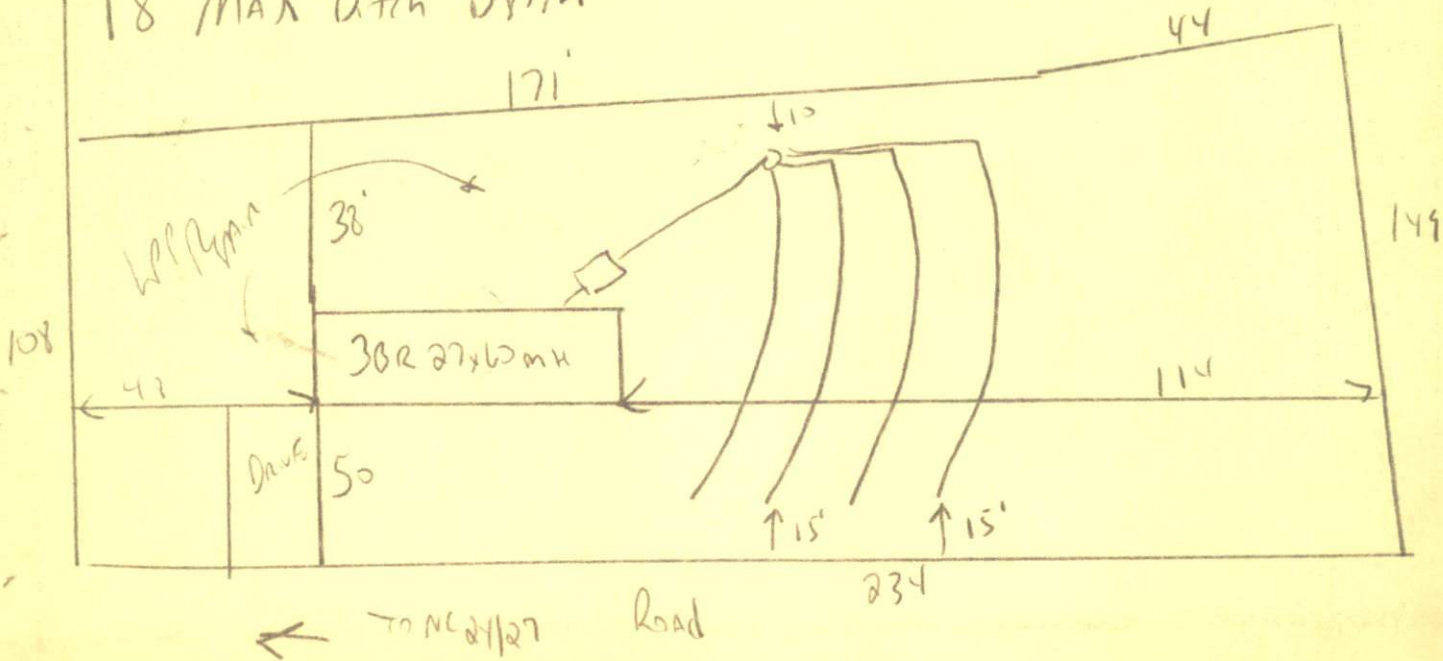

HARNETT COUNTY HEALTH DEPARTMENT
AUTHORIZATION TO CONSTRUCT

Authorization is hereby given to construct a wastewater system to the specifications described by Harnett County Health Department, Improvement Permit # 19950. This authorization shall be valid for a period not to exceed five (5) years from the date of issuance. This authorization will be invalid if ownership, site plans, or intended use change.

Name Pine Grove Dr. Telephone# 498-2204

Address NC 24/27

Property Location SR# Word Bridge Road Name .64 AC
Subdivision 37 Lot # 3(27x60) # Bedrooms Proposed

TYPE OF SYSTEM

- New Installation Repair Septic Tank Nitrification Lines
- Conventional Other _____
- Basement With Plumbing Without Plumbing

Water Supply: Well Public Water Supply Minimum Well Setback: 5 Ft.
Septic Tank 1000 gal Pump Chamber _____ gal

NITRIFICATION FIELD SPECIFICATIONS

Number of fields 1 # of lines per field 4 Length of lines 100 Ft.
Width of ditches 3 ft. Depth of ditches 18 max inches
French Drain: Linear feet required _____ Depth of gravel _____

No wastewater system shall be covered or placed into use by any person until an inspection by the Harnett County Health Department has determined that the system has been installed according to the conditions of the Improvement Permit and that a valid Operations Permit has been issued.

Signature of Authorized Agent for Harnett County of Harnett [Signature] Date 2-24-03