

IMPROVEMENT PERMIT

03-5-6016

Be it ordained by the Harnett County Board of Health as follows: Section III, Item B. "No Person shall begin construction of any building at which a septic tank system is to be used for disposal of sewage without first obtaining a written permit from the Harnett County Health Department."

Name: (owner) Jane, Mark Creech

New Installation  Septic Tank

Property Location: SR# NC27

Repairs  Nitrification Line

Subdivision housing Est. Lot # 6

Tax ID # \_\_\_\_\_ Quadrant # \_\_\_\_\_

Number of Bedrooms Proposed: 4 (28x64) Lot Size: 1.02 ac

Basement with Plumbing:  Garage:

Water Supply:  Well  Public  Community

Distance From Well: 50 ft.

Following is the minimum specifications for sewage disposal system on above captioned property. Subject to final approval.

Type of system:  Conventional  Other \_\_\_\_\_

Size of tank: Septic Tank: 1000 gallons Pump Tank: \_\_\_\_\_ gallons

Subsurface Drainage Field No. of ditches 1 exact length of each ditch 320 width of ditches 3 depth of ditches 18 1/2 in.

French Drain Required: \_\_\_\_\_ Linear feet

Date: 12-11-02

This permit is subject to revocation if site plans or intended use change.

Signed: Joe W. [Signature]  
Environmental Health Specialist

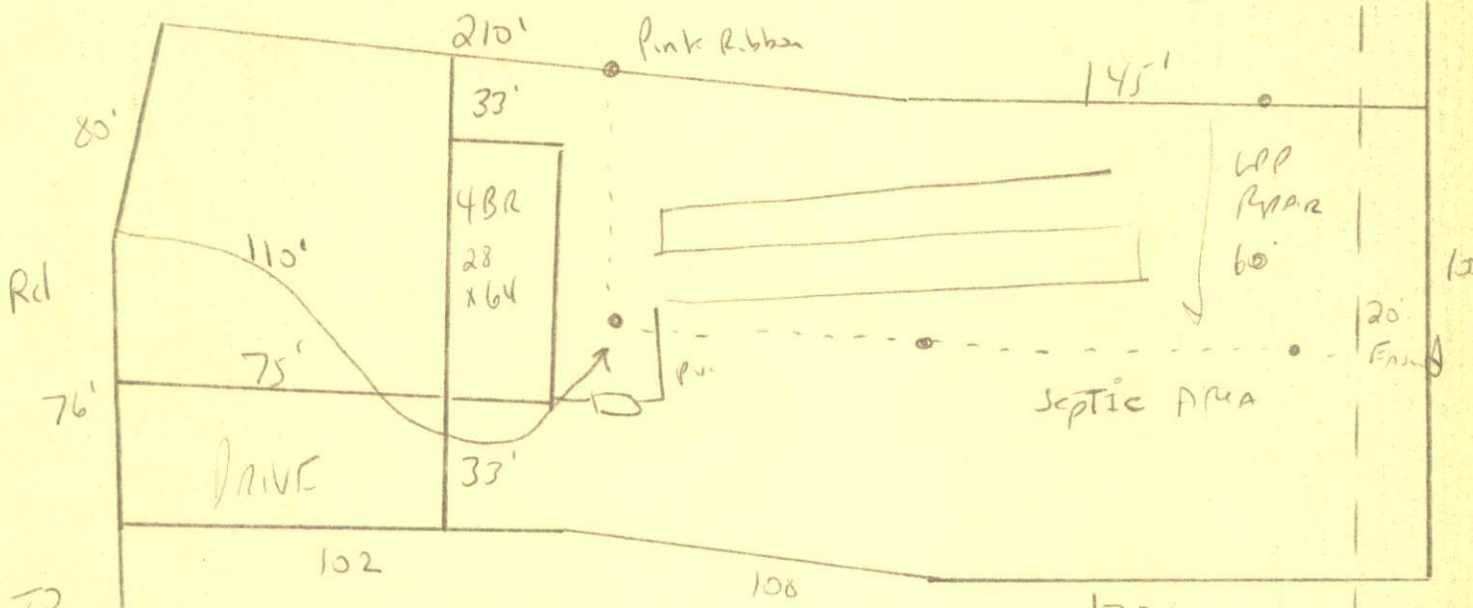

TO NC 27 ↓

Septic Area marked in Pink Ribbon - Area is 110' from Front Property Line & 60' wide  
Maintain All set Backs Do not Drive or park on septic system  
Meet onsite

HARNETT COUNTY HEALTH DEPARTMENT  
AUTHORIZATION TO CONSTRUCT

Authorization is hereby given to construct a wastewater system to the specifications described by Harnett County Health Department, Improvement Permit # 19924. This authorization shall be valid for a period not to exceed five (5) years from the date of issuance. This authorization will be invalid if ownership, site plans, or intended use change.

JAMES MARK CURRIN 893-4213  
Name Telephone #

NC27  
Address

LONGSTAR EST. 6 4 (28x64) 1.02 AC  
Property Location SR# Road Name  
Subdivision Lot # # Bedrooms Proposed Lot size

TYPE OF SYSTEM

New Installation  Repair  Septic Tank  Nitrification Lines  
 Conventional Other \_\_\_\_\_  Basement  With Plumbing  Without Plumbing

Water Supply:  Well  Public - Minimum Well Setback: 50 Ft.  
Septic Tank 1000 Pump Chamber \_\_\_\_\_

NITRIFICATION FIELD SPECIFICATIONS

Number of fields 1 # of lines per field 1 Length of lines 320 Ft.

Width of ditches 3 ft. Depth of ditches 18.24 inches

French Drain: Linear feet required \_\_\_\_\_ Depth of gravel \_\_\_\_\_

No wastewater system shall be covered or placed into use by any person until an inspection by the Harnett County Health Department has determined that the system has been installed according to the conditions of the Improvement Permit and that a valid Operations Permit has been issued.

[Signature] 12-11-02  
Signature of Authorized Agent for Harnett County Date