

HARNETT REGIONAL WATER
Equal Opportunity Provider and Employer

RESIDENTIAL WATER/SEWER USER AGREEMENT

COPY OF RECORDED DEED & PICTURE ID ARE REQUIRED

() _____ Water and Sewer District of Harnett County

() Retrofitted Sprinkler Connection

() Full Service Sprinkler Connection

Owner's Mailing/Billing Address:

Della Creech & Errol Creech

LAND OWNER'S NAME

525 East 9th st.

CURRENT STREET, ROUTE OR P.O. BOX

Charlotte, NC 28202

CITY OR TOWN, STATE, ZIP

910.304.9005

TELEPHONE NUMBER

2

NUMBER OF PERSONS LIVING IN

241-71-1954/35800316-Della Creech 240-75-5679/37031395-Errol Creech

OWNER SOCIAL SECURITY & DRIVERS LICENSE #

NA

SPOUSE'S SOCIAL SECURITY & DRIVERS LICENSE#

US Air Force Reserve 215 Hill Blvd. Charleston, SC 28404

EMPLOYER, ADDRESS AND PHONE NUMBER

NA

SPOUSE'S EMPLOYER, ADDRESS AND PHONE NUMBER

Gerald Creech 383 Red Hill Church Rd Dunn, NC 28334 910.658.3391

NAME OF NEAREST RELATIVE, ADDRESS AND PHONE NUMBER

For Office Use Only:

AMOUNT PAID

415848 / 212839

CUSTOMER NO.

PROPERTY NO.

STATE RD NAME & NO.

This Agreement, made and entered into this the 27th day of January, 2022, between Harnett Regional Water (HRW), as operator of the water supply and distribution system indicated above, (hereinafter "County") and Della Creech & Errol Creech (hereinafter "Owner").

WITNESSETH:

Harnett Regional Water, as operator of the water supply and distribution system indicated above, sells water to citizens and residents of Harnett County. HRW also treats wastewater for its citizens and residents where such treatment facilities are located within Harnett County. The Owner above named desires to purchase water and/or sewer treatment services from the County and further desires to enter into this Agreement with HRW to obtain these services described.

NOW THEREFORE, In consideration of the mutual promises herein set forth, it is agreed by HRW and Owner as follows:

1. The property which is the subject of this Agreement and to which water shall be supplied and/or sewer treatment services provided is described as follows:
2. Owner agrees to pay to HRW the amount of _____ per connection as a tap-on charge, said amount being due upon the execution of this Agreement by Owner.
3. HRW, pursuant to its Rules and Regulations, agrees to provide a water and/or sewer service connection on the above described property and to provide potable water and treatment of said wastewater to the Owner, provided that there is an existing water line capable of providing a connection on said property. **IN THE EVENT HRW DETERMINES THAT THERE IS NO EXISTING WATER AND/OR SEWER LINE CAPABLE OF PROVIDING A WATER SERVICE CONNECTION TO THE PROPERTY DESCRIBED ABOVE, ALL MONIES PAID PURSUANT TO THIS RESIDENTIAL WATER/SEWER USER AGREEMENT WILL BE REFUNDED TO OWNER.**
4. Owner agrees to pay to HRW a minimum amount of Twenty-five Dollars (\$25.00) as a water deposit (and \$25 as a sewer deposit, if water and sewer tap requested, \$50 total), provided they are approved by the On-line Utility Database procedure described in Section 20 (c) of the County Rules and Regulations. If not approved by the above-mentioned procedure, the owner agrees to pay a minimum of Fifty Dollars (\$50.00) as a water deposit (and \$50 as a sewer deposit, if water and sewer tap requested, \$100 total). This deposit may be returned without interest as provided by said Rules and Regulations. Said deposit shall be due upon the execution of this Agreement by Owner.
5. Owner grants HRW, its successors and assigns, a perpetual easement in, over, under, and upon the above described land with the right to erect, construct, install, lay and thereafter use, operate, inspect, repair, maintain, replace and remove water and/or sewer lines, meters, meter service facilities and appurtenant facilities thereon, together with the right of ingress and egress over adjacent land for the purposes mentioned above.
6. Owner shall install and maintain at Owner's own expense a 3/4 inch cut-off valve on the Owner's side of the HRW's water meter and a service line which shall begin at the meter and extend to the dwelling or place of use, and such other facilities as may be required by the Inspections Section of the Harnett County Planning and Inspections Department. The service line shall connect with the water system of the County at the nearest place of desired use by the Owner, provided HRW has determined in advance that the county water system is of sufficient capacity to permit the delivery of water at that point.
7. Owner agrees to comply with all requirements, rules and regulations applicable to water users adopted by the Division of Health Services of North Carolina Department of Human Resources. Owner further agrees that upon and after the date a plumbing connection is made between the Owner and HRW, Owners shall allow no cross connection to exist between HRW's system and any pipeline containing a contaminant or any pipeline connected to other present or future sources of water.
8. Owner agrees to pay for water and/or sewer service at such rates, time, and place as shall be determined by HRW and agrees to the penalties for non-compliance with the above, as set out in HRW's Rules and Regulations.
9. HRW shall install a water and/or sewer service connection for the Owner, and Owner shall then have thirty (30) days from the date of such installation to make the plumbing connection from the place of use on the above described property to the HRW's system. Charges for water and/or sewer shall commence on the date that the plumbing connection is completed, but in no event later than the end of the thirty (30) day period. That is to say, if the plumbing connection is not completed by the end of the

10/6/2021

VOLUNTARY SURVEY OF CUSTOMER DEMOGRAPHICS

The following information is requested by the Federal Government in order to monitor compliance with Federal laws prohibiting discrimination against applicants seeking to apply for water service. You are not required to furnish this information, but are encouraged to do so. This information will not be used in evaluating your application or discriminate against you in any way. However, if you choose not to furnish it, we are required to note the ethnicity, race, and gender of the individual applicants on the basis of visual observation or surname.

Gender: <input type="checkbox"/> Male (1) <input type="checkbox"/> Female (2)
Ethnicity: <input type="checkbox"/> Hispanic or Latino (0) <input type="checkbox"/> Not Hispanic or Latino (9)
Race: <input type="checkbox"/> American Indian/Alaskan Native (3) <input type="checkbox"/> Asian (4) <input type="checkbox"/> Black or African American (5) <input type="checkbox"/> Native Hawaiian or Other Pacific Islander (6) <input type="checkbox"/> White (7) <input type="checkbox"/> Other (8)
<input checked="" type="checkbox"/> I respectfully decline to provide this information.

REQUIREMENTS FOR CONNECTION
TO THE HARNETT REGIONAL WATER SYSTEM

1. You must first obtain a plumbing permit at the Harnett County Development Services Central Permitting Division (located at 420 McKinney Parkway in Lillington). The cost of this permit is \$40 for water and \$50 for sewer. If you are building a new house, this permit may be included in your building permits; check with Central Permitting (910-893-7525).

NOTE: If you live in another county and are connecting to the HRW's system, go to the inspection department for that county to obtain your permits and requirements.

2. Upon receiving your plumbing permit, and after the taps are installed, you may proceed with your work.

3. Contact a licensed plumber and arrange a time that your line can be installed. You may install your own service for your residence. If the new service is for a rental property, you are required to hire a licensed plumber. If you are hiring a plumber, you may want to obtain several estimates for your job. It is not permissible for a friend or neighbor to connect your service. It must be the property owner or a licensed plumber.

4. Before you or your plumber begin digging, especially in State right-of-ways, you should contact North Carolina One-Call Center at 811 and have the area marked for under-ground power, cable, or phone lines. You will need to contact NC One-Call 48 hours prior to beginning the work in order to allow adequate time for notification to all pertinent utilities. You should advise the operator of the date and time you will be performing the work and a detailed location of the service. They will contact all the necessary utilities in that area.

5. You are required to install a minimum of a 3/4" water line from the building to the water tap and a 3/4" cut-off valve on your side of the water tap. The cut off valve installed on the customer side of the tap must be in a separate box. It is not permissible to install the customer cut-off valve inside the meter box. This will benefit you should you need to turn your water off for repairs or leaks. Excessive water could be lost while waiting for a meter technician if this valve is not installed. For standard connections, 3/4" pipe should be used from the meter to the residence/building being connected, with a minimum pressure rating of 160 psi. We recommend that you also install a pressure reducing valve at your service to control the amount of pressure feeding into your line and prevent excessive pressures. This reducer is especially important on residences with older plumbing. The Inspections Department also requires a cut-off valve at the house or building.

6. After the customer cut-off valve has been installed within 12" of the water tap and attached to the setter, contact our office at 910-893-7575 to order the installation of your meter at least **48 business hours prior** to when you actually need the meter set. **Be sure that the cut-off valve has been installed on your side of the meter box before calling for your meter. This cut off valve must be within 12 inches of the meter box in a box of it's own. Second call outs for meters will be charged a service fee. (This cut off valve is required by ALL customers in all counties.)**

APPLICATION DIRECTIONS

DATE: 01-27-22

Della Creech & Errol Creech is requesting a water and/or sewer service at the location as noted below. This request is for a _____ inch water service and/or a residential sewer service. The cost of the service will be as follows:

Water tap total cost + deposit:

3/4" \$2800
1" \$3500
2" \$4500

Residential Sewer tap total cost + deposit:

ALL DISTRICTS \$3500
BUNNLEVEL & RIVERSIDE \$4500

Retrofitted sprinkler tap fee: \$300 + \$325 3/4" meter & mxu fee = total cost \$625

*There will also be a deposit on all new accounts for water and/or sewer as required.

For all other sizes refer to Harnett Regional Water @ (910) 893-7575.

Should a line extension be required to install this service, the customer would be required to pay the amount of \$_____ before the installation of the requested service. This amount is based on materials and labor as required to extend the line to the customer's property.

DIRECTIONS TO LOCATION OF REQUESTED TAP: Detailed Map/Description

54 Wilson Lucas
Dunn, NC 28334

CUSTOMERS SIGNATURE DJC Errol Creech

Office Use:
This service can be installed as noted above. _____
This service requires a line extension: cost above. _____
Date of returned notification from Maintenance. _____
Maintenance Personnel Signature: _____

thirty (30) day period, user charges shall commence and Owner shall be obligated to pay the minimum user bill from and after the end of such period, regardless of whether water and/or sewer service is being provided to Owner.

9A. THIS PARAGRAPH APPLIES ONLY TO AGREEMENTS FOR RETROFITTED SPRINKLER CONNECTIONS.

No monthly minimum charge will be made to Owner except during those months when the connection has been used. The Bill rendered will be for gallons used, but in no event less than the applicable minimum bill. A separate bill will be provided for the connection and the same schedule of rates applicable in the service District shall apply to it. No sewer charges will be made to Owner for water used through the connection. The Retrofitted Sprinkler Connection shall not be connected to any plumbing or other pipeline where residential water there from is required to be discharged into the public sewer system.

10. Owner agrees to abide by the Rules and Regulations of HRW as from time to time promulgated by the Harnett County Board of Commissioners, and further agrees to abide by such other HRW ordinances, rules and regulations with respect to water and/or sewer service connections, as are adopted by the Harnett County Board of Commissioners. Additionally, Owner agrees to obtain the necessary inspections and permits related to water and/or sewer service connections as required by the Building Inspections Division of the Harnett County Development Services.

11. HRW shall purchase and install a cutoff valve and water meter for each service. HRW shall own said meter and shall have the exclusive right to use it.

12. Owner agrees that there shall be one water and/or sewer connection for each building or structure requiring connections on the above described property. A tap-on charge shall be due for each such connection.

13. HRW shall have final jurisdiction on any question of location of any service line connection to its distribution system; shall determine the allocation of water to Owner in the event of a water shortage and may shut off water to Owner if Owner allows a connection or extension to be made to Owner's service for the purpose of supplying water and/or sewer service to another user.

14. In the event User transfers title or agrees to transfer title to the above described property, before or after such connection, User agrees that this agreement shall run with the property title thereto and agrees to advise the new owner with respect hereto and furnish new owner a copy thereof.

15. After HRW has executed this Agreement, a copy shall be provided to Owner by person delivery or by mailing to the Owner's address as indicated above.

Signed by Owner this 27th day of January, 2022.

Erud Creech
Owner

Della Creech
Owner

John Kowalczyk
Witness

Signed by County this 27 day of January, 2022.

HARNETT REGIONAL WATER

BY: [Signature]
Steve Ward, Director

WHEN RETURNING THIS AGREEMENT BY MAIL PLEASE SENT TO:

Harnett Regional Water
Post Office Box 1119
Lillington, NC 27546

NORTH CAROLINA ^{USA} DRIVER LICENSE

Tommy
COMMISSIONER OF MOTOR VEHICLES



4d DLN **000035800316**
DUP

3g DOB **01/10/1990**
4b EXP **01/10/2024**

1 **CREECH**
2 **DELLA SHIREE LOVE**
8 **525 E 9TH ST**
CHARLOTTE, NC 28202-3123

9 CLASS **C** 9a END **NONE**
12 RESTR **NONE**
15 SEX **F** 18 EYES **DIC**
16 HGT **5'-04"** 19 HAIR **BLN** RACE

Della S. Creech

4a ISS **06/09/2020**
5 DD **0027621738**

01/10/90 **VETERAN**

NORTH CAROLINA

DEPARTMENT OF MOTOR VEHICLES



Errol Creech

DRIVER LICENSE
NOT FOR FEDERAL IDENTIFICATION

1 CREECH
2 ERROL DEVRON

3 DOB 04/12/1992
4 EXP 04/12/2026
8 1700 ALEXANDER
APT 15
WAKE FOREST, NC 27587-3991

9 CLASS C
12 RESTR NONE
15 SEX M
16 HGT 5'-05"
18 EYES HAZ
19 HAIR BRO
20 RACE
4a ISS 05/10/2018
5 DD 0021842026

04/12/1992

Harnett County – Utilities Access Program Application
 For questions concerning the application or program, call 910-893-7536.

Approved
 11/21/22
 [Signature] 27 Jan 2022

PLEASE PRINT CLEARLY

Applicant's Name: Della Creech
 Physical Address/Location of Home: 54 Kluders Lucas rd Dunn, NC 28334
 Mailing Address: 180 Edna John ct. Dunn, NC 28334
 Telephone Number: Home: _____ Cell: 910 324 9005
 Driver License Number/State: 358003116
 Please provide a copy of Driver License

Is applicant's name the same as the homeowner's name? YES NO

If NO, name of homeowner: _____

Does the applicant share ownership of the above property? YES NO

Proof of ownership is required. (Ex. Deed of Trust)

Is applicant a single-parent? YES NO

Total gross (before taxes) household income per month: _____
 (Include income of all adult members of the household, and provide documentation. Examples:
 Pay Stubs, Social Security Letters, Bank Statements, or W-4 Statements from previous year.)

List All People Living in the Home: (including applicant)		*If YES, describe below		
		Criminal History (Yes/No)	Disable (Yes/No)	Head of Household (Yes/No)
Name	Age			
1. Della Creech	31	No	No	Yes
2. _____ NA _____				
3. _____ NA _____				
4. _____ NA _____				
5. _____ NA _____				
6. _____ NA _____				

If Yes:

Describe Criminal History:

N/A

Describe disability:

N/A

Homeowner's Signature & Date:

Della J Creech

Return completed form to: (Incomplete forms will not be processed.)

Mailing: Harnett County General Services

Attn: Anna Peele

P.O. Box 940

Lillington, NC 27546

Hand Delivery: Harnett County Facilities and Services

Attn: Anna Peele

200 Alexander Drive

Lillington, NC 27546

Phone: 910-893-7536

Fax: 910-814-8263

Email: apeele@harnett.org

Creech - 54 Wilson Lucas Rd

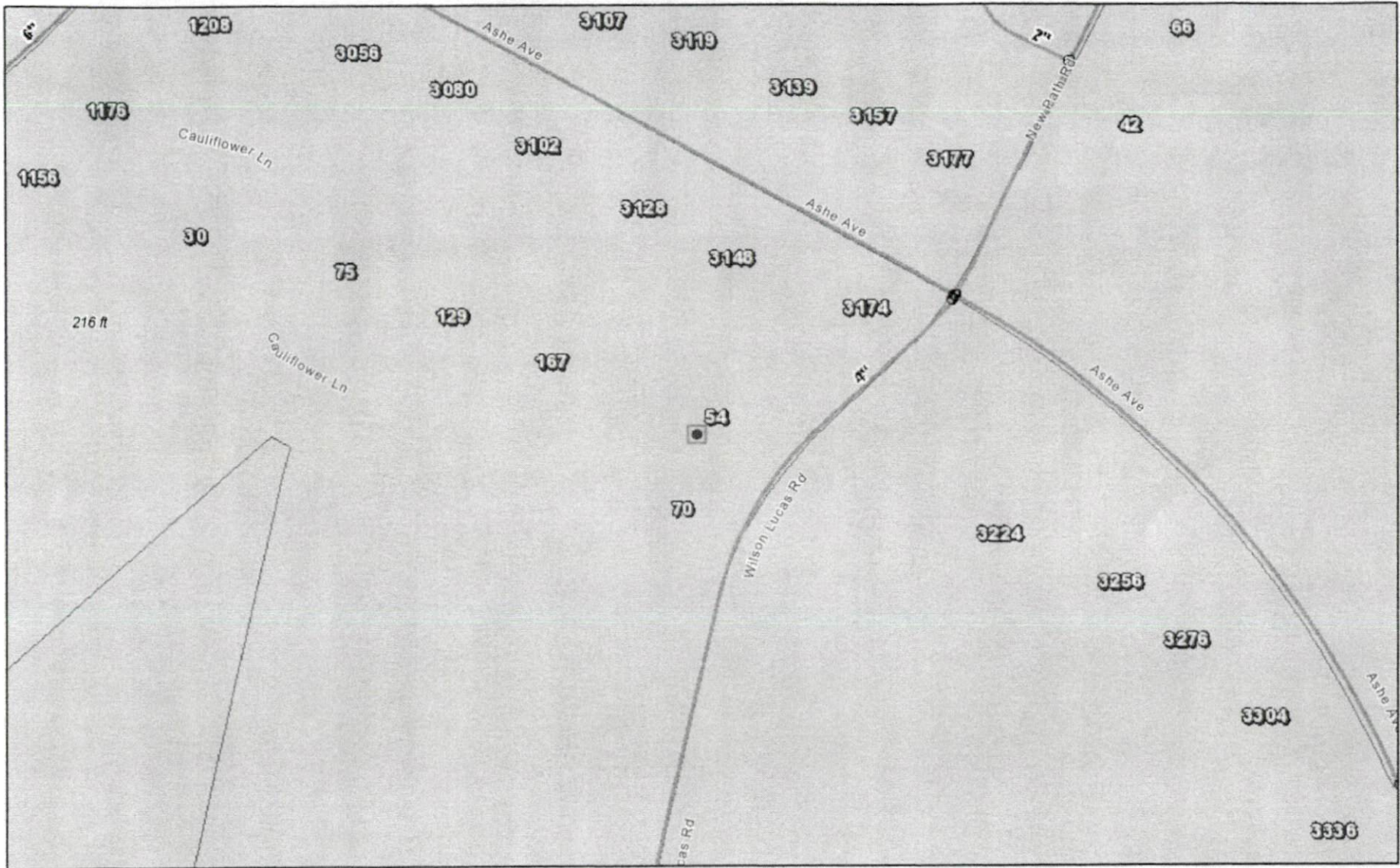

January 25, 2022

- | | | | | | |
|-------------------------|-------------|------------|-------------|----------------------|-----|
| Harnett County Boundary | WTR_Booster | WTR_PRIV | WTR_ARV | WTR_LocateConnection | cap |
| Address Numbers | WTR_Tank | Hydrants | WTR_Meter | WTR_Fittings | |
| WTR_NetworkStructure | WTR_MASTER | WTR_Valves | WTR_BlowOff | bend | |

1:2,257

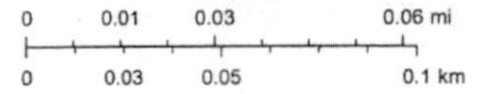

NORTH CAROLINA

DRIVER LICENSE

COMMISSIONER OF MOTOR VEHICLES



4d DLN: 000035800316
DUP

3i DOB 01/10/1990
4b EXP 01/10/2024

1 CREECH
2 DELLA SHIREE LOVE
8 525 E 9TH ST
CHARLOTTE, NC 28202-3123

9 CLASS C 9a END NONE
12 RESTR NONE

15 SEX F 18 EYES DIC
16 HGT 5'-04" 19 HAIR BLN RACE

Della S. Creech

4a ISS 06/09/2020
5 ID 0027621738

01/10/90 VETERAN